

Axis.

fixed height benching system



WORKSPACE 

AXIS STRAIGHTLINE



Axis Straightline with Ignite Screens, Axis BBF, transom mount shelves.

STANDARD FEATURES

- 2.0" x 2.0" end frames with flush ground weld finish
- 2.0" x 1.0" rails
- Levelling glides with 3.0" height adjustment
- Stock laminates are shown below. Other finish options are available with extended lead times
- Silver powdercoat and Arctic White powdercoat to all steel components
- Overall height - 28.75"



Straightline Desk



Straightline Two Sided



Straightline Single Sided Double



Straightline Two Sided Double



Straightline Single Sided Triple

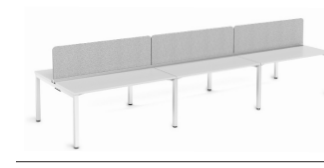

Straightline Two Sided Triple

STANDARD WORKTOP SIZES STRAIGHTLINE

48" w x 24" d	60" w x 30" d
48" w x 30" d	72" w x 24" d
60" w x 24" d	72" w x 30" d

UNIT DIMENSIONS

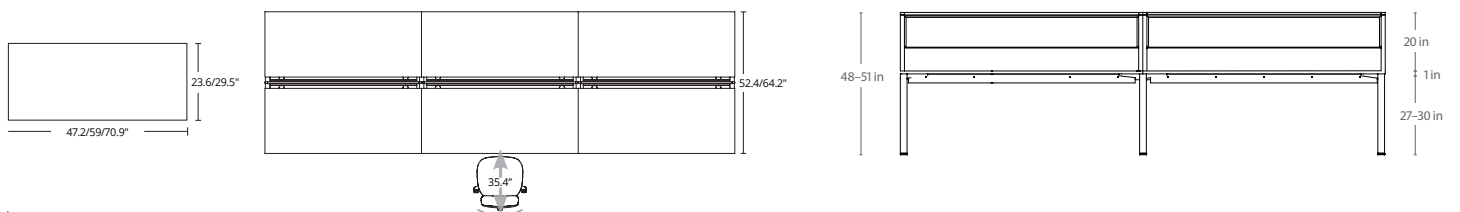

AXIS 90°



Axis Desking with Ignite Screens, Balance Seating, Axis Mobiles and Shelves

STANDARD FEATURES

- 2.0" x 2.0" end frames with flush ground weld finish
- 2.0" x 1.0" rails
- Levelling glides with 3.0" height adjustment
- Laminate shown available on a 48 hour lead time*. Other finishes have a 3-4 week lead time.
- Silver powdercoat and Arctic White powdercoat to all steel components
- Overall height - 28.75"

STANDARD WORKTOP SIZES 90° DEGREE

72" x 72"w x 24"d

72" x 72"w x 30"d



90 Degree Workstation



90 Degree Two Pod



90 Degree Four Pod

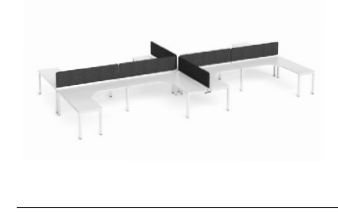

90 Degree Eight Cluster

*Extended lead times on 90° worksurfaces

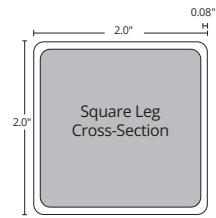
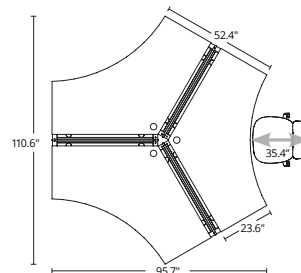
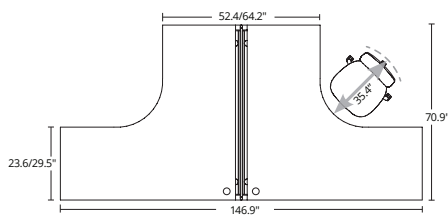
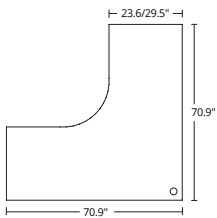



STANDARD FEATURES

- 2.0" x 2.0" end frames with flush ground weld finish
- 2.0" x 1.0" rails
- Levelling glides with 3.0" height adjustment
- Stock laminates are shown below. Other finish options are available with extended lead times
- Silver powdercoat and Arctic White powdercoat to all steel components
- Overall height - 28.75"

STANDARD WORKTOP SIZES 120° DEGREE

48" x 48" w x 24" d



120 Degree Workstation



120 Degree 2/3



120 Degree Three Cluster



120 Degree Six Cluster

Axis Finishes

Laminate



Frame Color

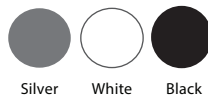

Screen Color Ripple Collection

