

Versi Assembly Guide

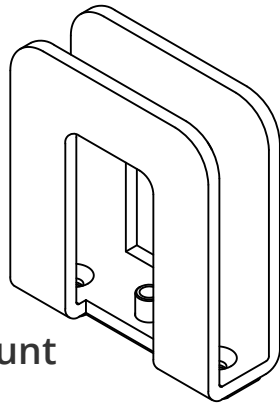

Surface Mount

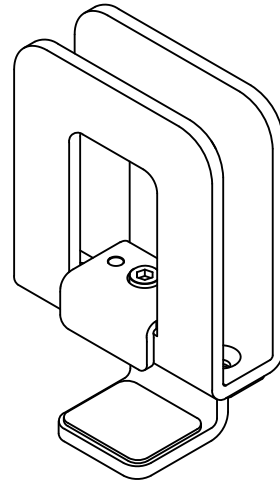

Surface Mount
with Clamp

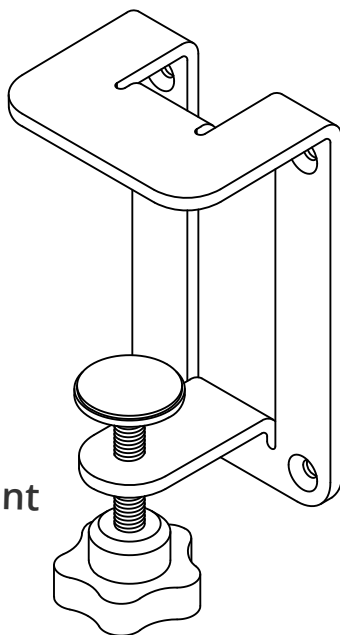

Clamp Mount
with Extra
Depth

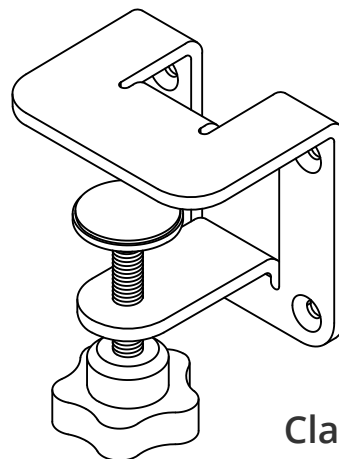

Clamp Mount

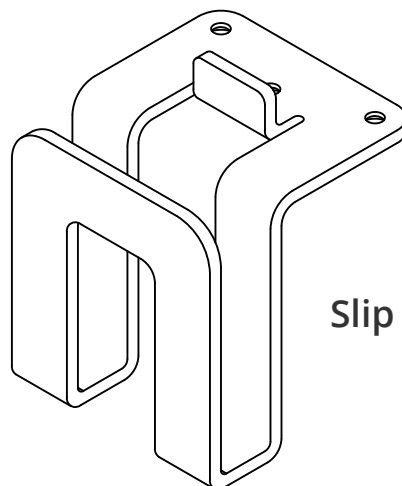

Slip Mount

Surface Mount
Components 4
Installation 5-6
Acrylic Sleeve7

Surface Mount with Clamp
Components 9
Installation 11-12
Acrylic Sleeve13

Clamp Mount
Components 15
Installation 16-17

Clamp Mount with Extra Depth
Components 19
Installation 20-21

Slip Mount
Components 23
Installation 24-25

Surface Mount Bracket

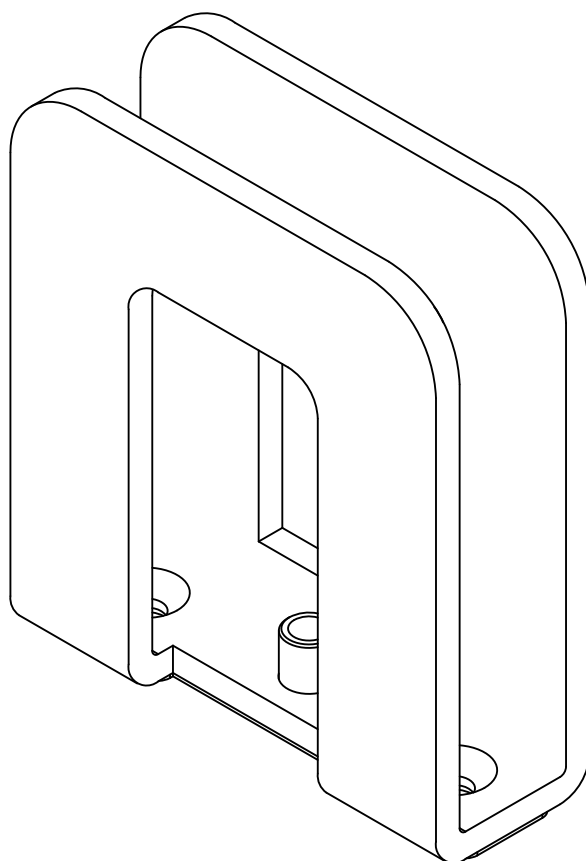

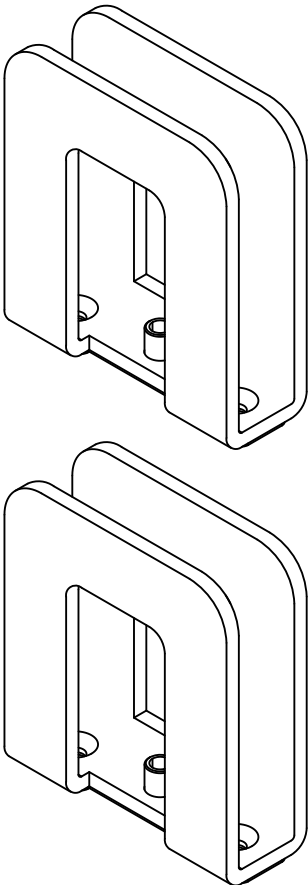

Surface Mount Bracket

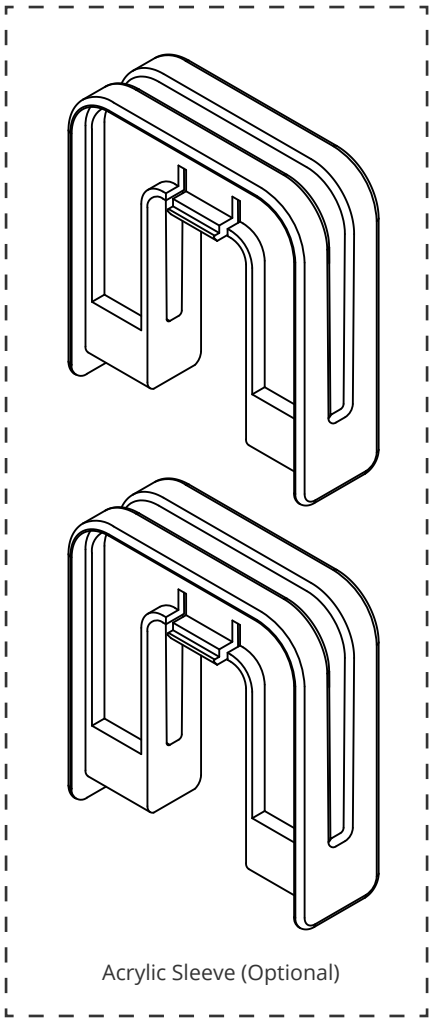

Acrylic Sleeve (Optional)

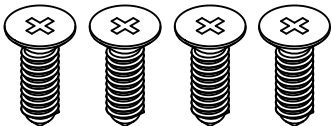

Tapping Screw

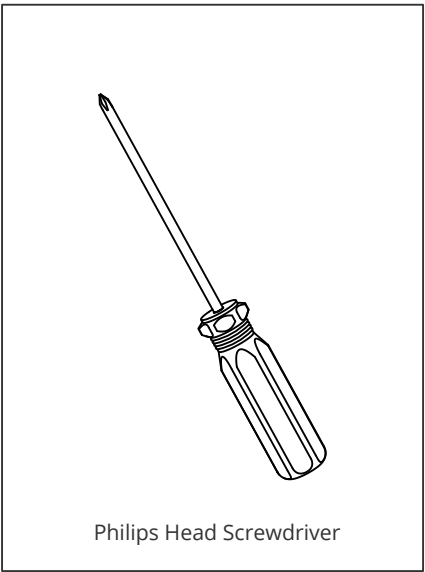

Philips Head Screwdriver

Step 1: Position bracket 25% from each end and to edge of worksurface.

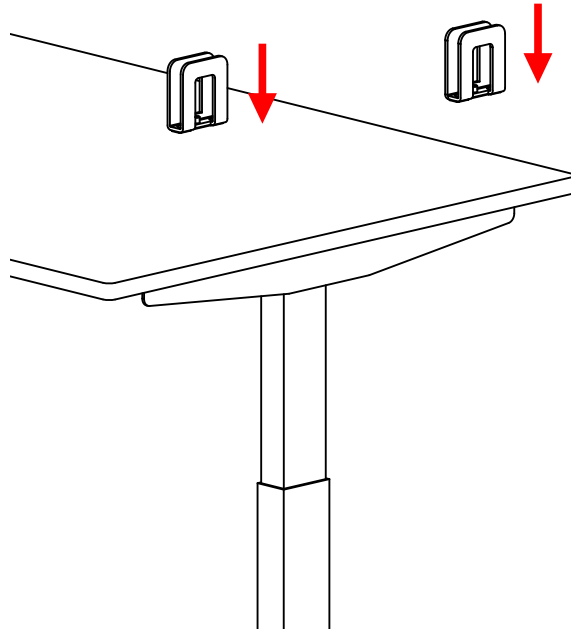

Step 2: Fasten bracket to worksurface with Tapping Screw using screwdriver.

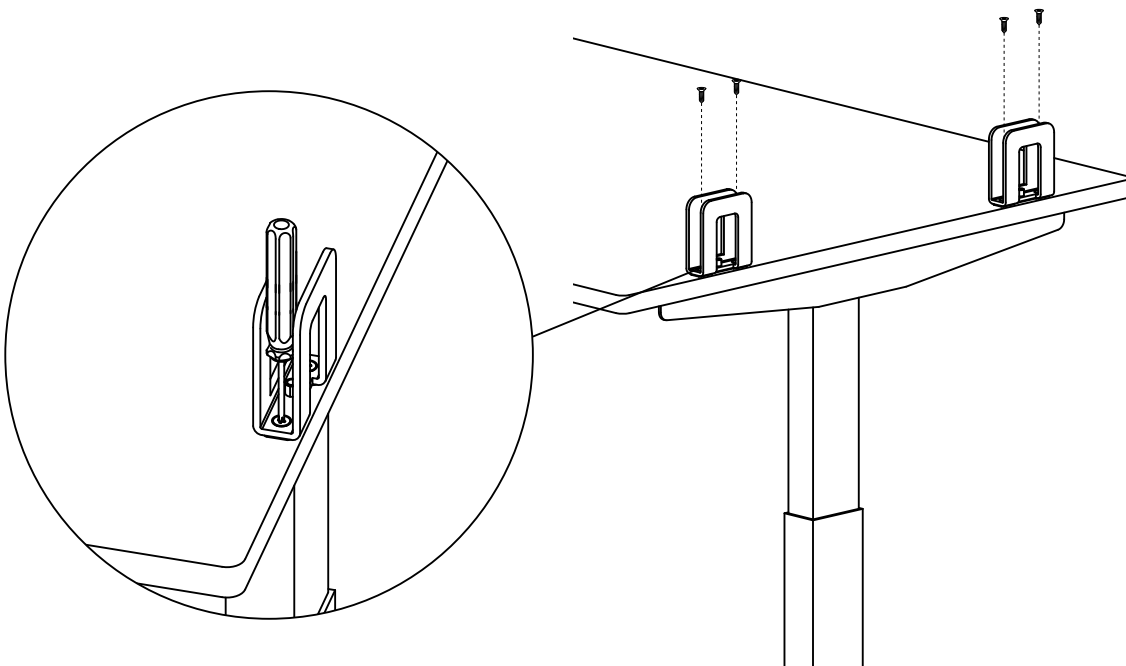

Step 3: Slip in 18mm PET privacy screen

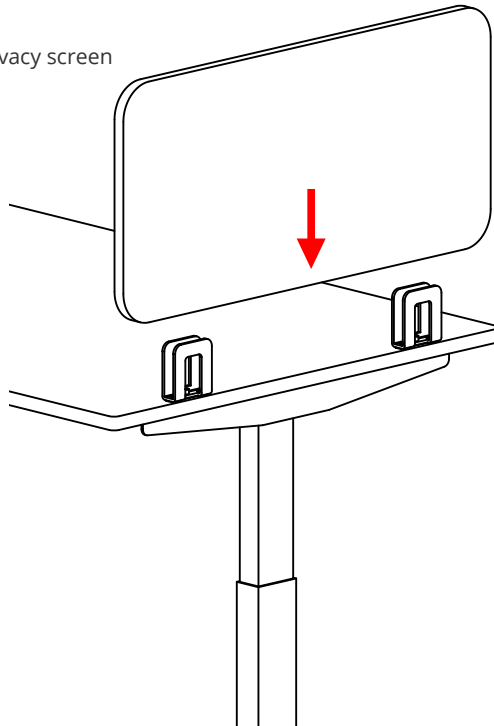

Step 4: Complete

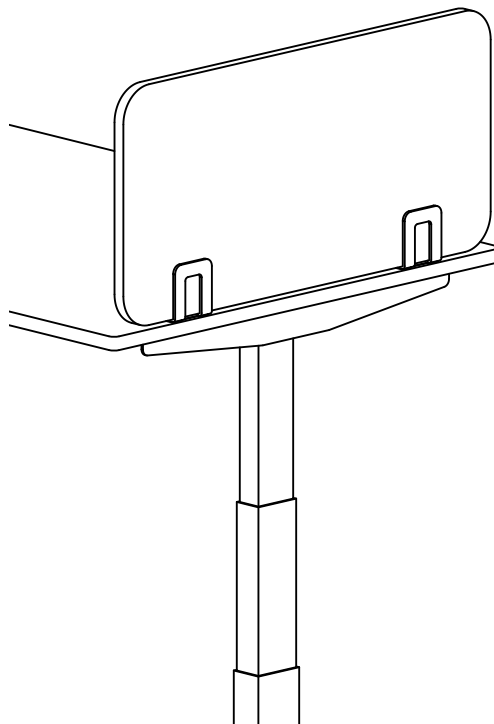

Step 5: Slip in Acrylic Sleeve until a "click" is felt.

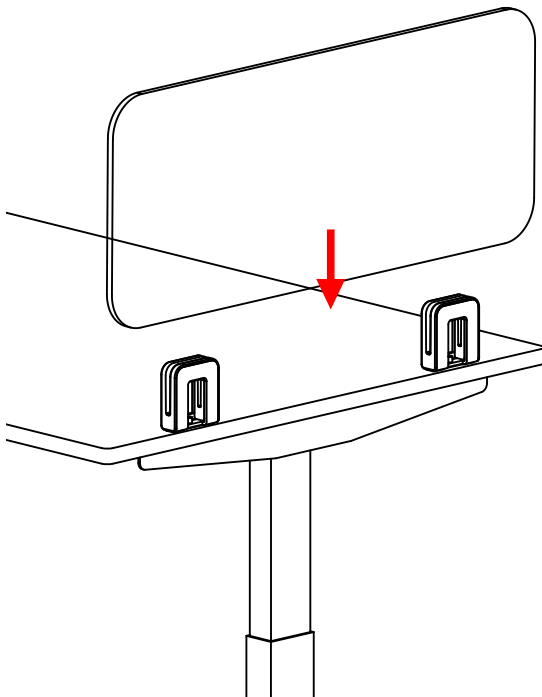
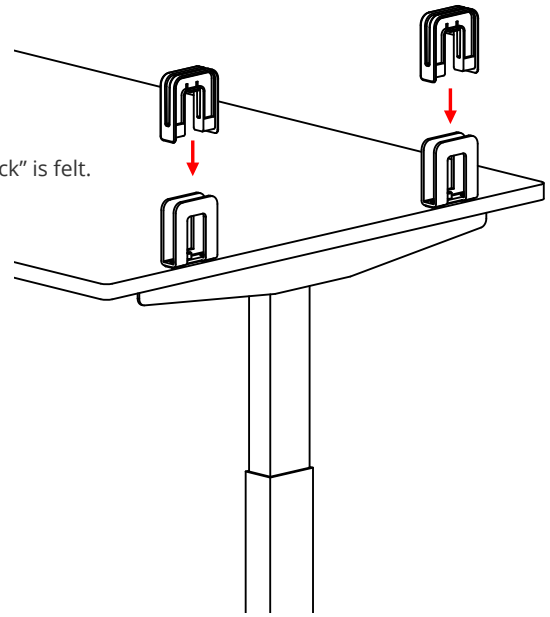

Step 6: Slip in acrylic screen

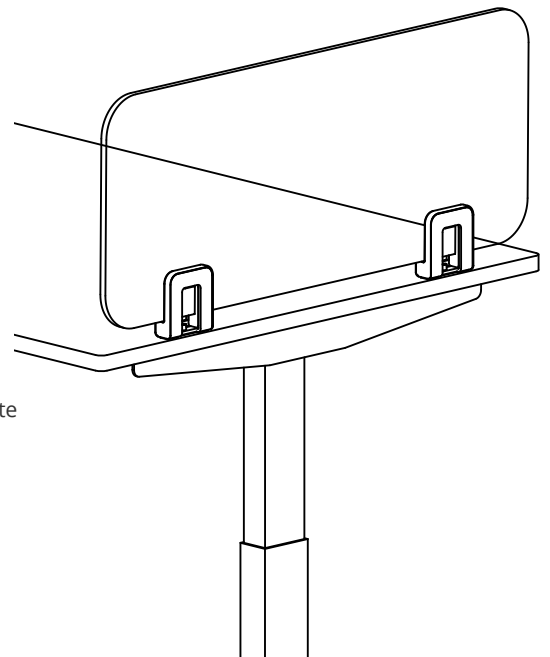

Step 7: Complete

Surface Mount Bracket With Clamp

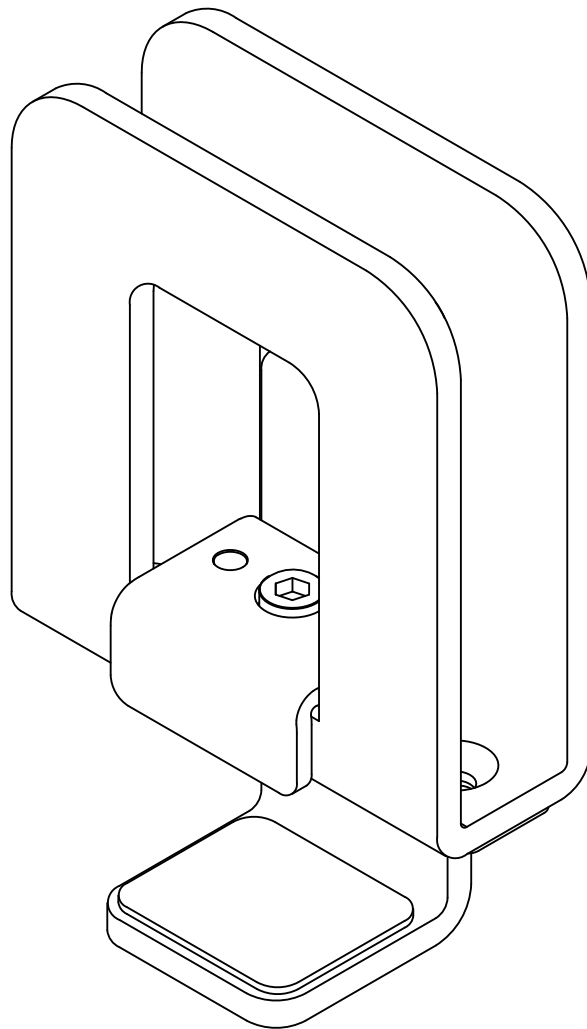

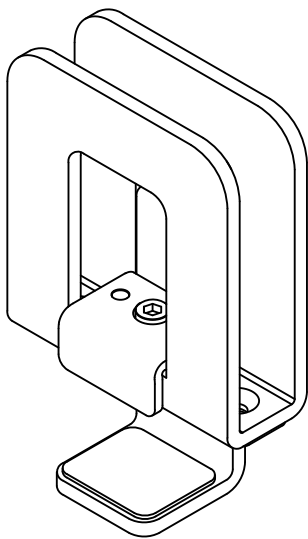
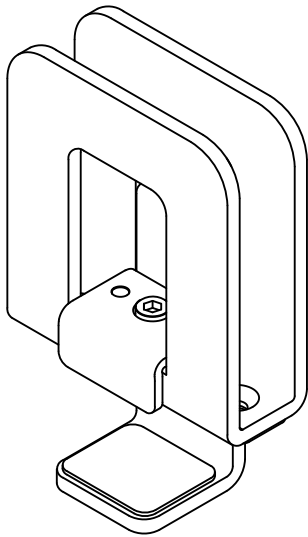

Surface Mount Bracket
with Clamp

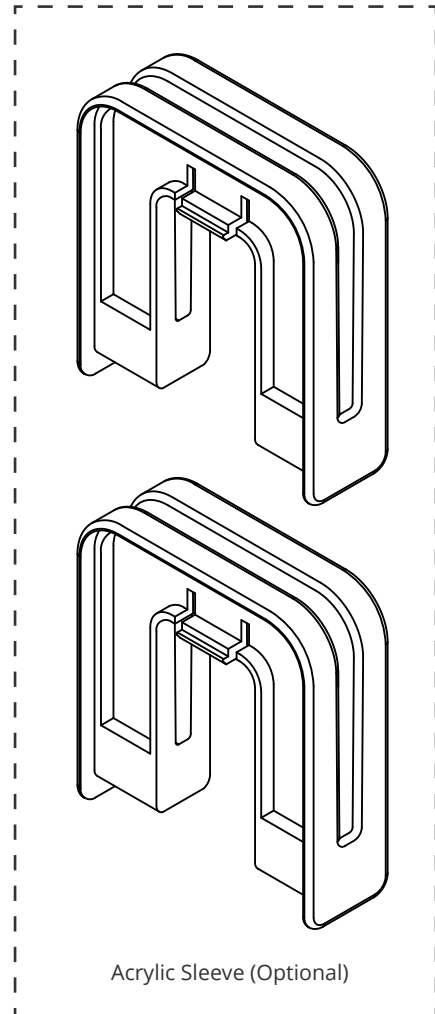

Acrylic Sleeve (Optional)

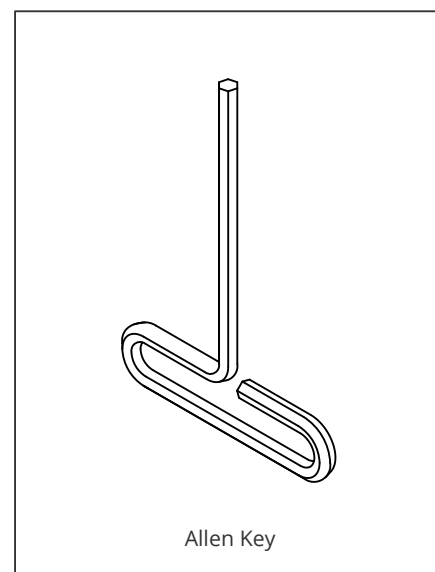

Allen Key

Step 1: Position bracket 25% from each end and to edge of worksurface.

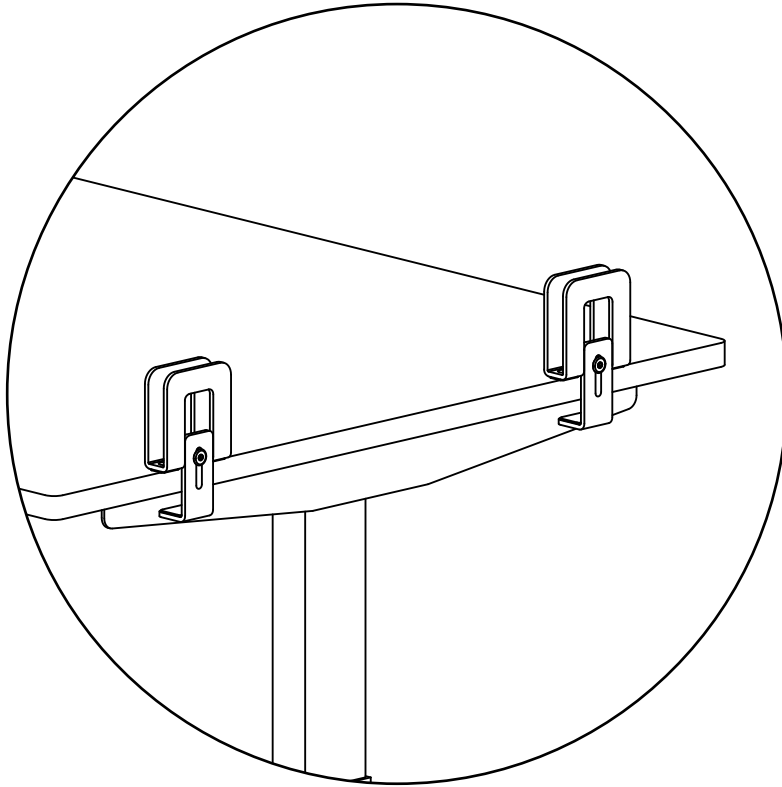

Step 2: Push the clamp up to fit the thickness of the worksurface.

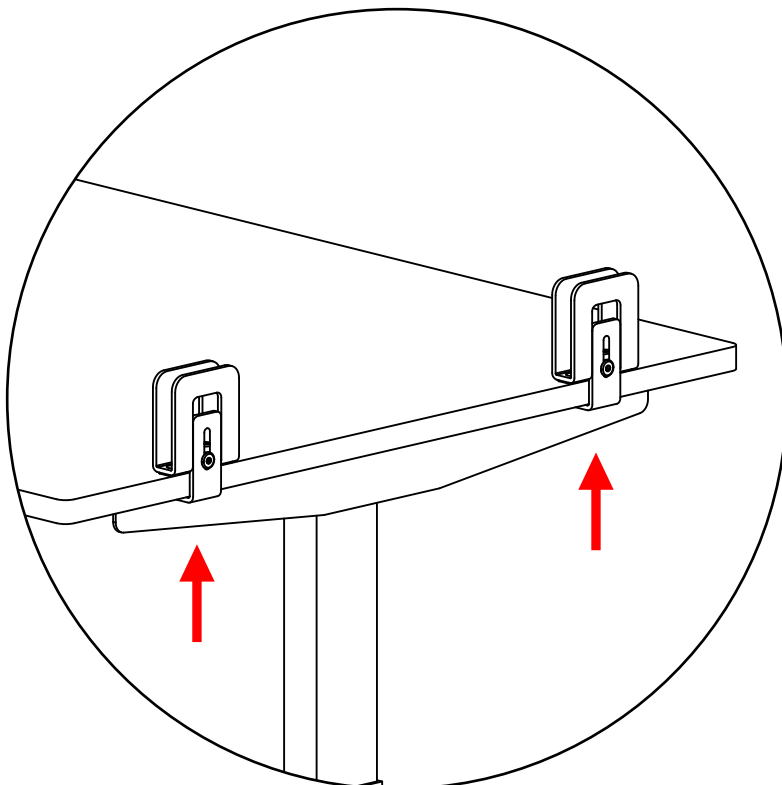

Step 3: Tighten the side screw by turning the Allen key clockwise.

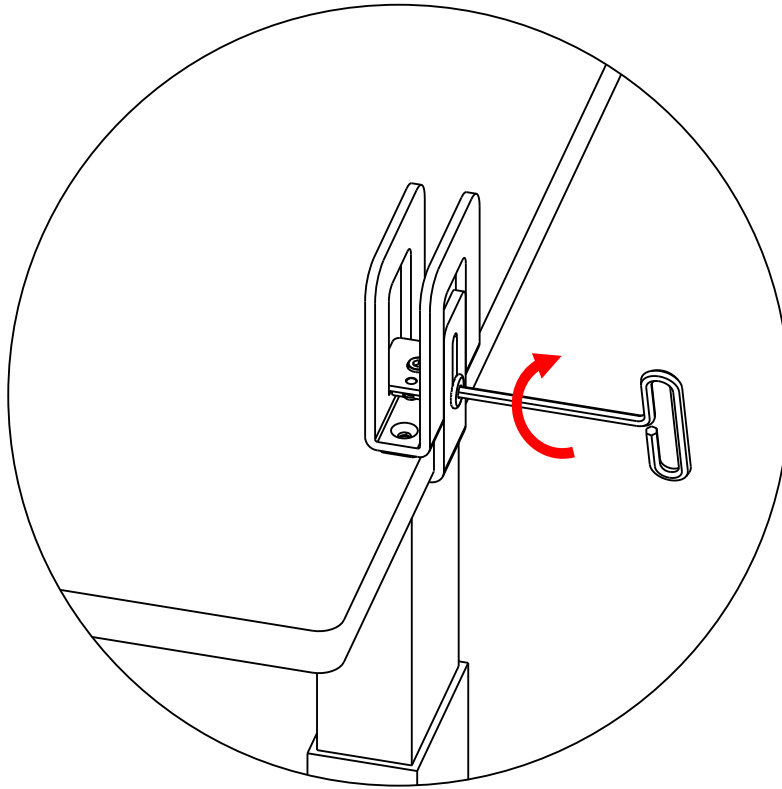

Step 4: Tighten the inner screw by turning the Allen key **counterclockwise**.

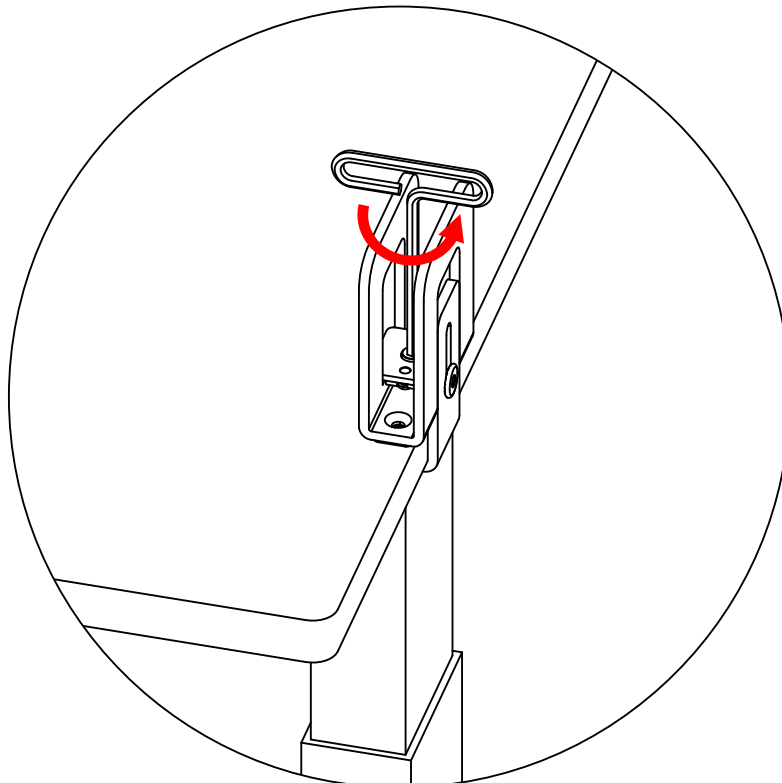

Step 5: Slip in 18mm PET privacy screen

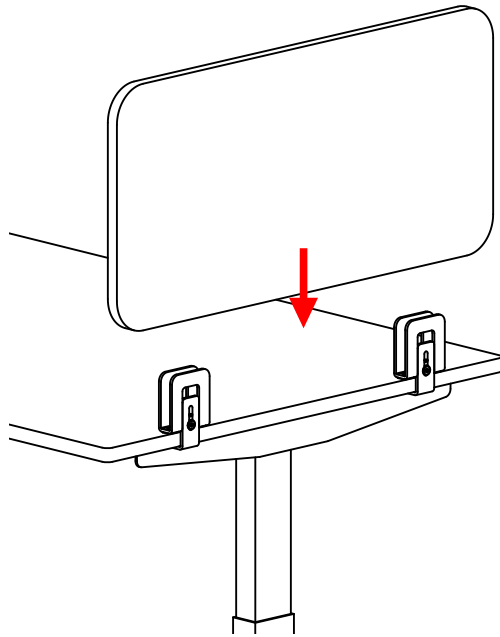

Step 6: Complete

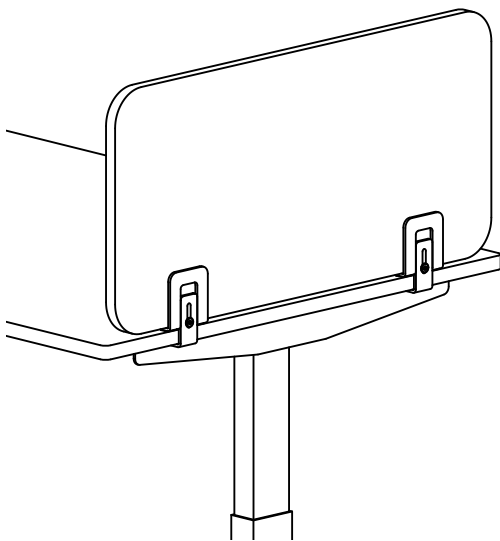

Step 7: Slip in Acrylic Sleeve until a "click" is felt.

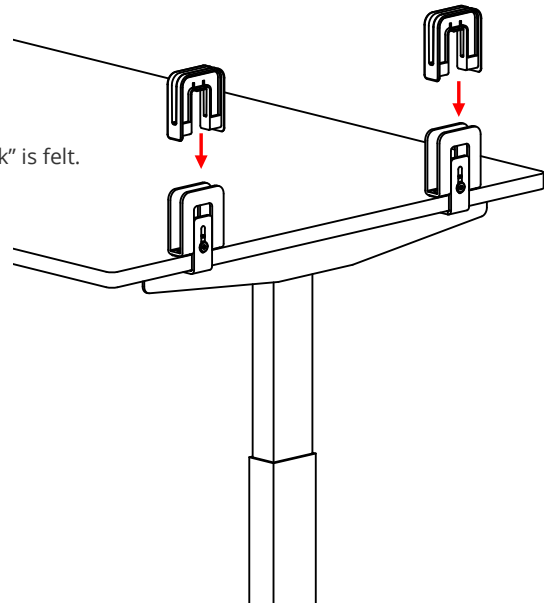

Step 8: Slip in Acrylic panel

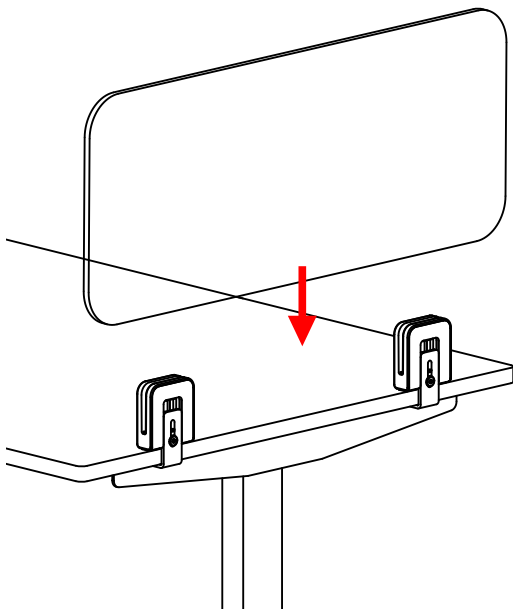

Step 9: Complete

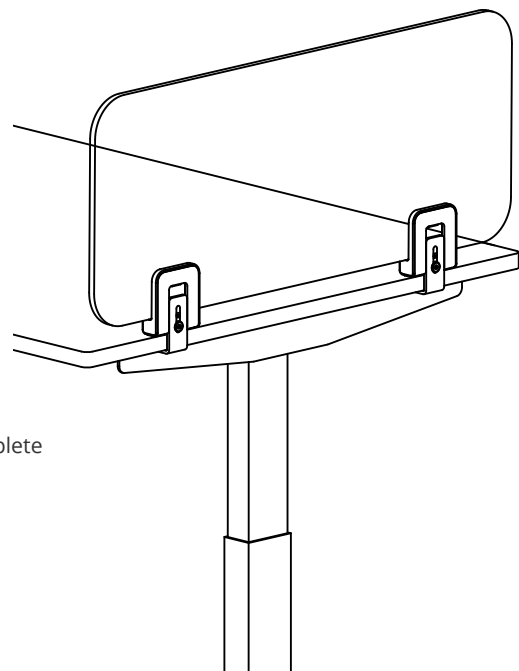

Clamp Mount Bracket

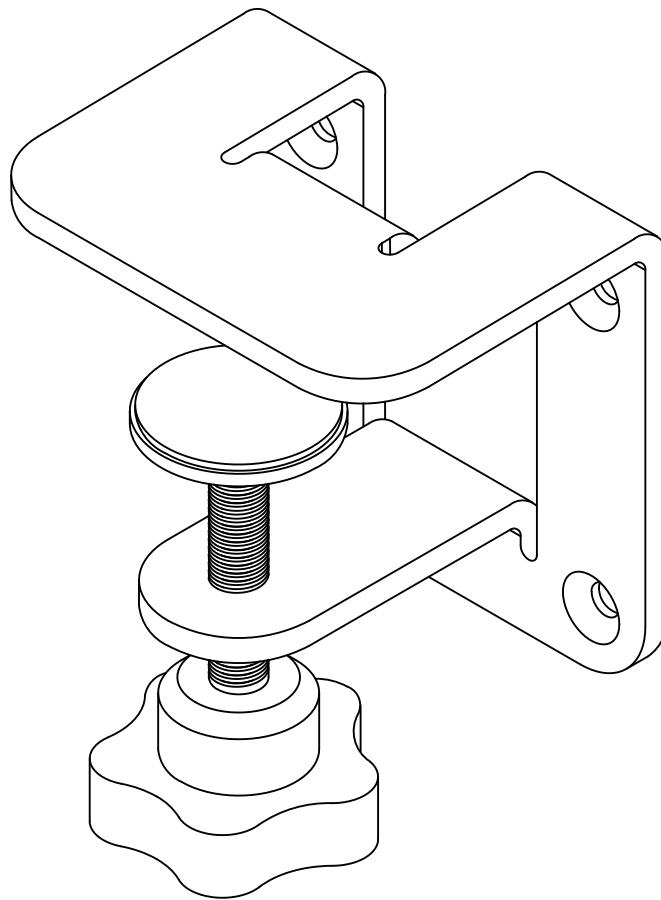

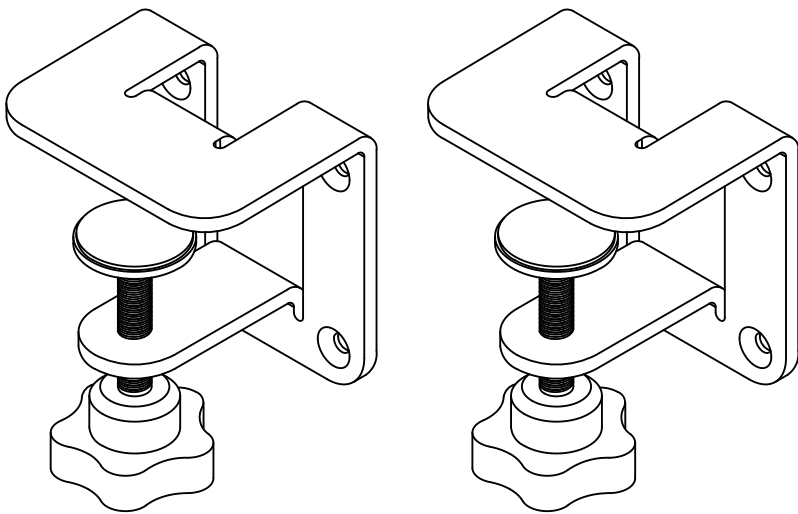

Clamp Mount Bracket

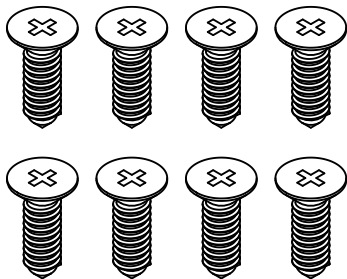

Tapping Screw

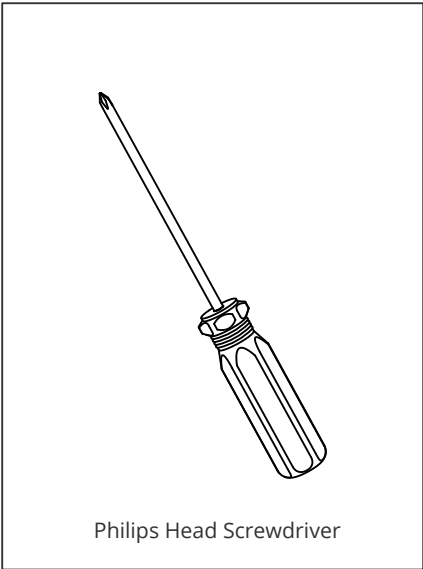

Philips Head Screwdriver

Step 1: Position bracket 25% from each side of the PET privacy screen, as shown.

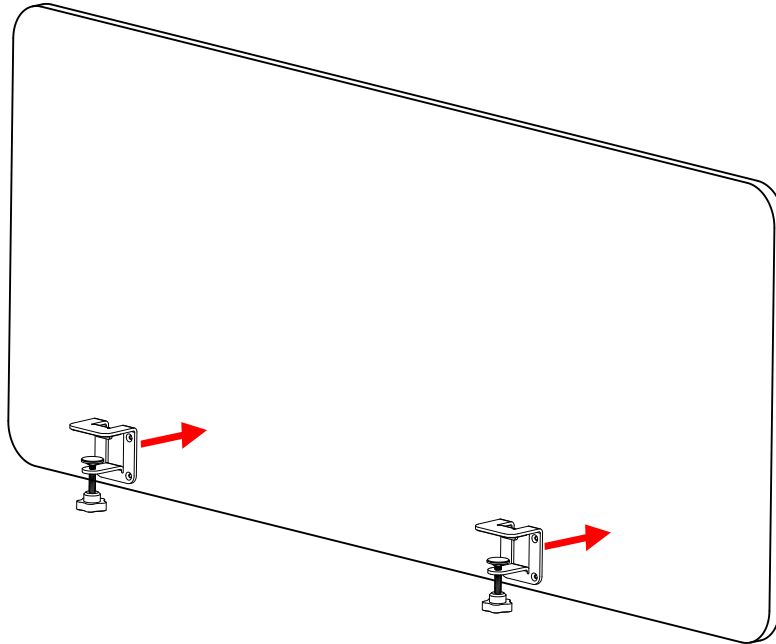

Placement Suggestion: 11" and 18": Align brackets at the bottom of screen.
23": Top of screen to be 11" above surface, 9" below surface
28": Top of screen to be 18" above surface, 9" below surface

Step 2: Fasten bracket to PET privacy screen with tapping screw using screwdriver.

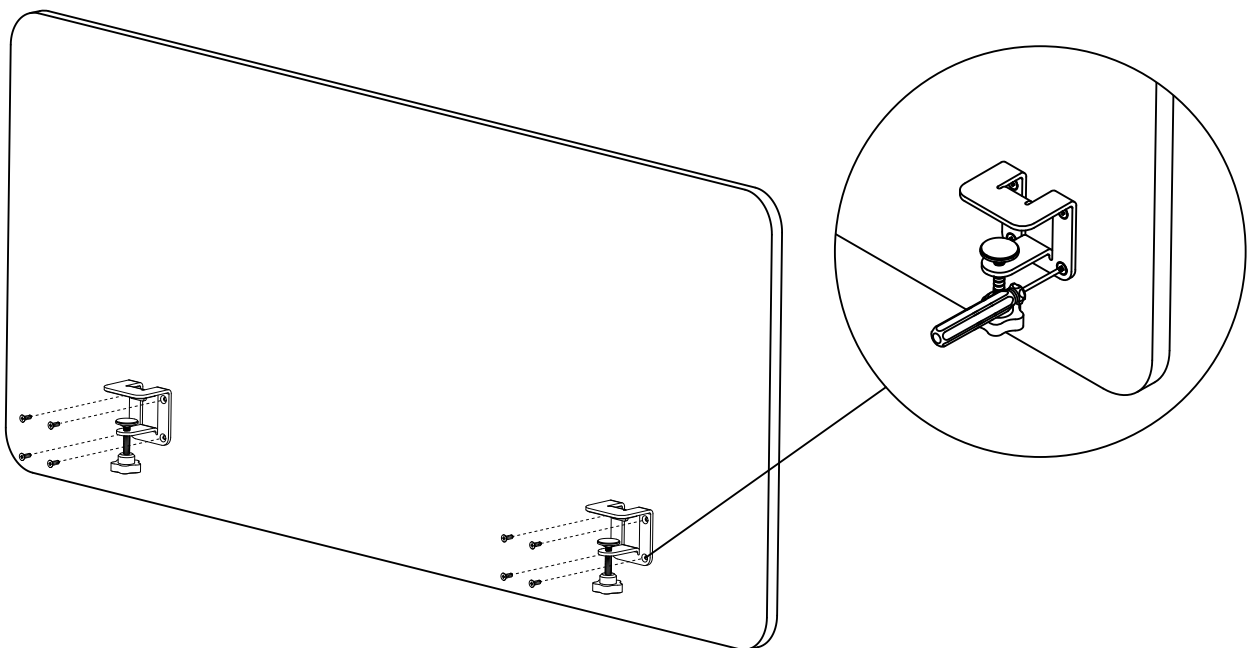

Step 3: Position bracket sub-assembly to edge of worksurface. Turn the knob to fasten bracket to worksurface

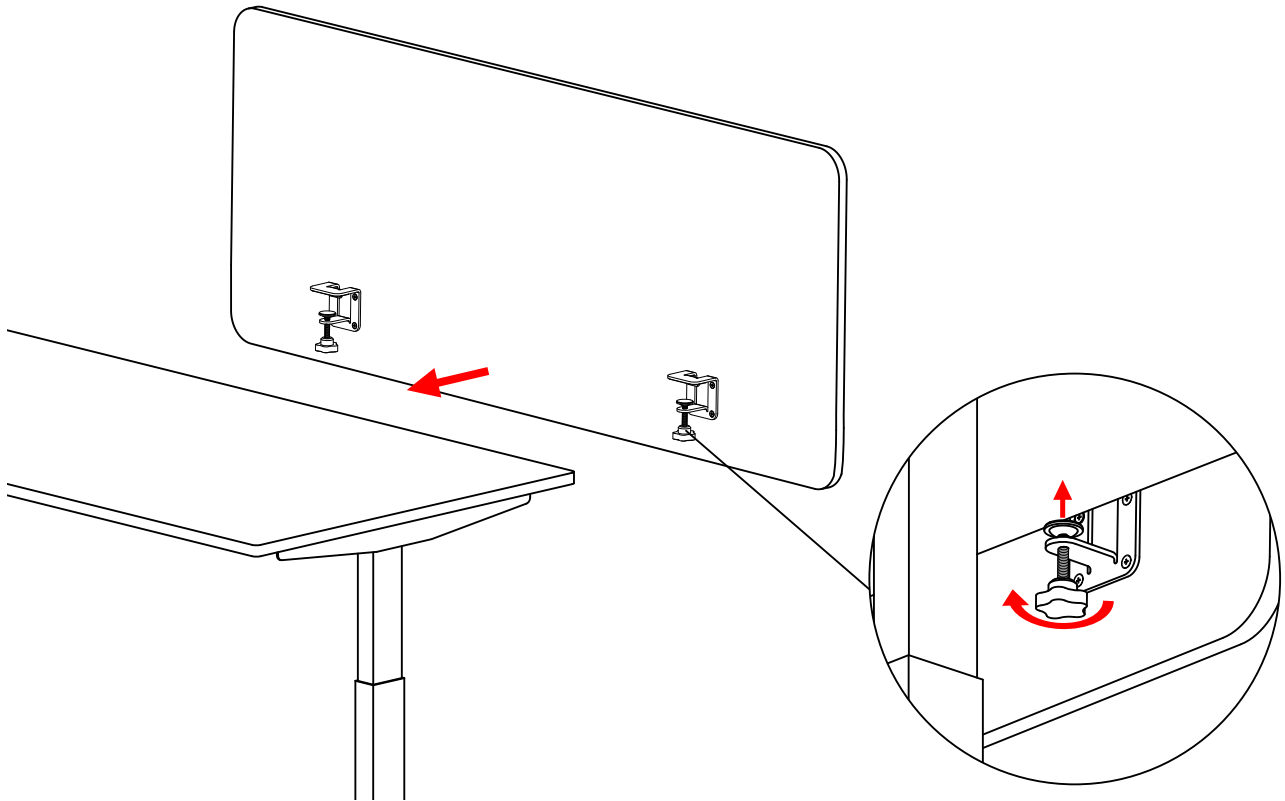

Step 4: Complete

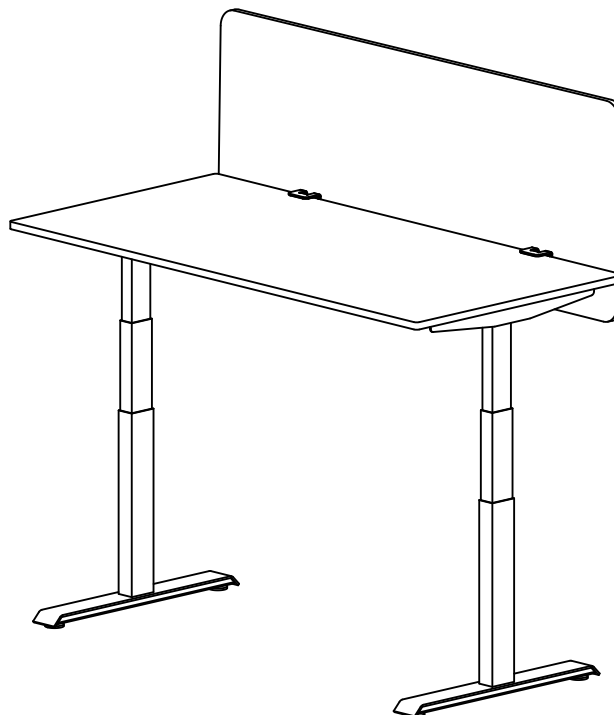

Clamp Mount Bracket with Extra Depth

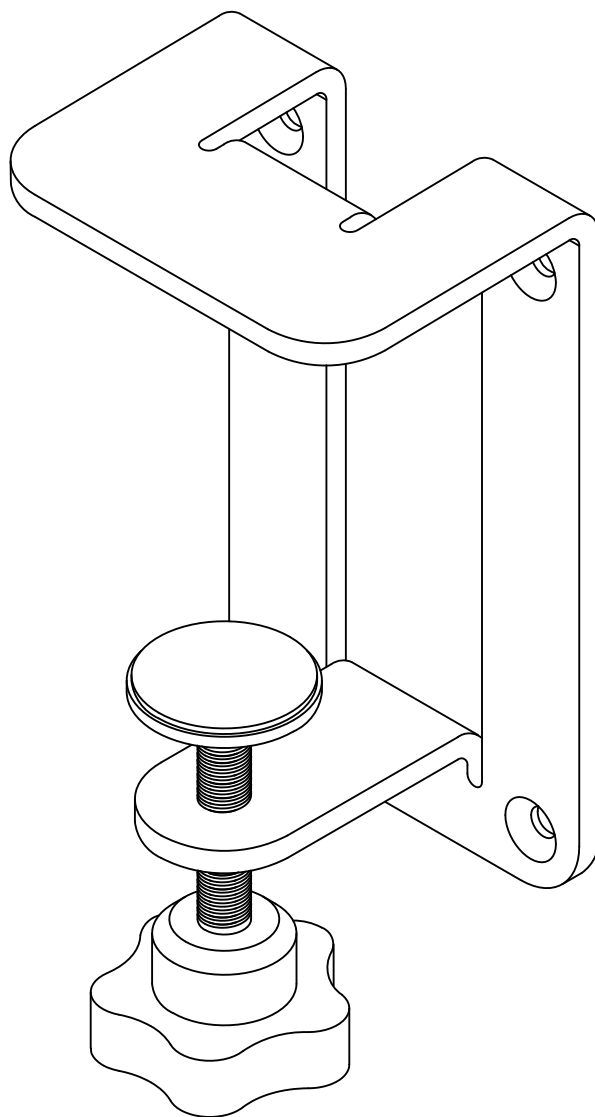

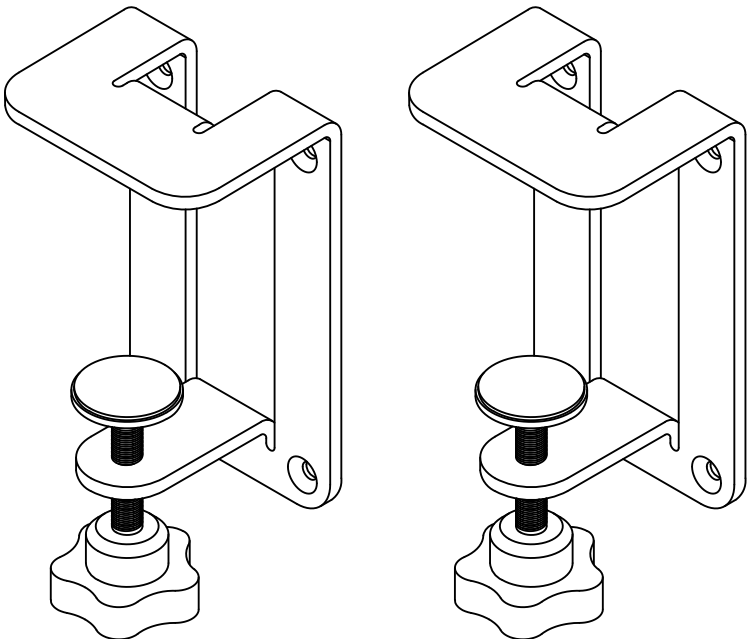

Clamp Mount Bracket with Extra Depth

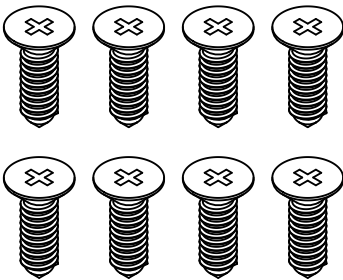

Tapping Screw

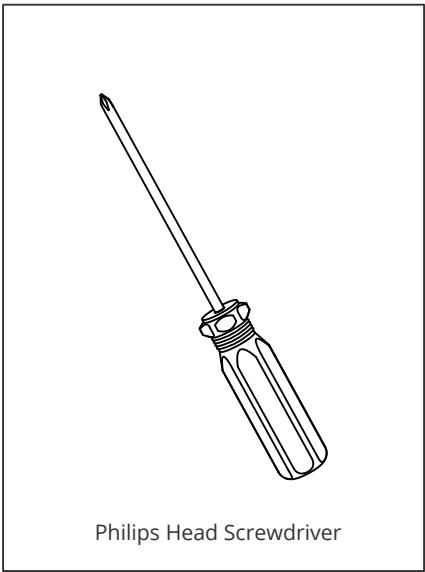

Philips Head Screwdriver

Step 1: Position bracket 25% from each side of the PET privacy screen, as shown.

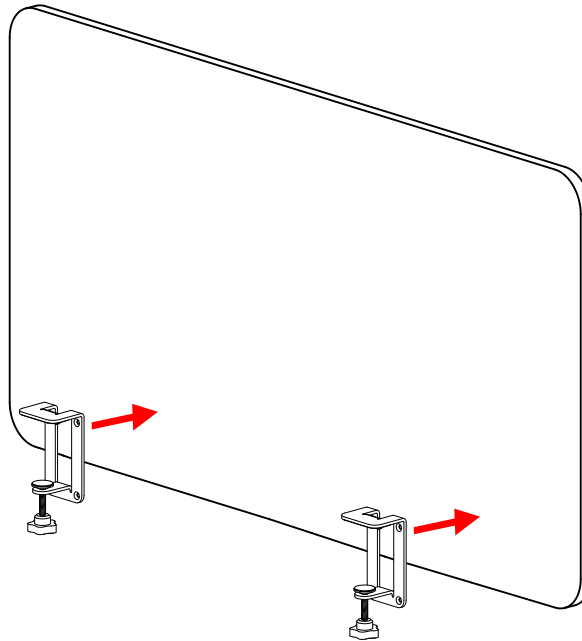

Placement Suggestion: 11" and 18": Align brackets at the bottom of screen.
23": Top of screen to be 11" above surface, 9" below surface
28": Top of screen to be 18" above surface, 9" below surface

Step 2: Fasten bracket to PET privacy screen with tapping screw using screwdriver.

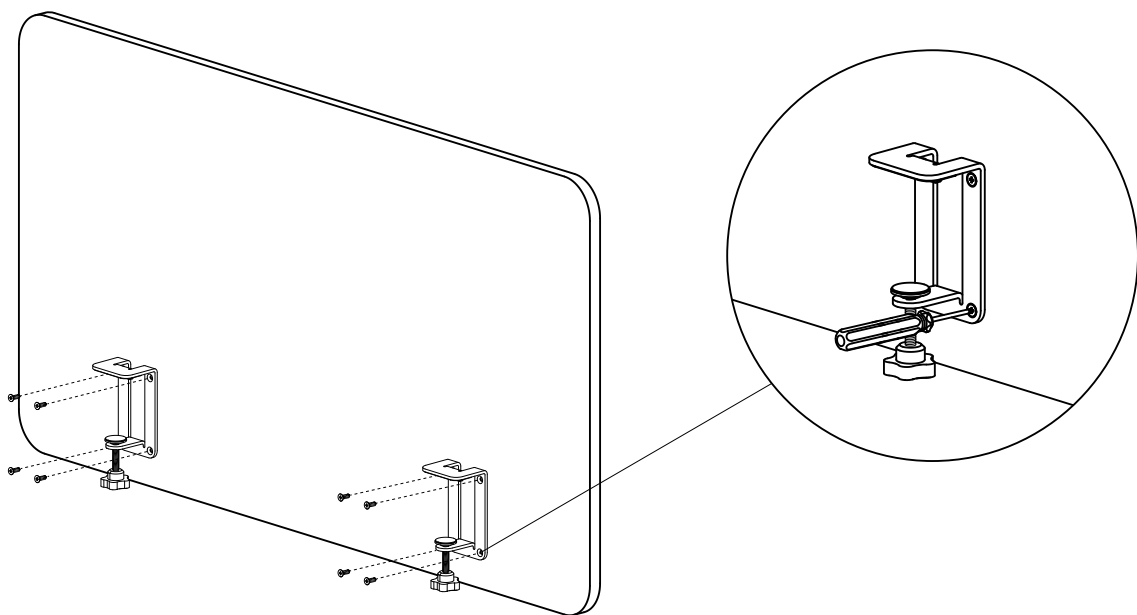

Step 3: Position bracket sub-assembly to rear edge of Axis Desk worksurface. Turn the knob to fasten bracket to Axis Desk.

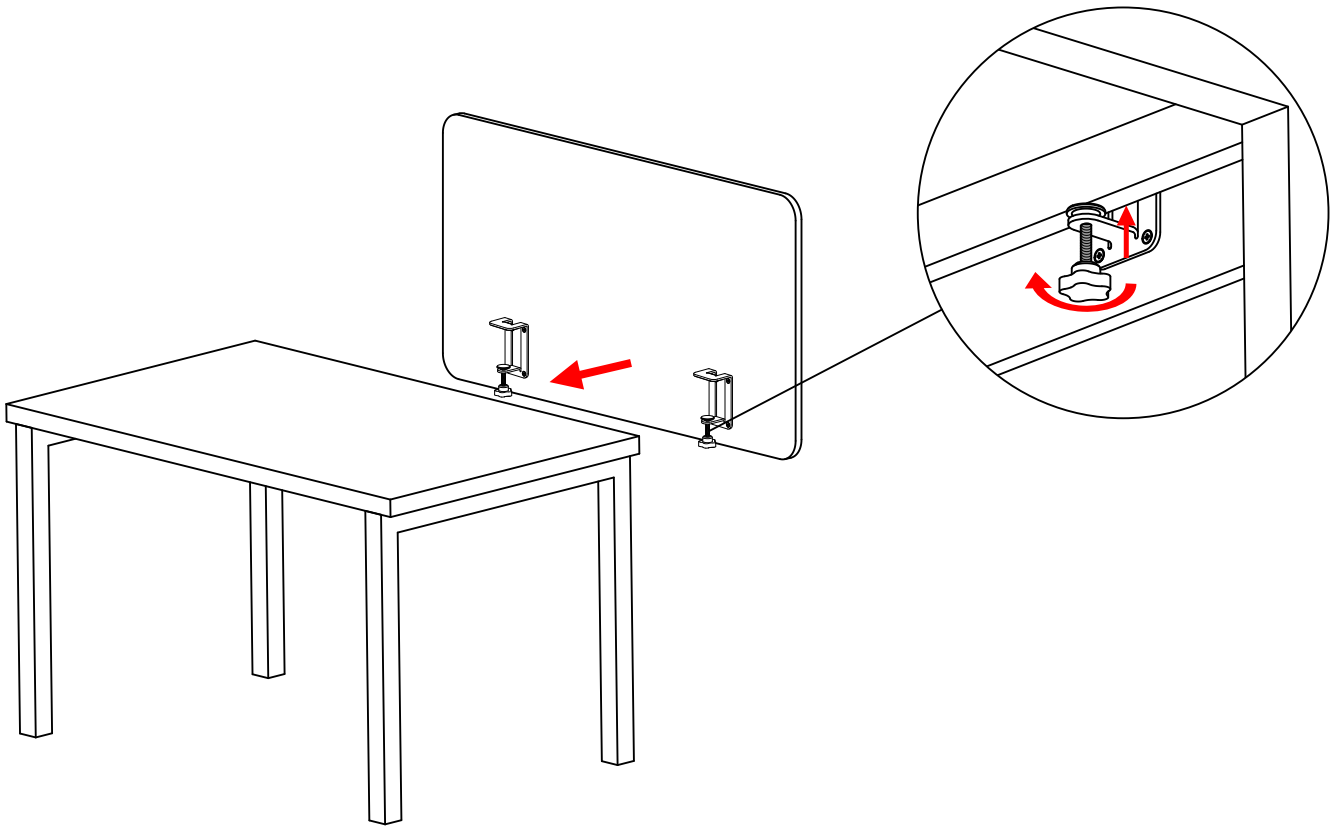

Step 4: Complete

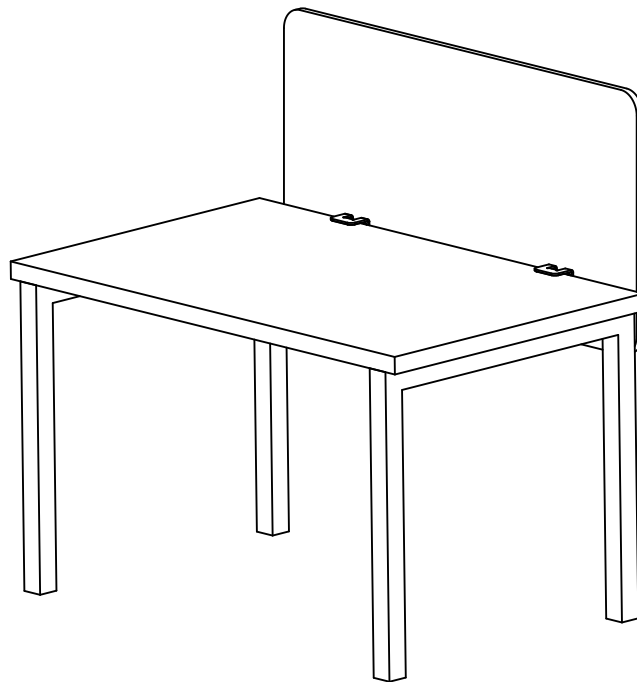

Slip Mount Bracket

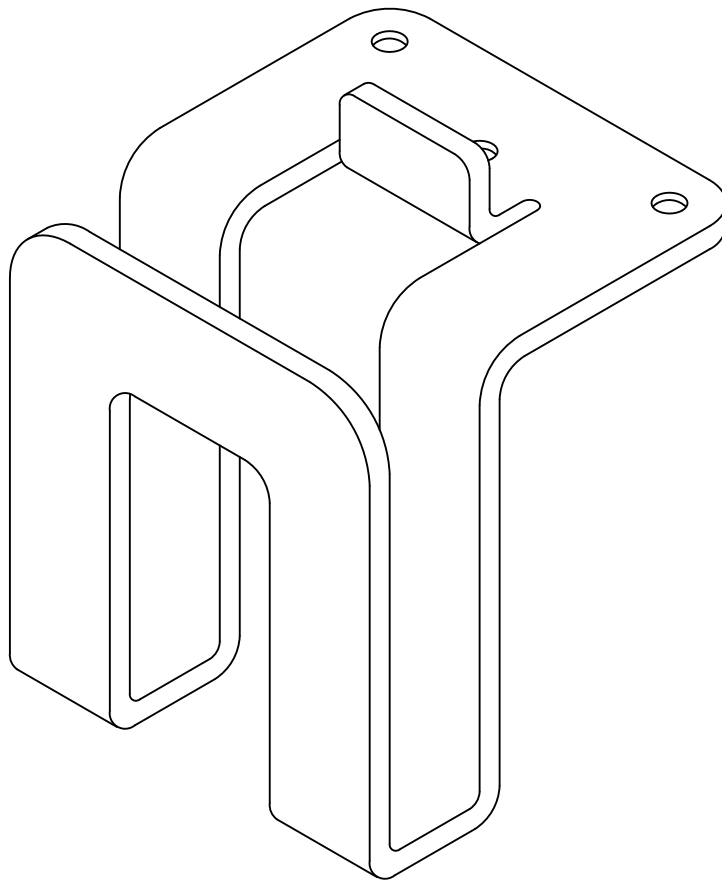

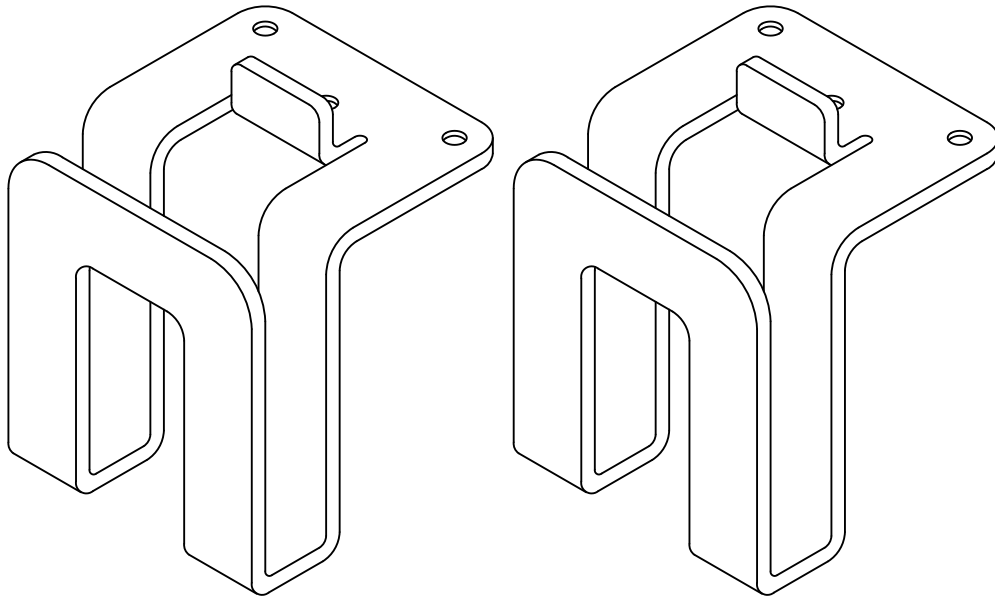

Slip Mount Bracket

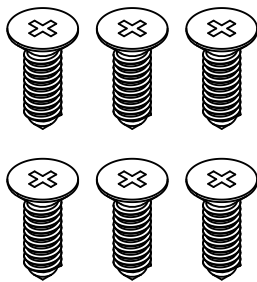

Tapping Screw

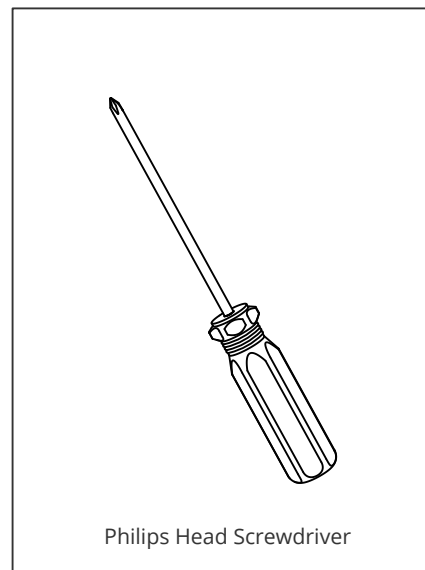

Philips Head Screwdriver

Step 1: Position Slip Mount Bracket 25% from each end and to edge of worksurface.
Make sure the bracket and the bottom of the worksurface are parallel, as shown.

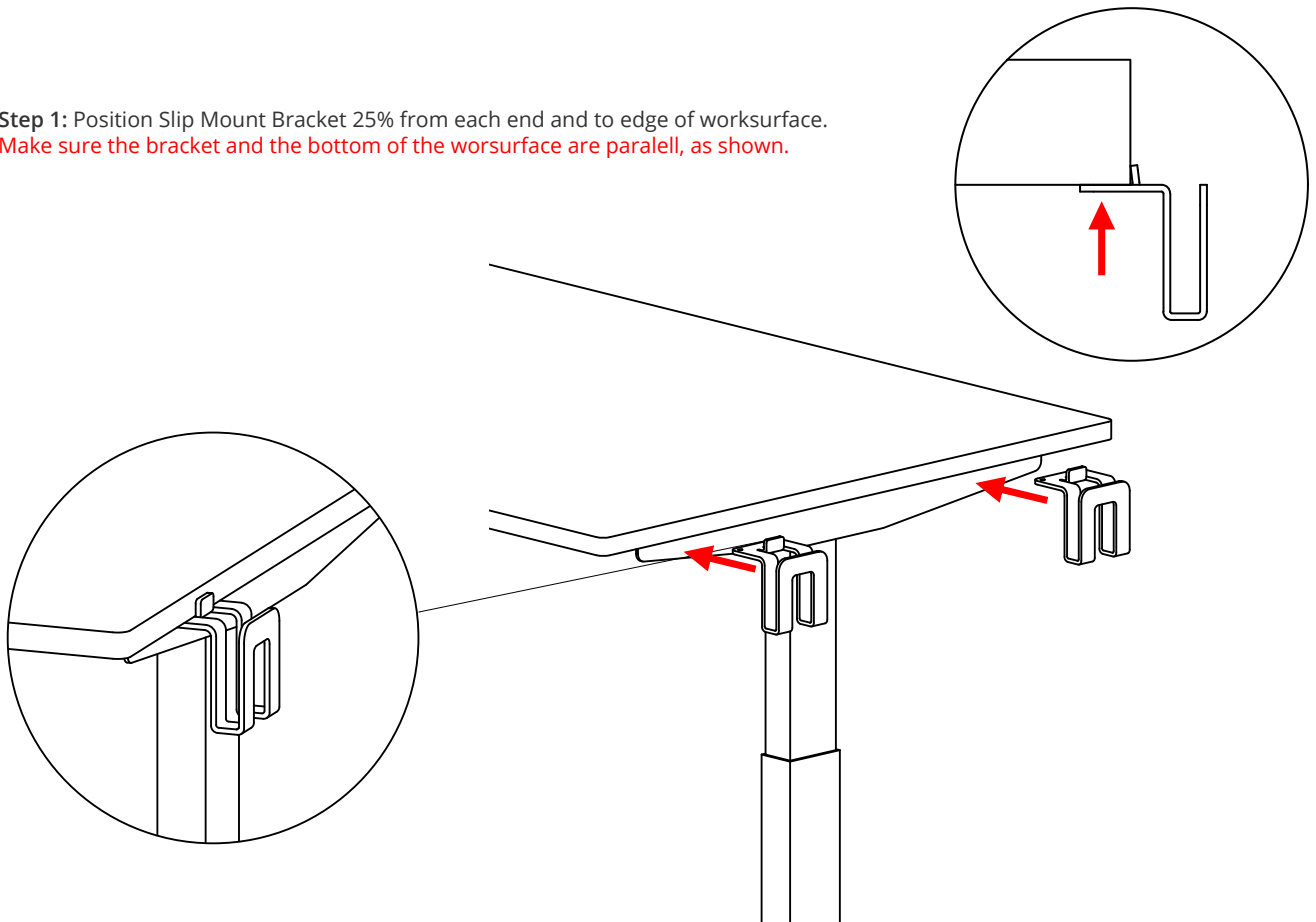

Step 2: Fasten Slip Mount Bracket to worksurface with Tapping Screw using screwdriver.

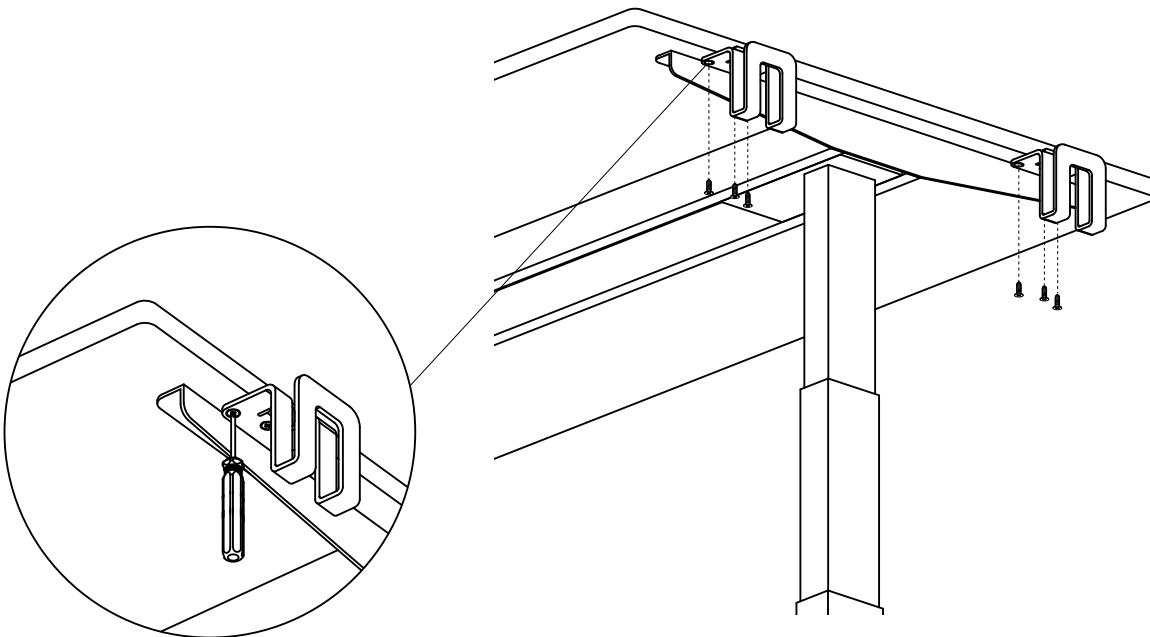

Step 3: Slip in 18mm PET privacy screen

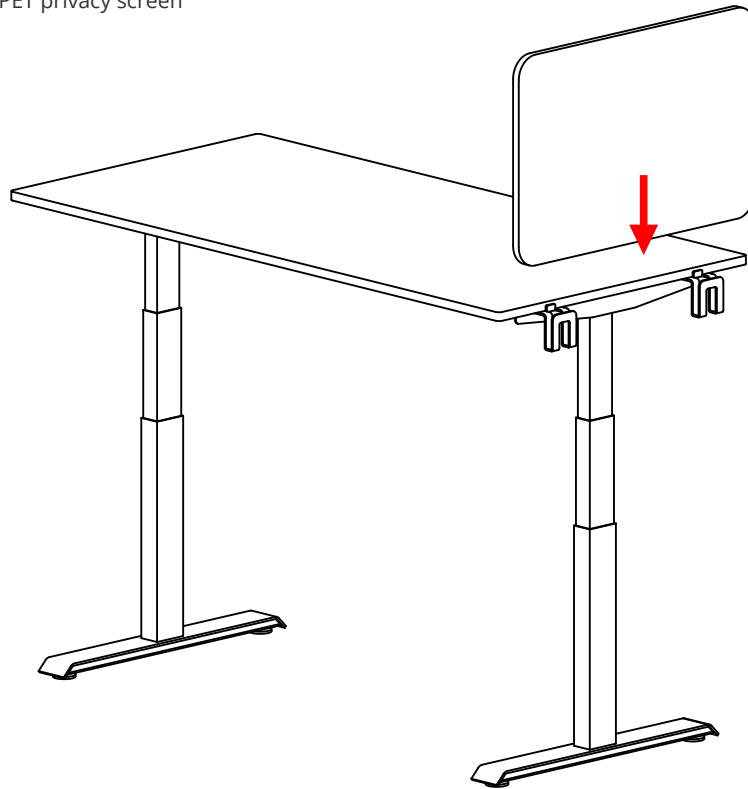

Step 4: Complete

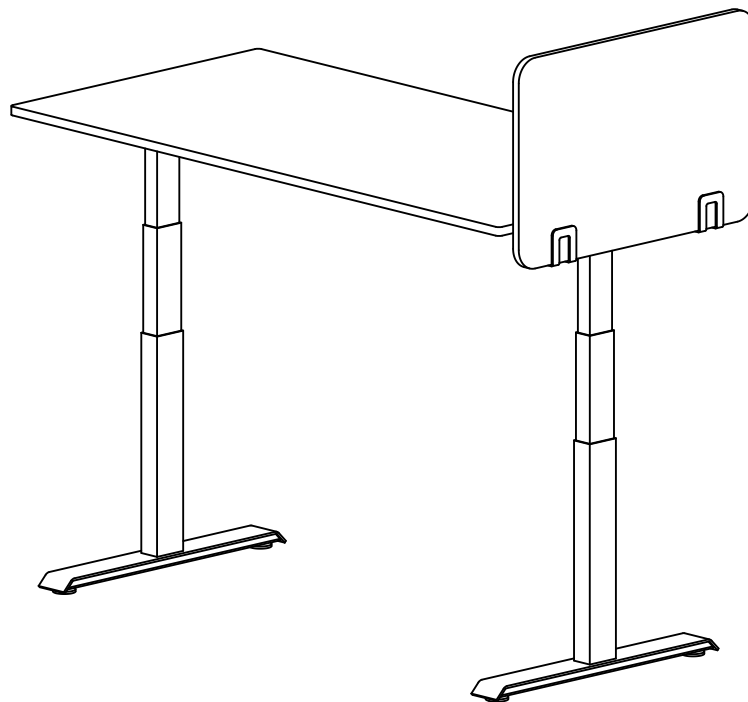

Please contact info@workspace48.com if you are missing any parts, have difficulty with assembly, or have any product-related questions.