

Orbit Divider.

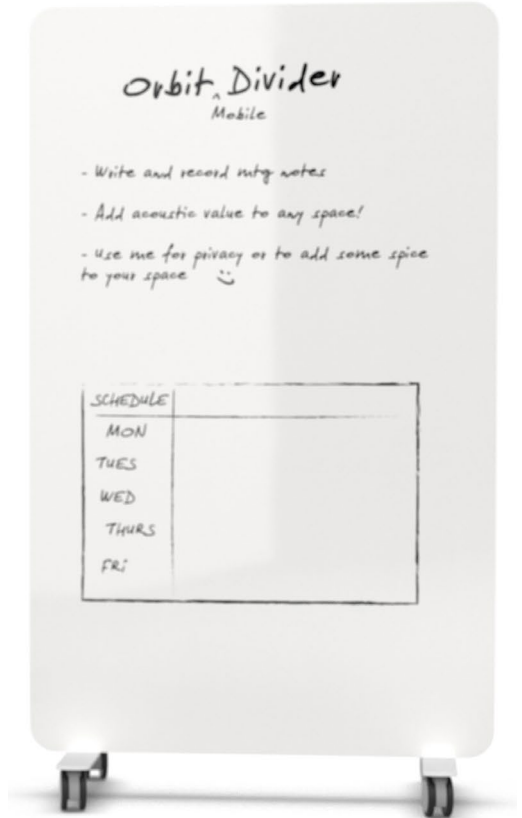

WORKSPACE 48

ORBIT DIVIDER

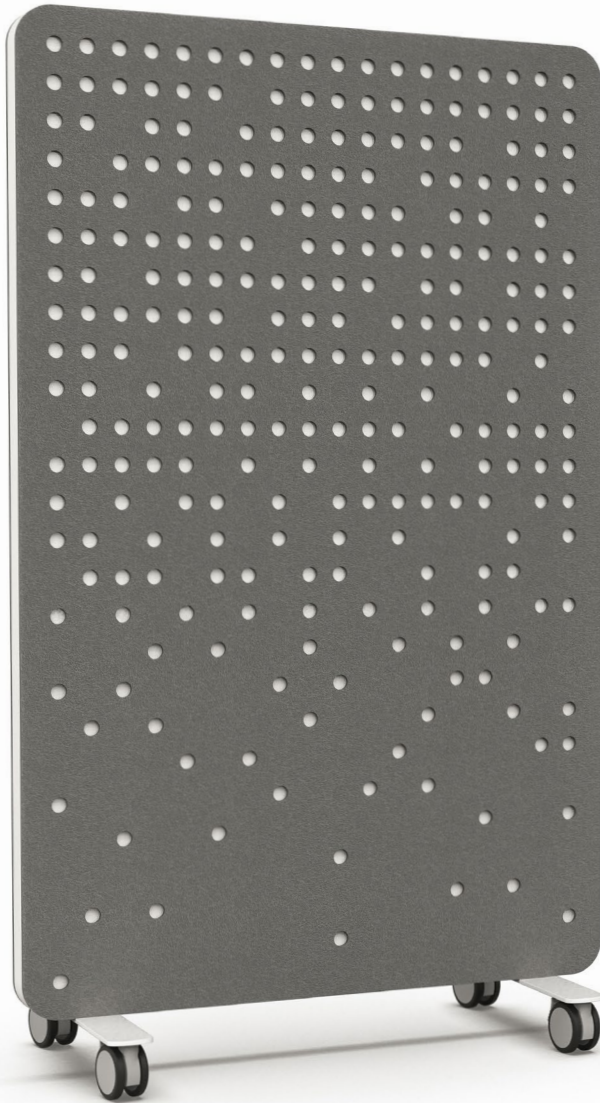

UNIT DIMENSIONS

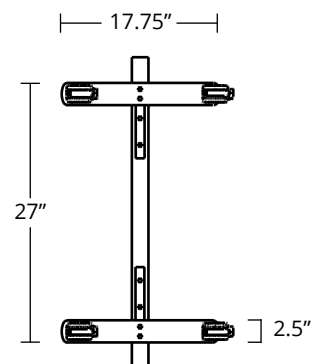
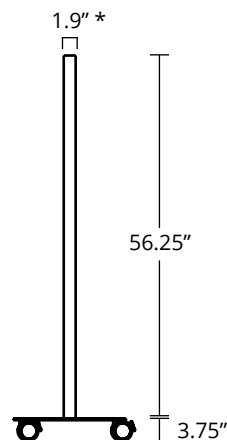
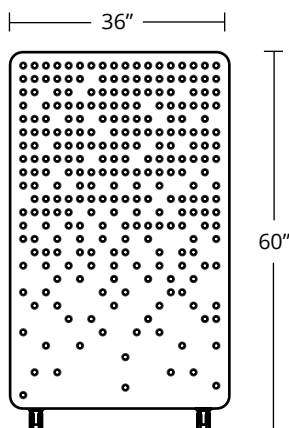

* 2.6" with double sided e-Panel design



STANDARD FEATURES

- Whiteboard HPL surface, Arctic White powder coated feet
- Optional recycled e-Panel design with 0.76 NRC rating for added acoustic/aesthetic properties
- Hollow-core design and CombCore (honey-comb) structure creates rigid lightweight panel
- Locking castors

STANDARD SIZES

- 60"H x 36"W

STANDARD FINISHES

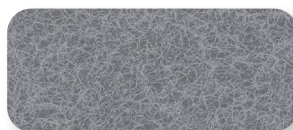

Deep Grey e-Panel (pixel design only)

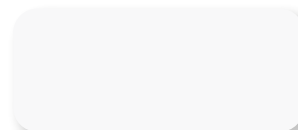

Arctic White powder coat



Whiteboard HPL

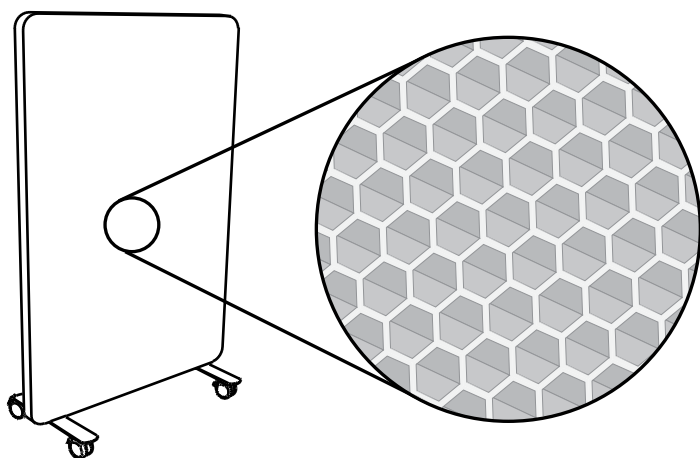

CombCore Structure



Significant reduction in weight and material for ease of mobility



Environmentally friendly, produced from 100% recycled materials



TORONTO +1 416 441 9898

WORKSPACE 



ANVIL



AXIS



AGILE



STORAGE
& RECEPTION



MODULUS



MODULUS FLIP



UNI FLIP