

# Agile.

height adjustable desks



**WORKSPACE** 

# AGILE SINGLE SIDED

**BIFMA**



## STANDARD FEATURES

- Black powdercoat and Arctic White powdercoat to all steel components
- Stock laminates are shown below\*. Other finish options are available with extended lead times.
- Standard screen colours in Spectrum Red, Deep Grey, and Bright Blue
- Overload operation protection
- Electronic screen displaying exact height with 4 preset height settings
- Wide base foot and leveler for adjustment
- Height range: 26" - 43.5"
- Load capacity: 225 lbs.
- Height adjustment speed: 1"/second
- BIFMA compliant

## STANDARD FRAME SIZES ACCOMMODATE WORKSURFACE SIZES

48"w x 24"d	60"w x 30"d
48"w x 30"d	72"w x 24"d
60"w x 24"d	72"w x 30"d



Single-sided Desk

**10 YEAR GUARANTEE\***  
\*5 Year Guarantee on electric motor

### Laminate



Classic White



Continental Walnut



Landmark Wood



Grey Elm

\*Extended lead times on 90° worksurfaces

### Frame Color



Black



White

### Screen Color



Bright Blue



Spectrum Red



Deep Grey

## UNIT DIMENSIONS

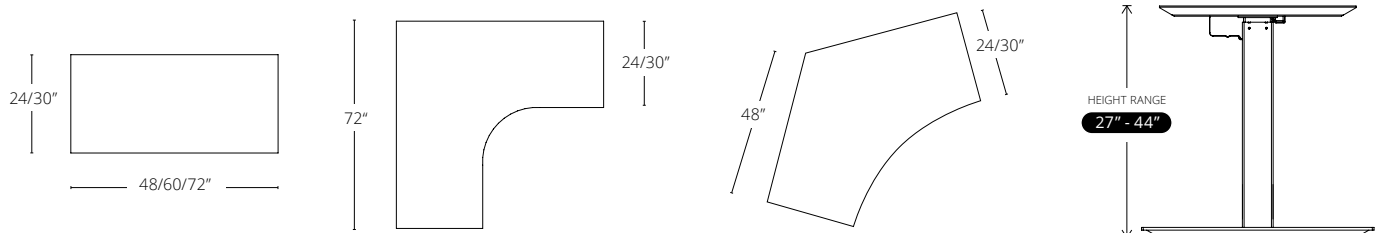

# AGILE BACK-TO-BACK



## STANDARD FEATURES

- Black powdercoat and Arctic White powdercoat to all steel components
- Stock laminates are shown below. Other finish options are available with extended lead times
- Standard screen colours in Spectrum Red, Deep Grey, and Bright Blue
- Overload operation protection
- Electronic screen displaying exact height with 4 preset height settings
- Wide base foot and leveler for adjustment
- Height range: 26" - 43.5"
- Load capacity: 225 lbs.
- Height adjustment speed: 1" second
- BIFMA compliant

## STANDARD FRAME SIZES ACCOMMODATE WORKSURFACE SIZES

48"w x 24"d	60"w x 30"d
48"w x 30"d	72"w x 24"d
60"w x 24"d	72"w x 30"d



Single-sided Desk

**10 YEAR GUARANTEE\***  
\*5 Year Guarantee on electric motor

### Laminate



Classic White



Continental Walnut



Landmark Wood



Grey Elm

### Frame Color



Black



White

### Screen Color



Bright Blue



Spectrum Red



Deep Grey

## UNIT DIMENSIONS

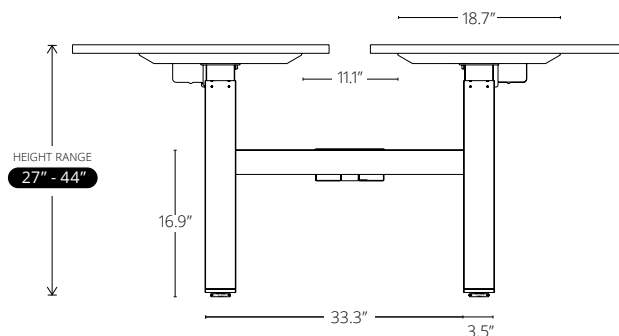
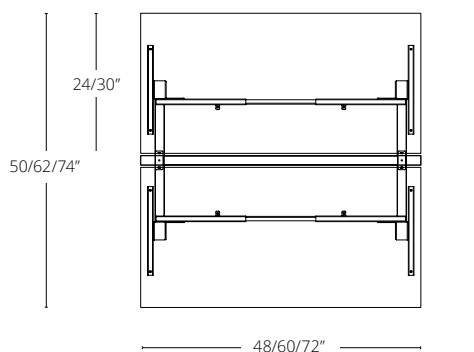



# DIVIDERS & ELECTRICAL



## DIVIDERS

### STANDARD FEATURES

- Spine screens clamp onto the desk worktop
- Adjustable height between 13"-18"
- Divider panels slide onto the desk worktop
- e-Panel produced from recycled materials
- All e-Panel material is tackable

### STANDARD SIZES

Spine Screens

- 47" x 24"
- 59" x 24"

Divider Panels

- 23" x 12"
- 29" x 12"

### IN-STOCK COLOR OPTIONS



Spectrum Red



Deep Grey



Bright Blue

*\*Additional color options available at extended lead time.*



Spine screen for  
singled sided desk



Spine screen for  
double sided desk

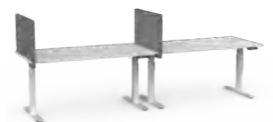

Slide on return divider panel

## CABLE MANAGEMENT



Cable cobra



Cable clutch



Single sided under-mount cable  
tray



Double sided under-mount cable  
tray

## POWER MODULES



Voltra above desk clamp-on power  
module