

# Versi Assembly Guide

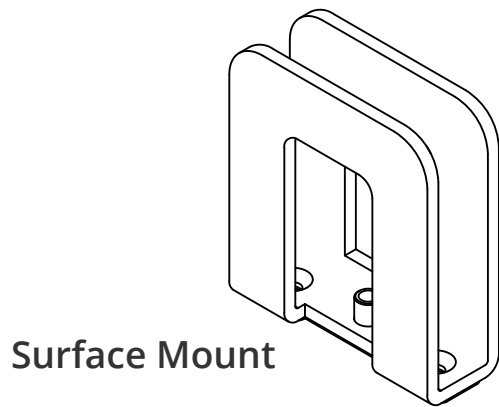

Surface Mount

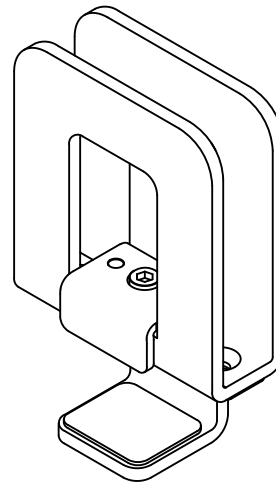

Surface Mount  
with Clamp

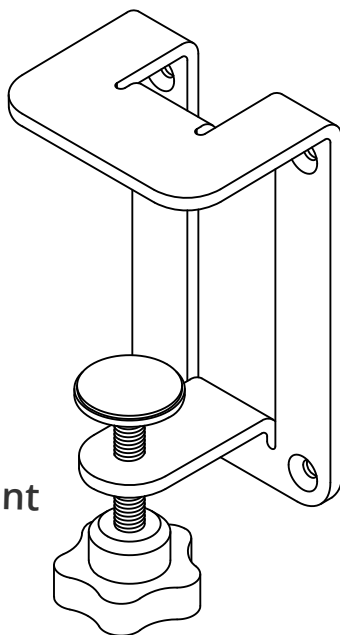

Clamp Mount  
with Extra  
Depth

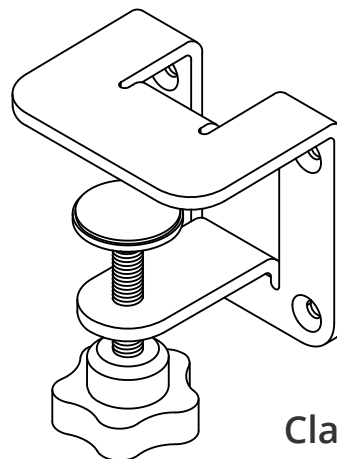

Clamp Mount

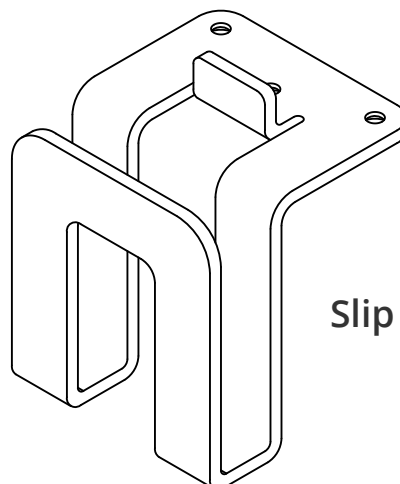

Slip Mount

**Surface Mount**  
Components ..... 2  
Installation ..... 3-4  
Glass Sleeve .....5

**Surface Mount with Clamp**  
Components ..... 7  
Installation ..... 8-10  
Glass Sleeve .....11

**Clamp Mount**  
Components ..... 13  
Installation ..... 14-15

**Clamp Mount with Extra Depth**  
Components ..... 17  
Installation ..... 18-19

**Slip Mount**  
Components ..... 21  
Installation ..... 22-23

---

## Surface Mount Bracket

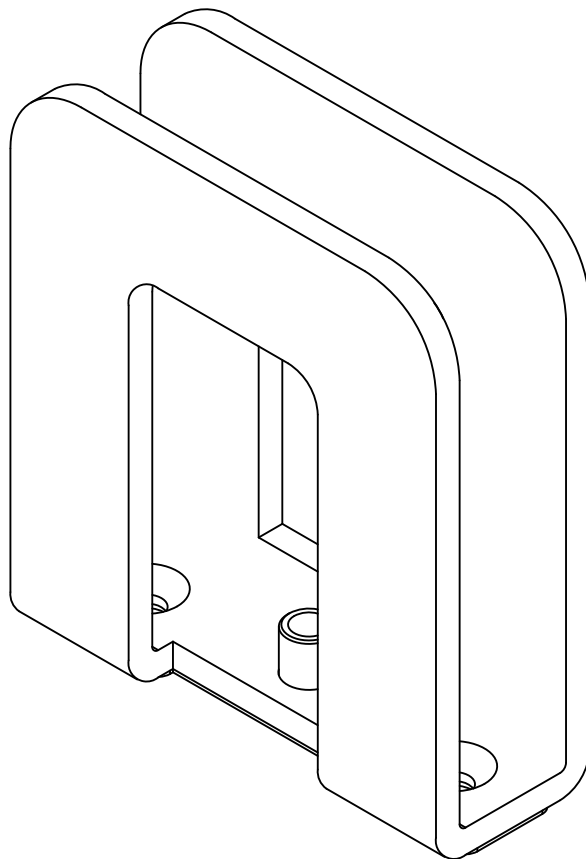

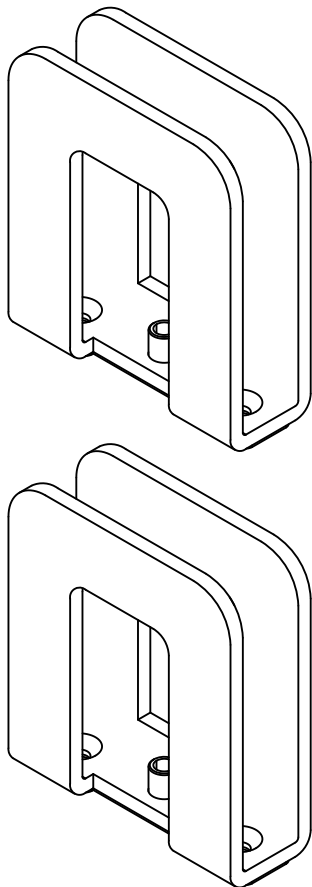

Surface Mount Bracket

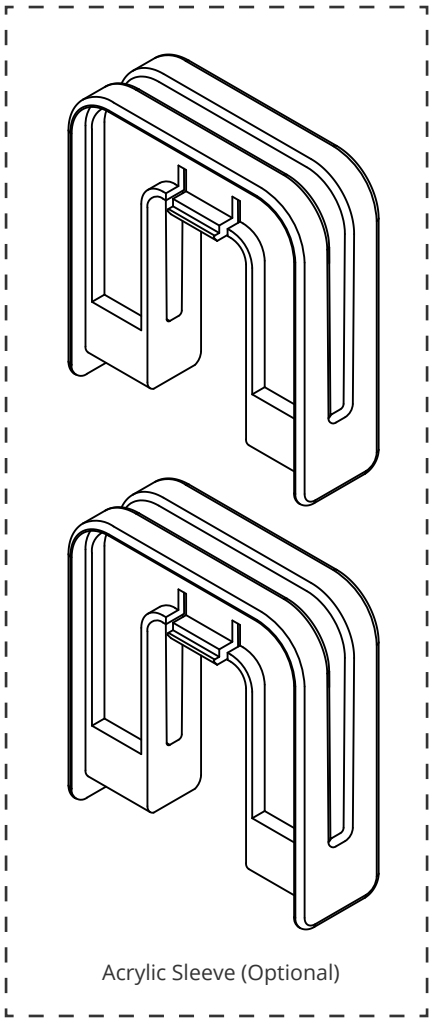

Acrylic Sleeve (Optional)

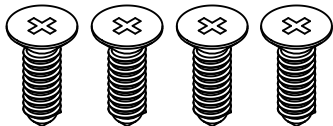

Tapping Screw

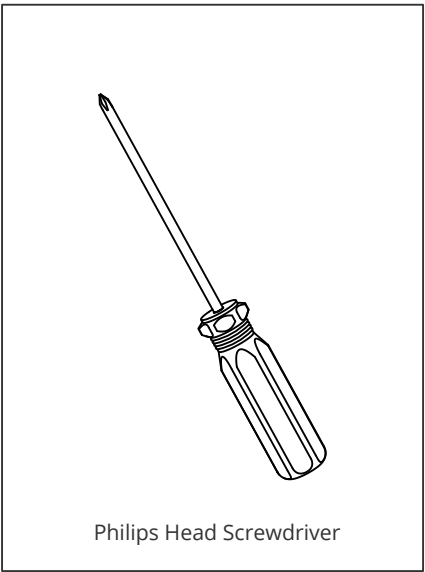

Philips Head Screwdriver

**Step 1:** Position bracket 25% from each end and to edge of worksurface.

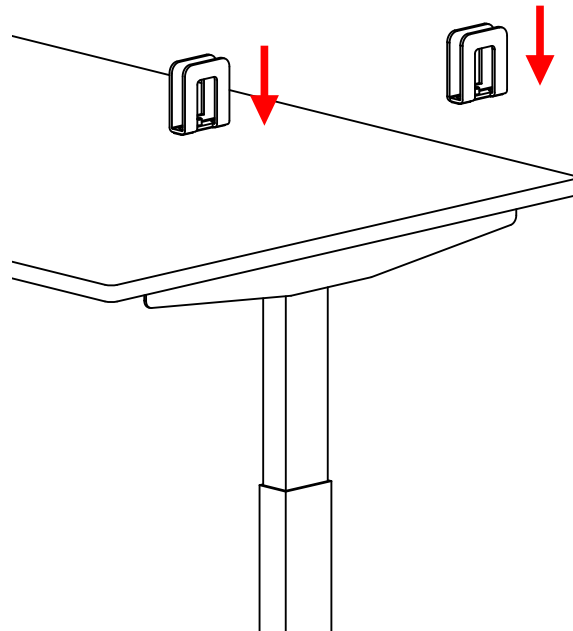

**Step 2:** Fasten bracket to worksurface with Tapping Screw using screwdriver.

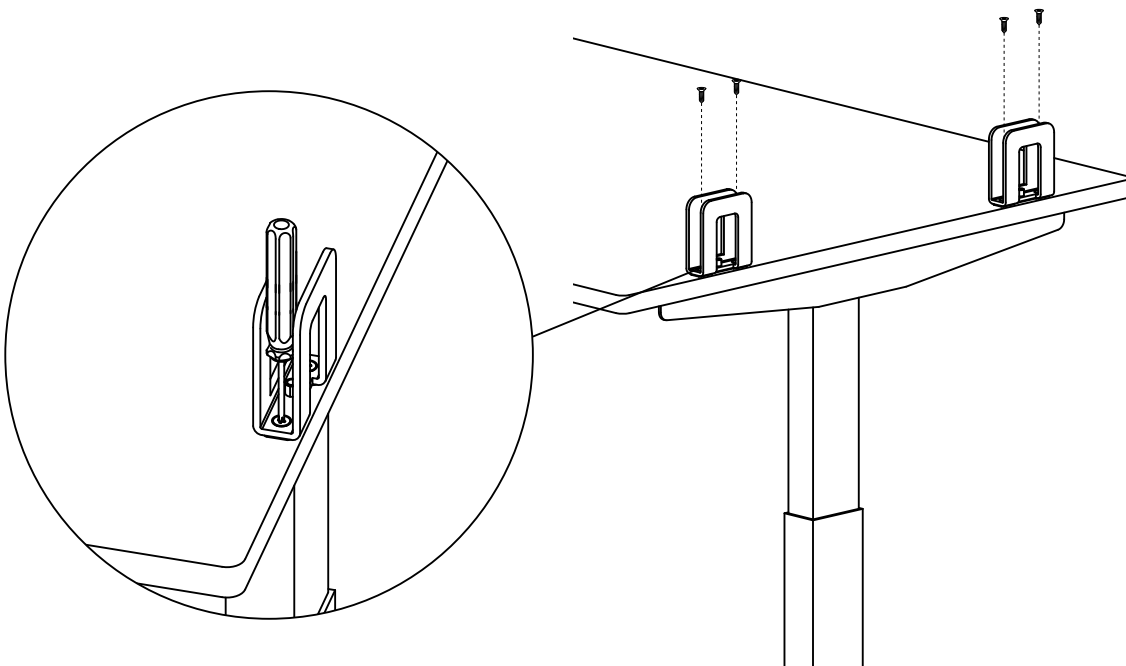

Step 3: Slip in 18mm PET privacy screen

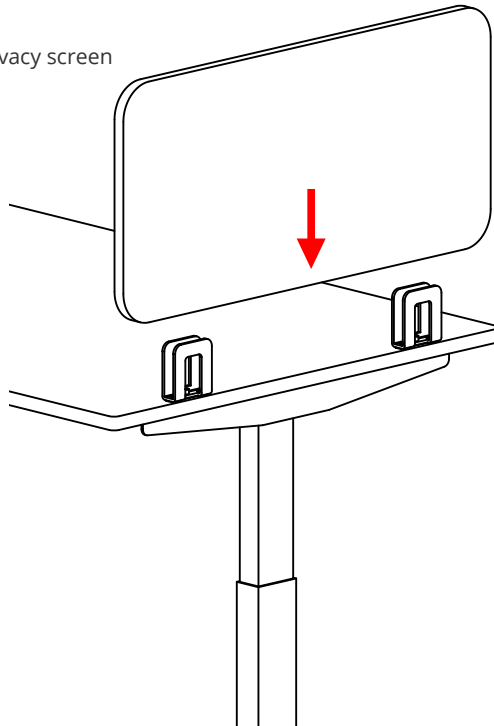

---

Step 4: Complete

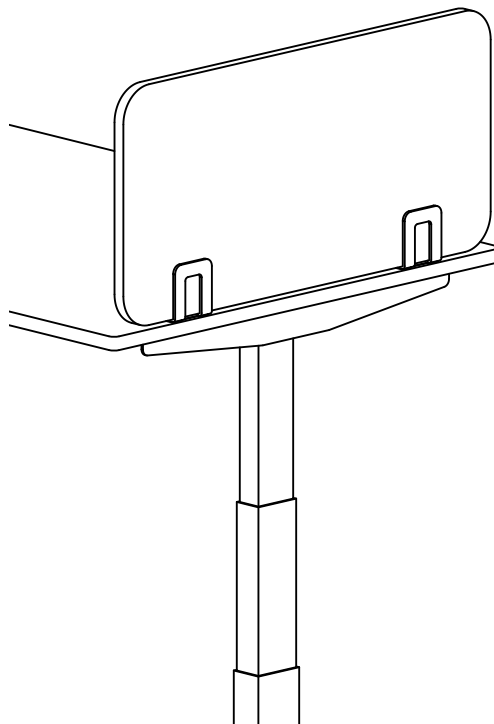

Step 5: Slip in Acrylic Sleeve until a "click" is felt.

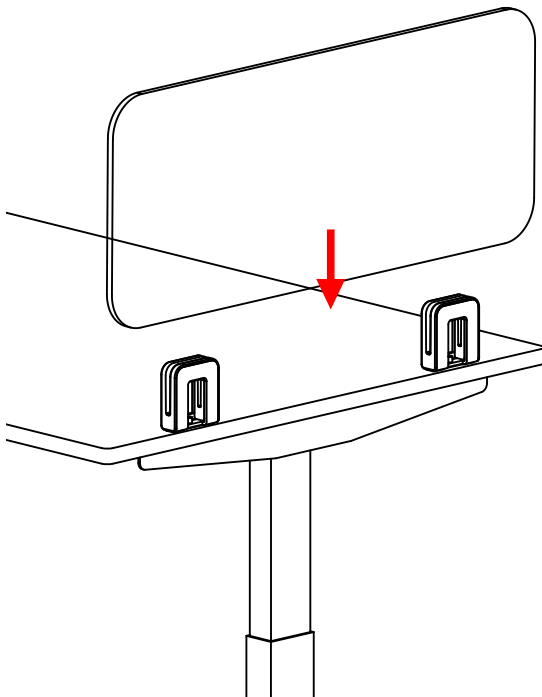
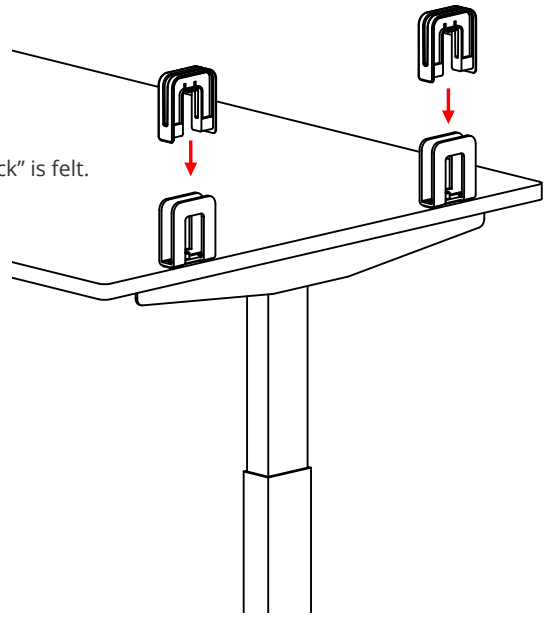

Step 6: Slip in 6mm acrylic screen

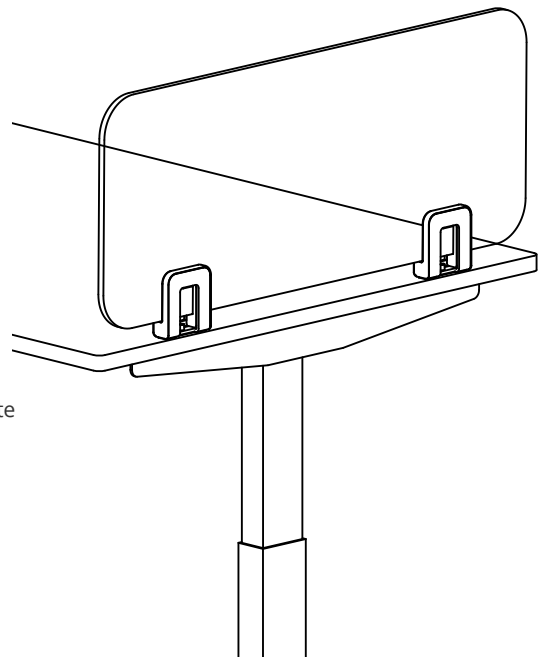

Step 7: Complete

---

## Surface Mount Bracket With Clamp

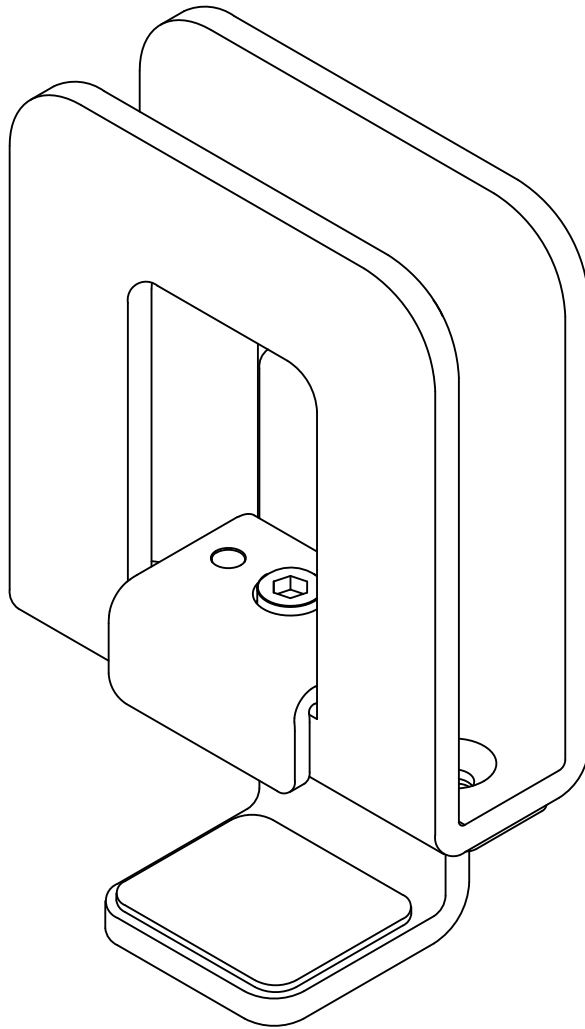



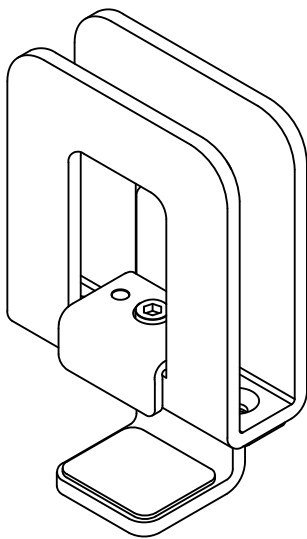
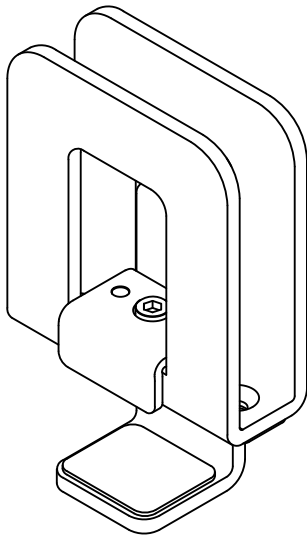

Surface Mount Bracket  
with Clamp

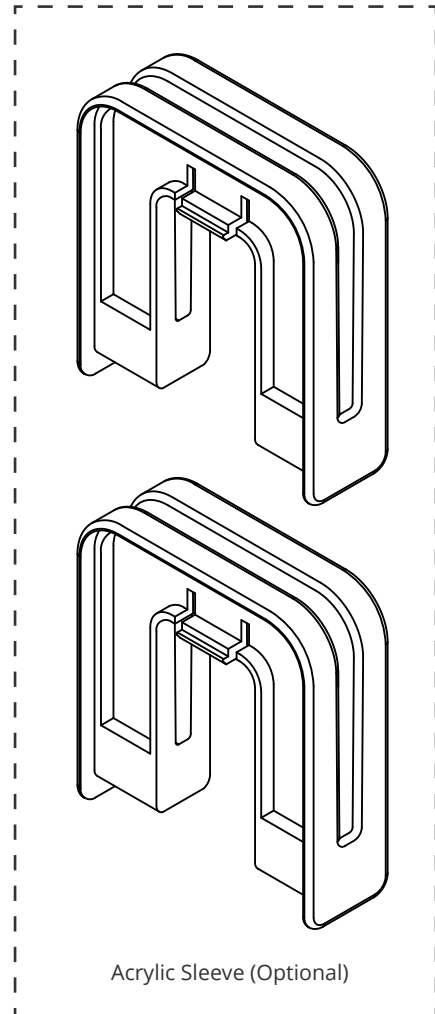

Acrylic Sleeve (Optional)

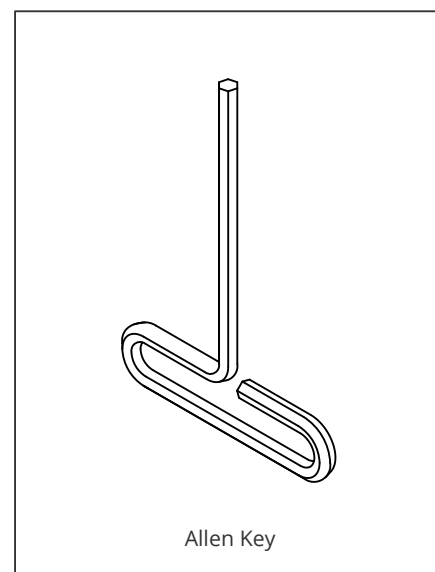

Allen Key

**Step 1:** Position bracket 25% from each end and to edge of worksurface.

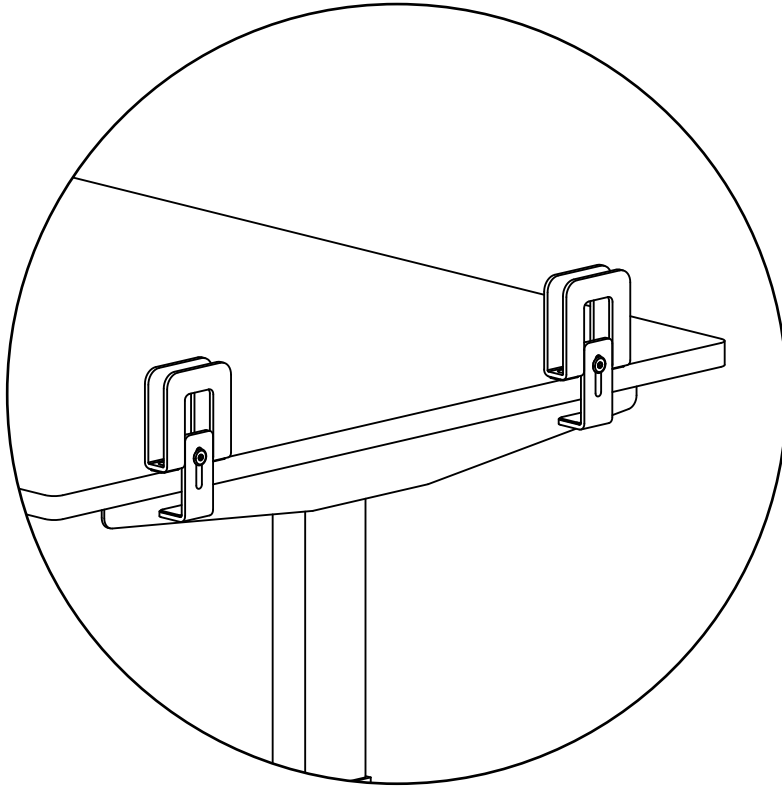

**Step 2:** Push the clamp up to fit the thickness of the worksurface.

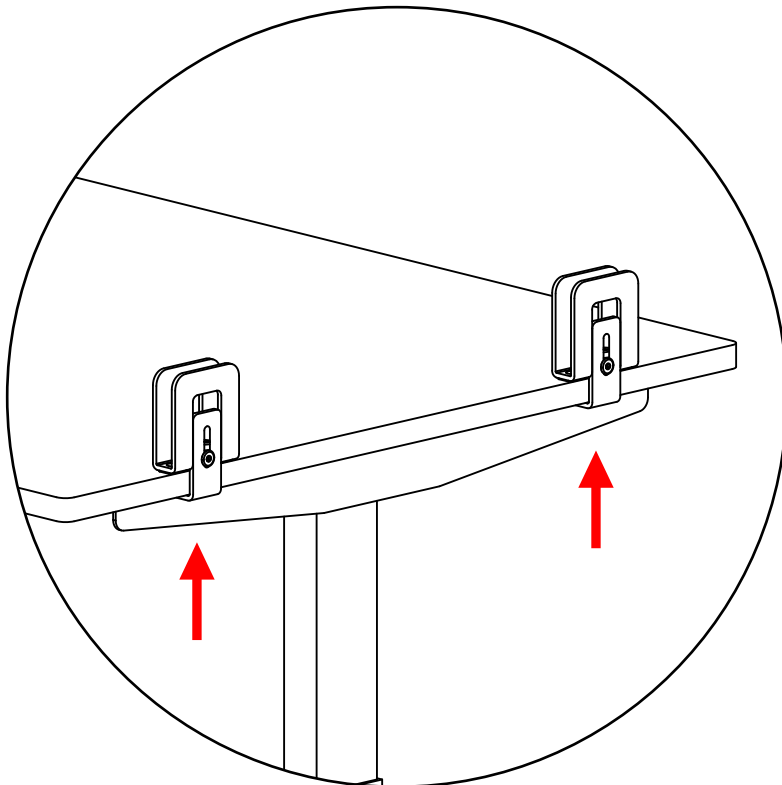

**Step 3:** Tighten the side screw by turning the Allen key clockwise.

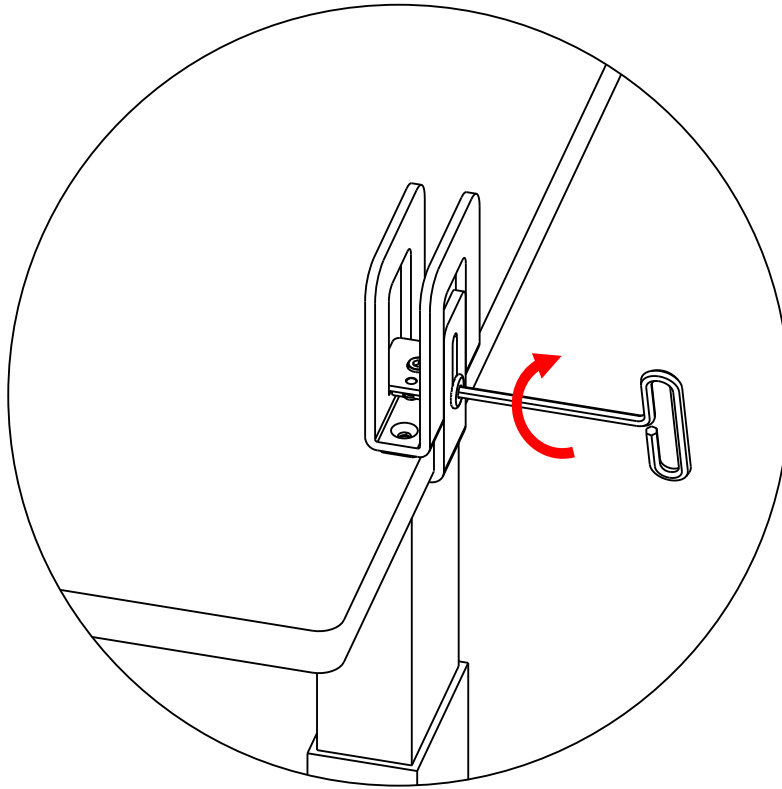

**Step 4:** Tighten the inner screw by turning the Allen key **counterclockwise**.

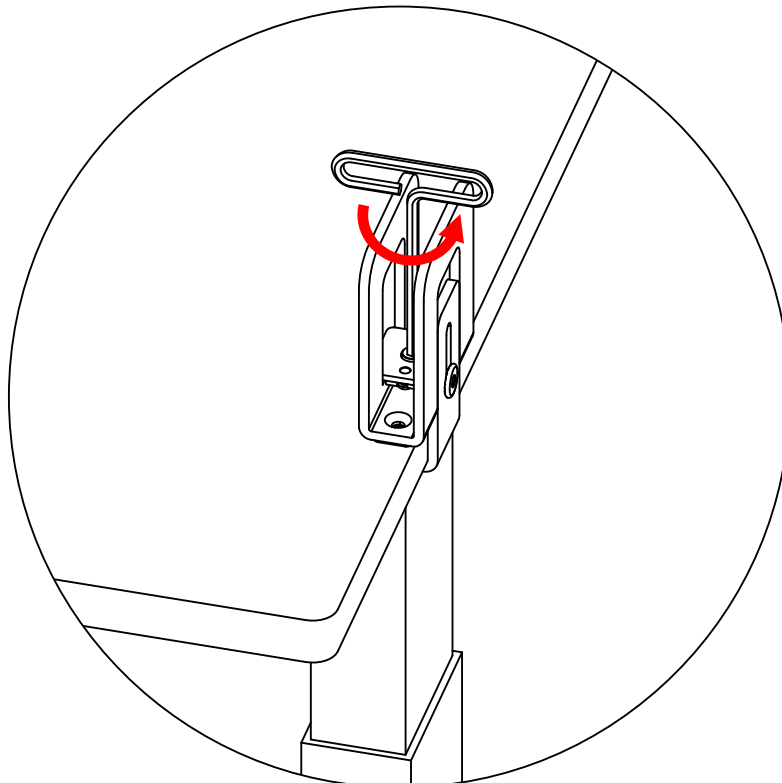

Step 5: Slip in 18mm PET privacy screen

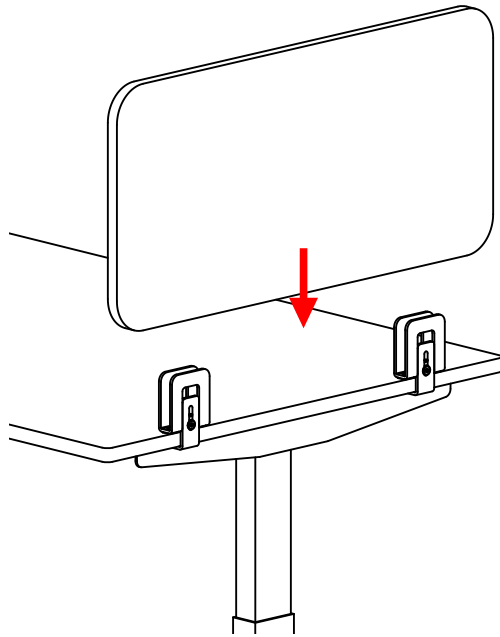

---

Step 6: Complete

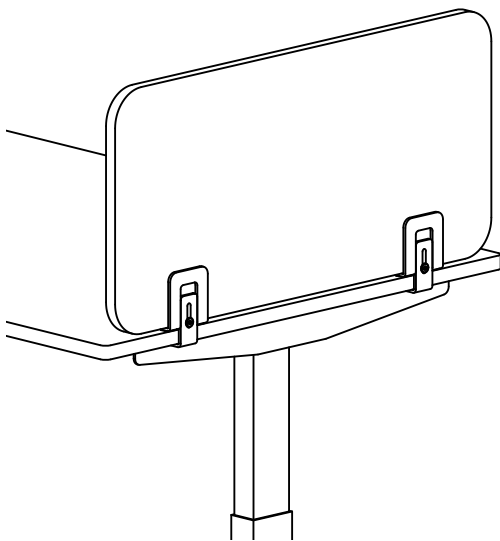

Step 7: Slip in Acrylic Sleeve until a "click" is felt.

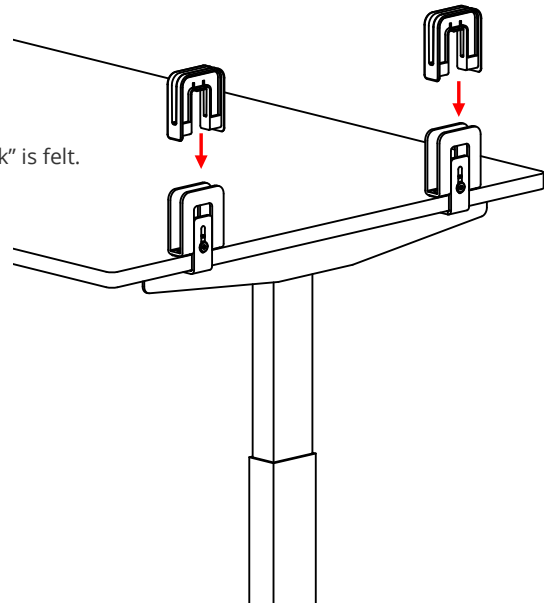

Step 8: Slip in 6mm Acrylic panel

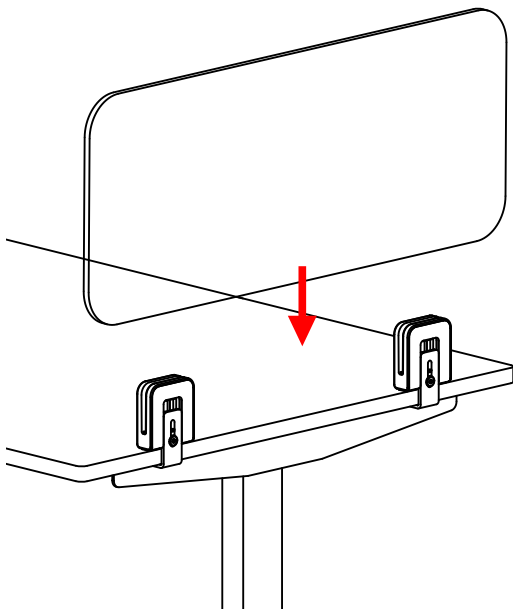

Step 9: Complete

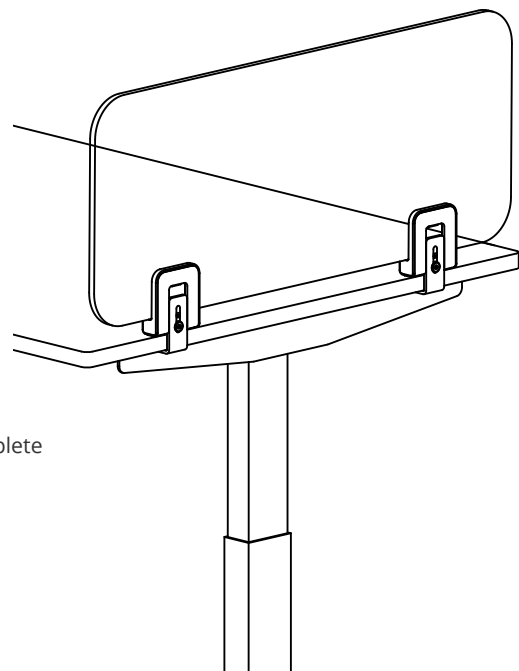

---

## Clamp Mount Bracket

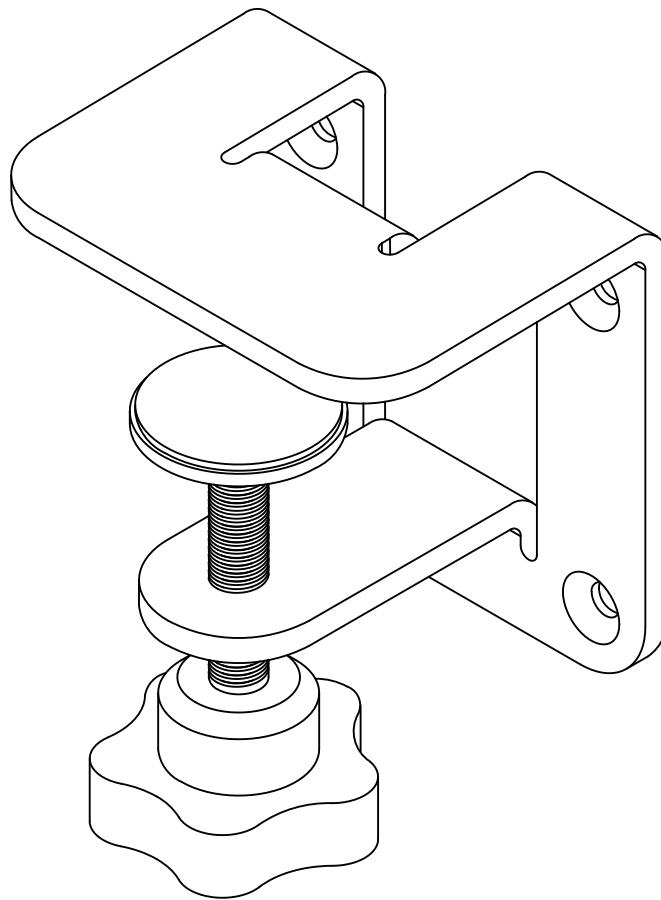

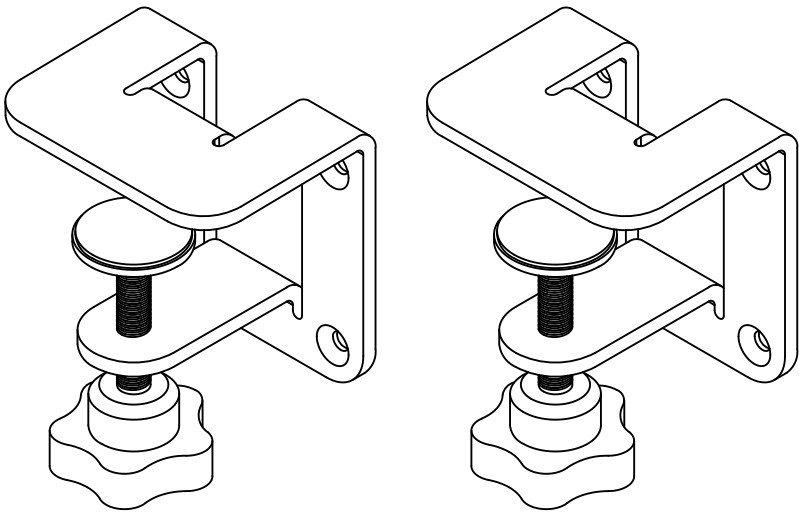

Clamp Mount Bracket

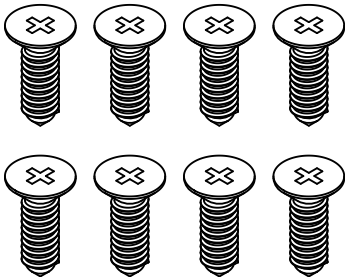

Tapping Screw

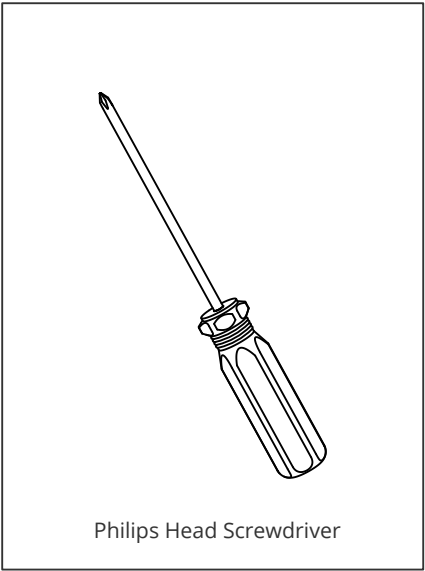

Philips Head Screwdriver

**Step 1:** Position bracket 25% from each side of the PET privacy screen, as shown.

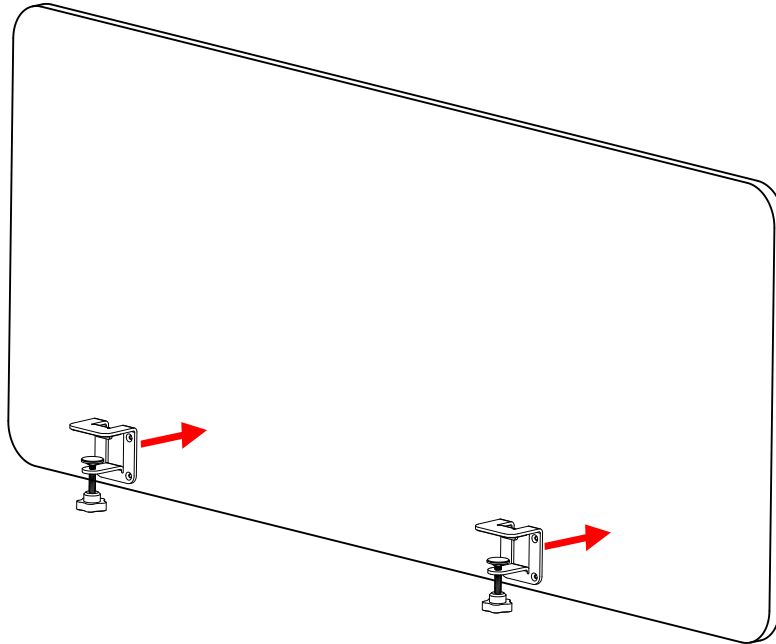

**Placement Suggestion:** 11" and 18": Align brackets at the bottom of screen.  
23": Top of screen to be 11" above surface, 9" below surface  
28": Top of screen to be 18" above surface, 9" below surface

**Step 2:** Fasten bracket to PET privacy screen with tapping screw using screwdriver.

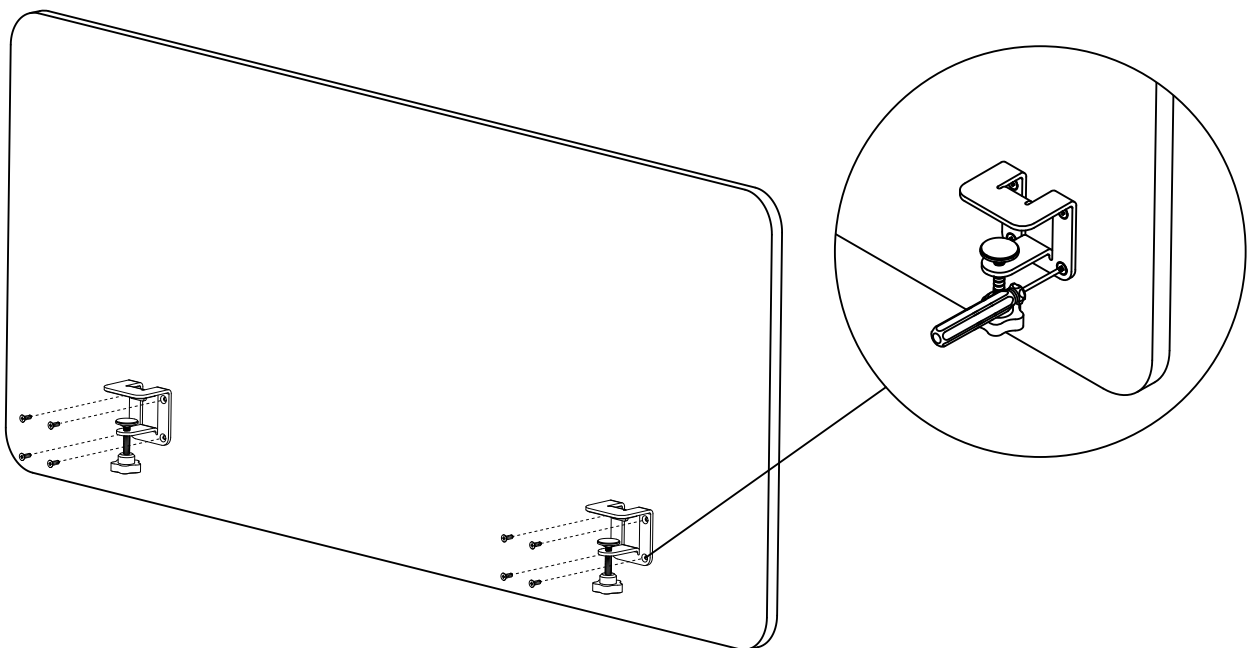



**Step 3:** Position bracket sub-assembly to edge of worksurface. Turn the knob to fasten bracket to worksurface

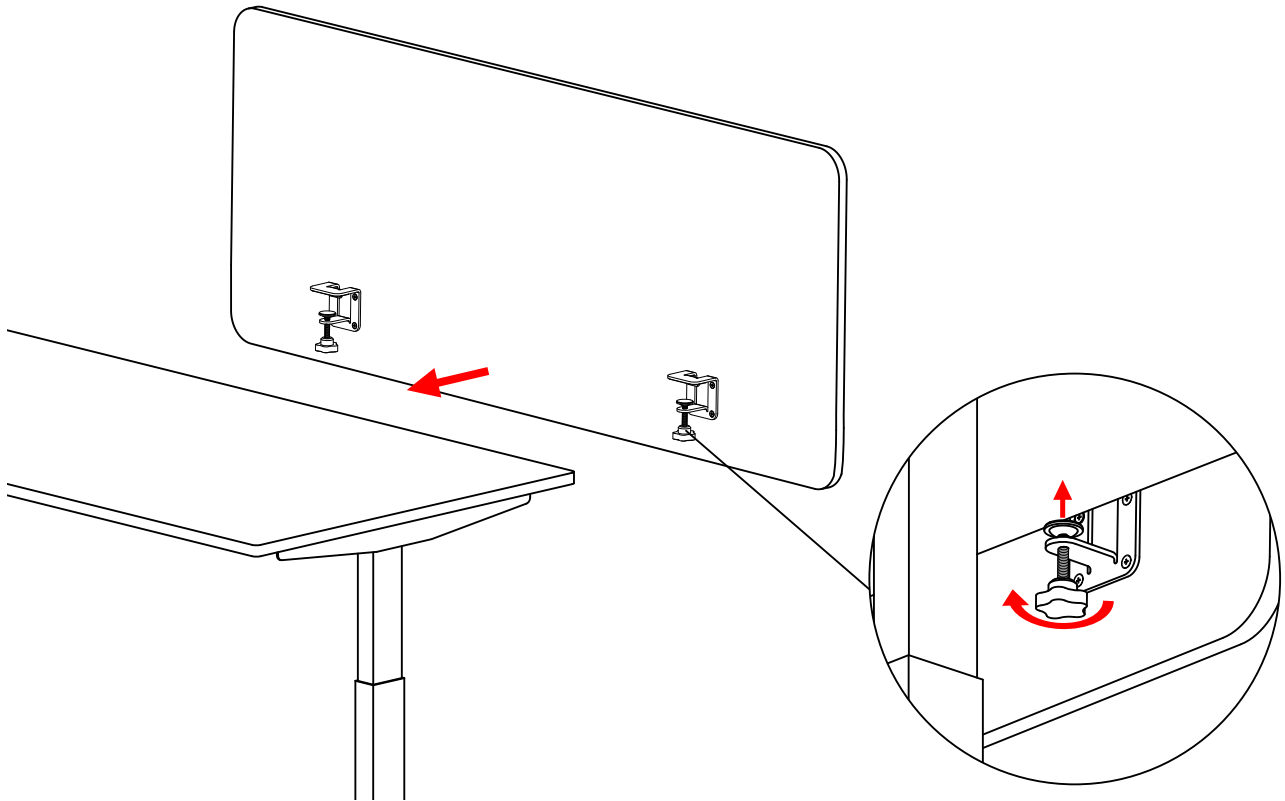

**Step 4:** Complete

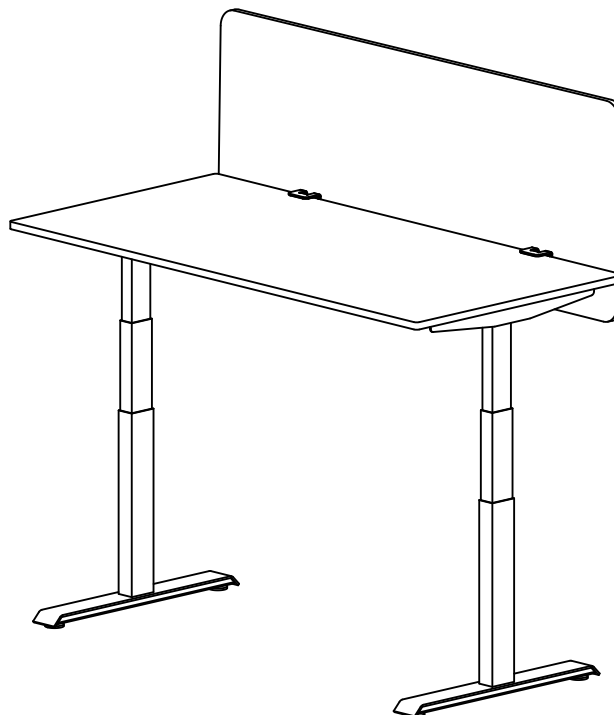

---

## Clamp Mount Bracket with Extra Depth

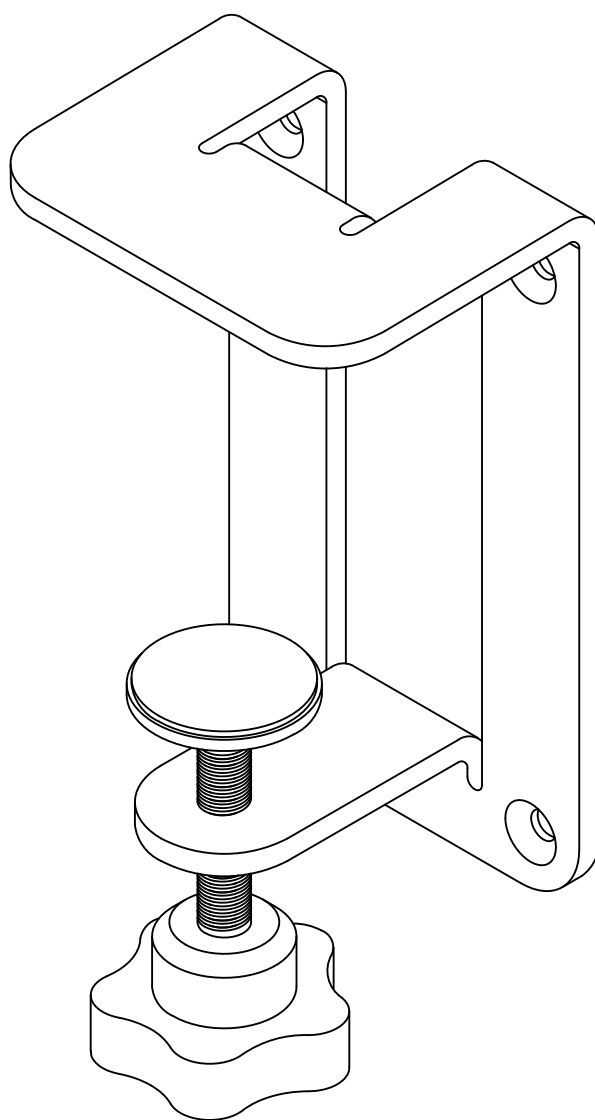

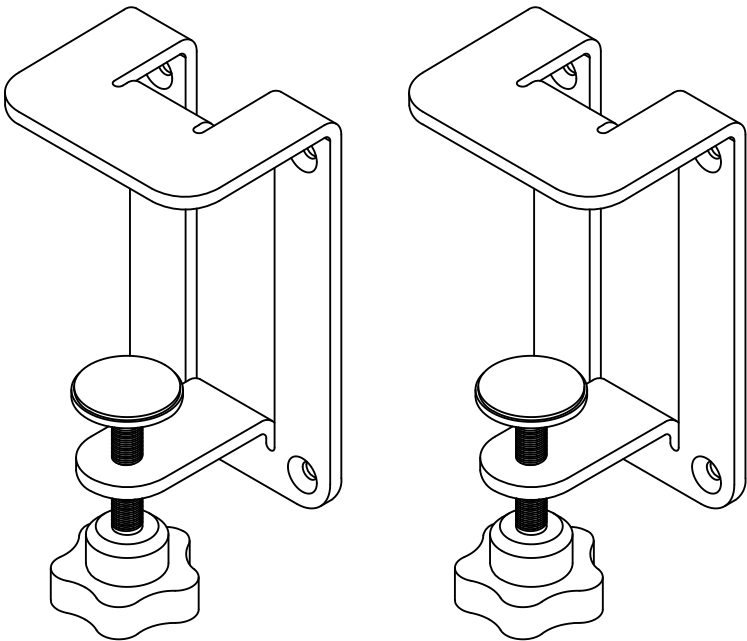

Clamp Mount Bracket with Extra Depth

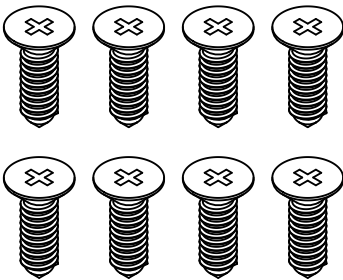

Tapping Screw

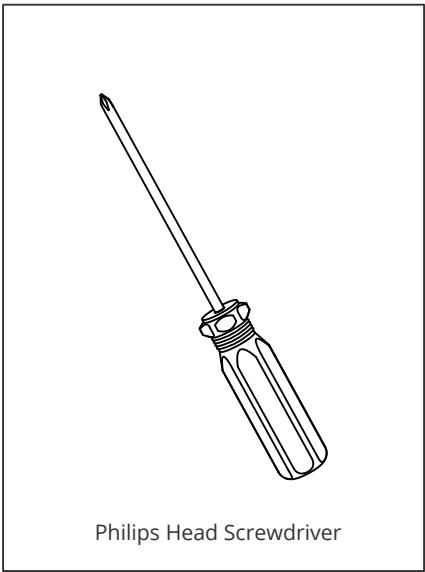

Philips Head Screwdriver

**Step 1:** Position bracket 25% from each side of the PET privacy screen, as shown.

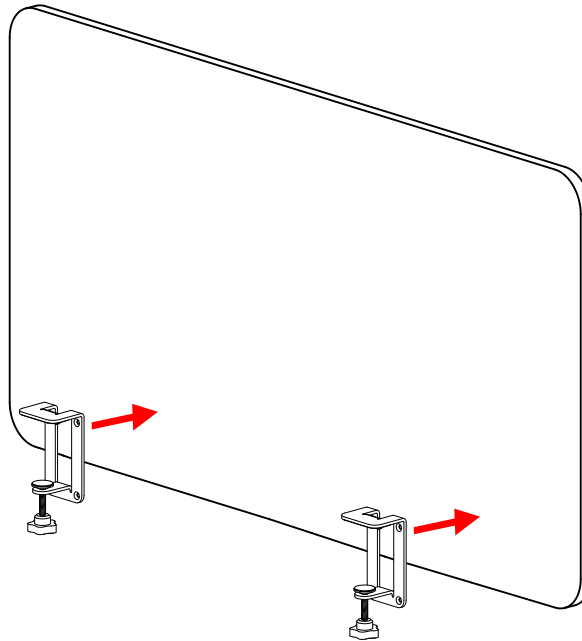

**Placement Suggestion:** 11" and 18": Align brackets at the bottom of screen.  
23": Top of screen to be 11" above surface, 9" below surface  
28": Top of screen to be 18" above surface, 9" below surface

**Step 2:** Fasten bracket to PET privacy screen with tapping screw using screwdriver.

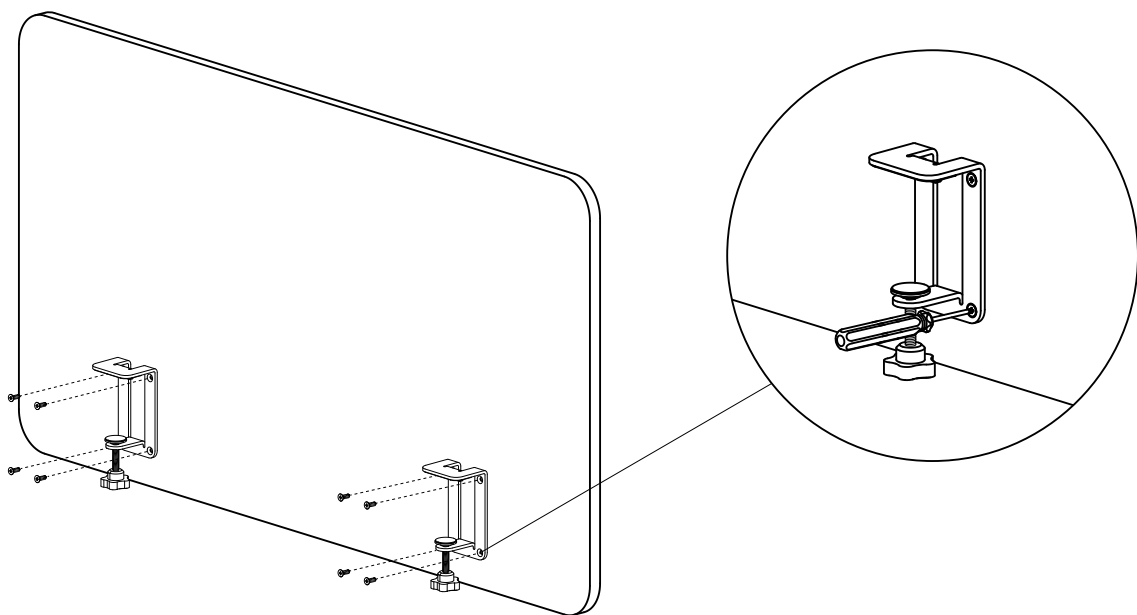

**Step 3:** Position bracket sub-assembly to rear edge of Axis Desk worksurface. Turn the knob to fasten bracket to Axis Desk.

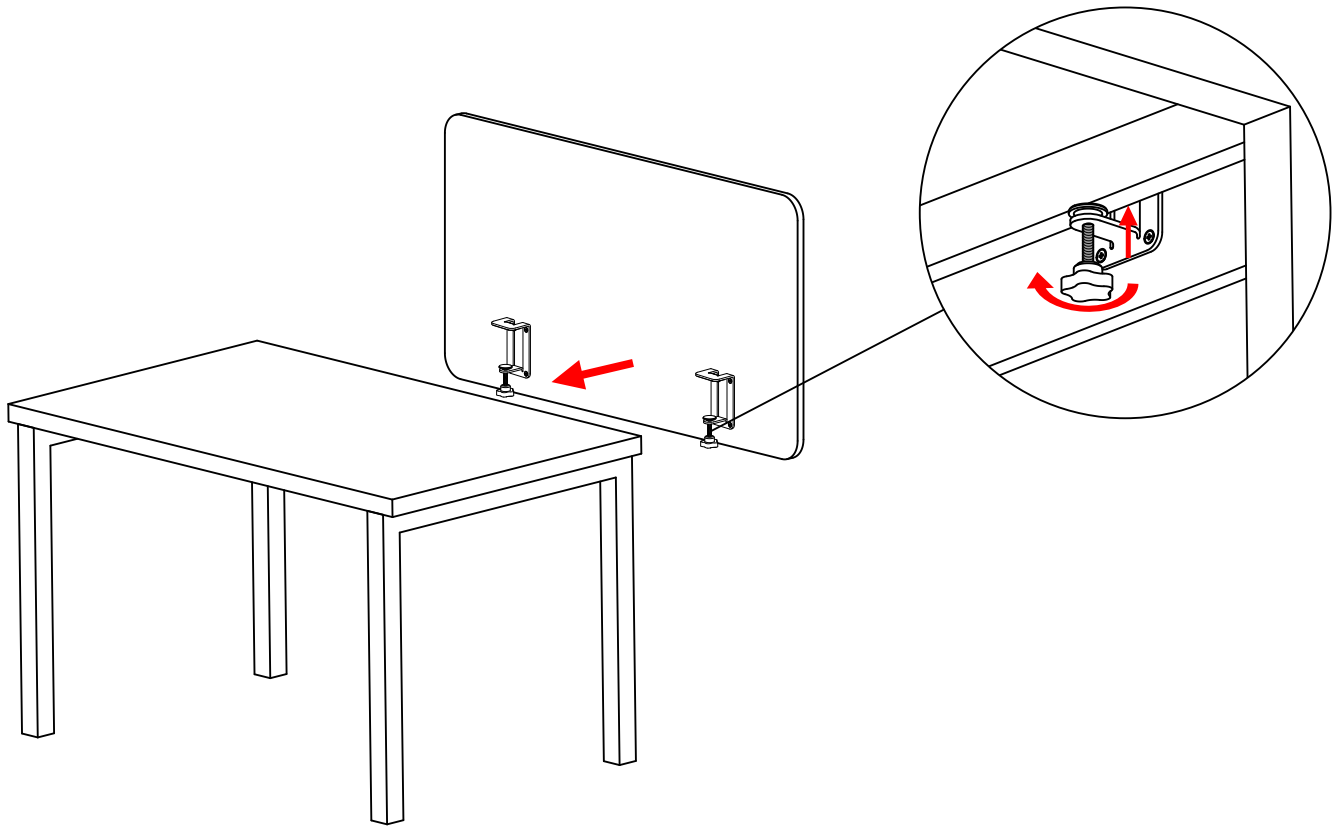

**Step 4:** Complete

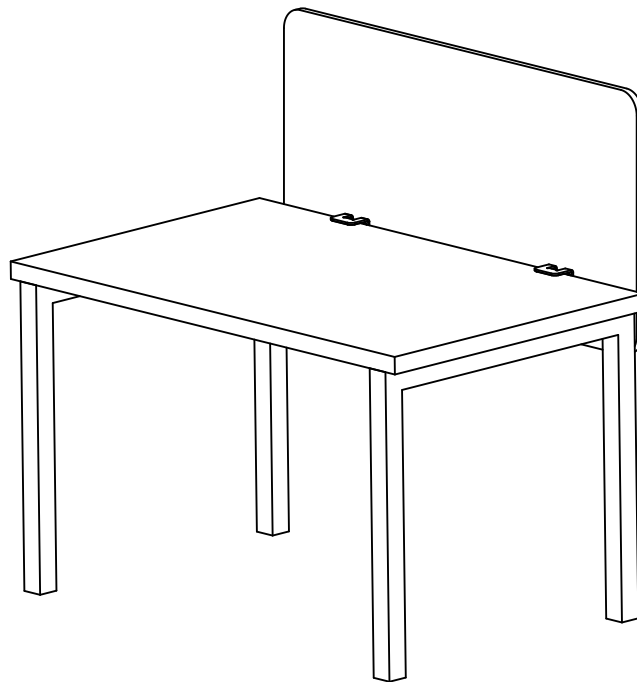

---

## Slip Mount Bracket

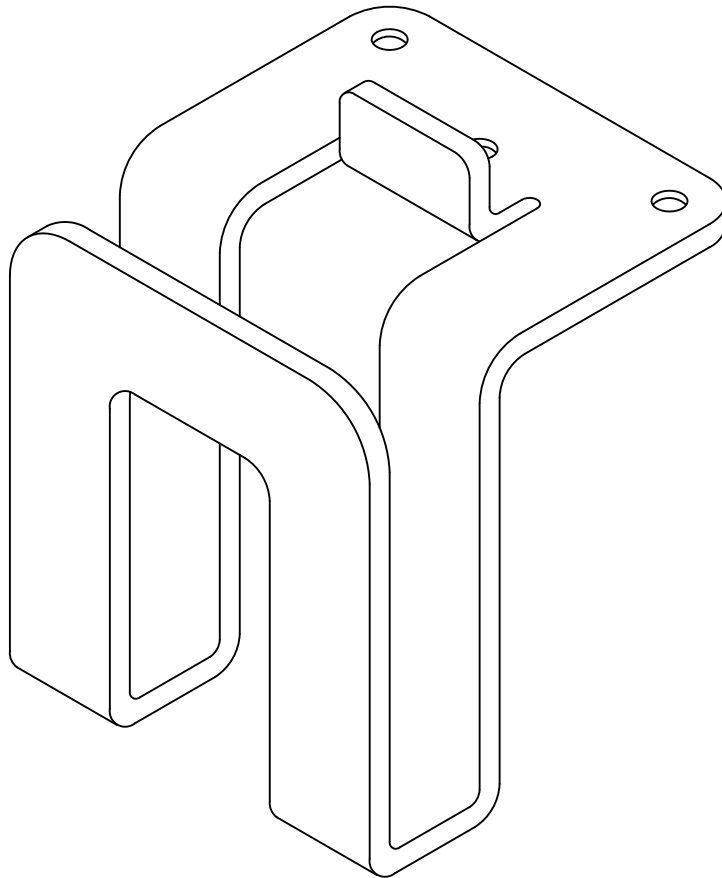

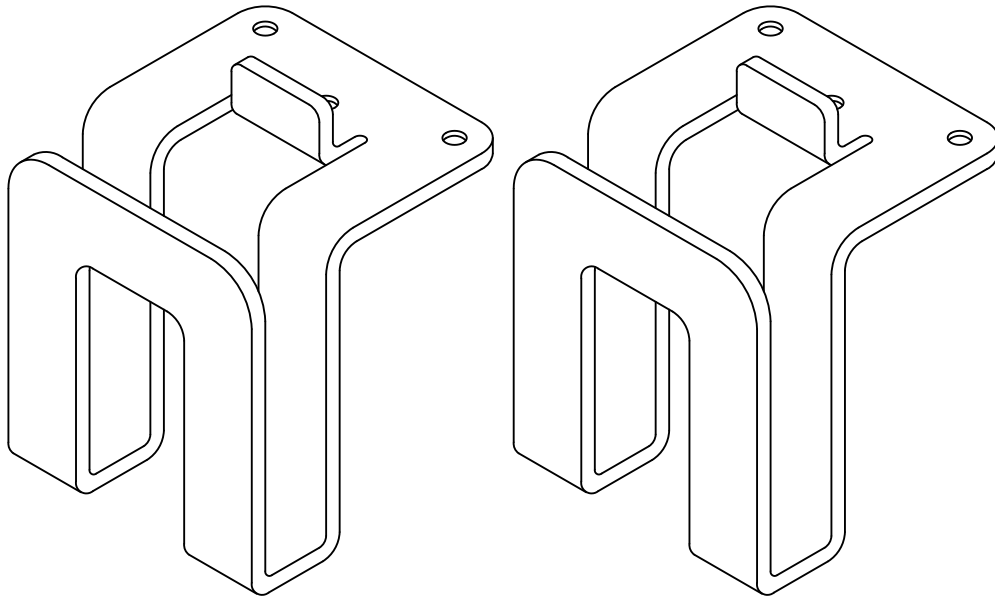

Slip Mount Bracket

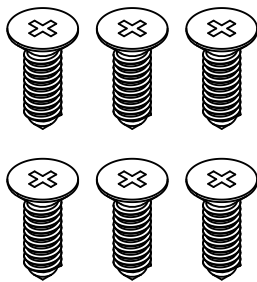

Tapping Screw

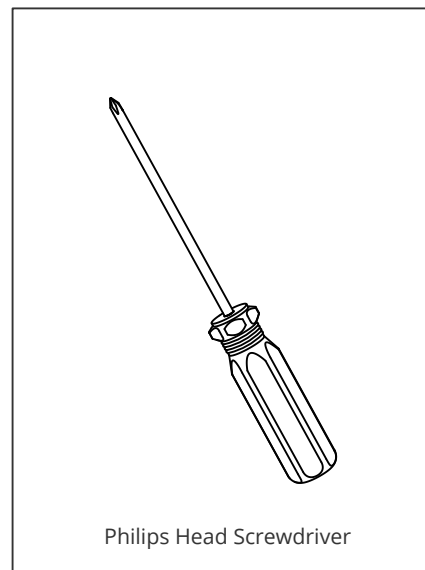

Philips Head Screwdriver

**Step 1:** Position Slip Mount Bracket 25% from each end and to edge of worksurface.  
Make sure the bracket and the bottom of the worksurface are parallel, as shown.

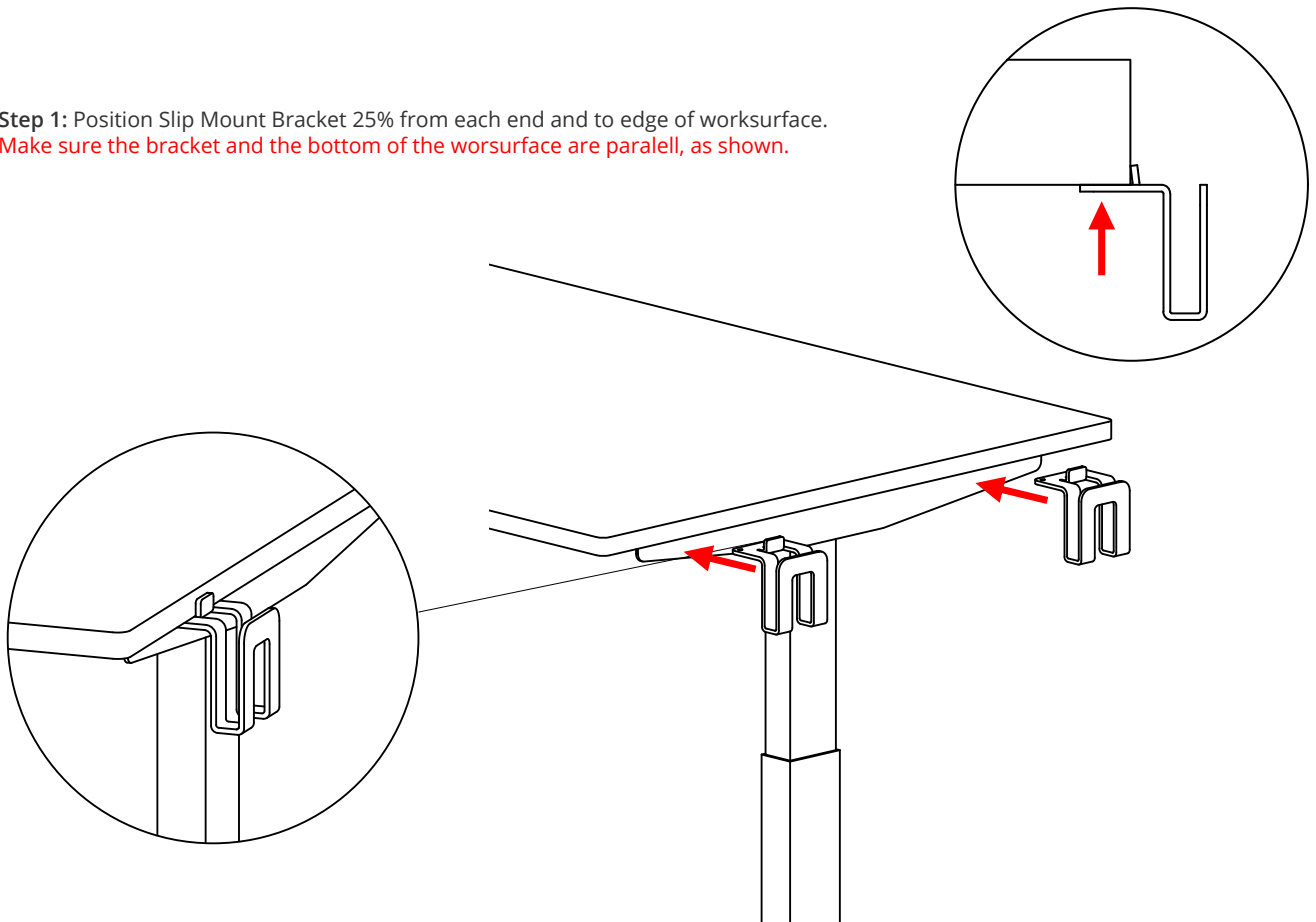

**Step 2:** Fasten Slip Mount Bracket to worksurface with Tapping Screw using screwdriver.

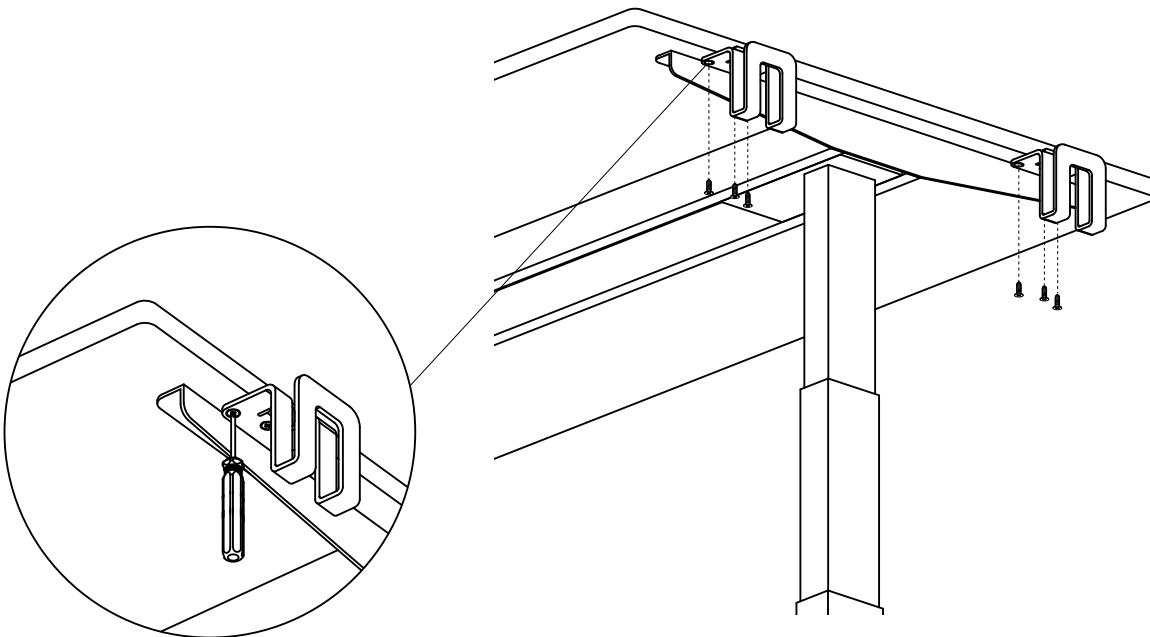



Step 3: Slip in 18mm PET privacy screen

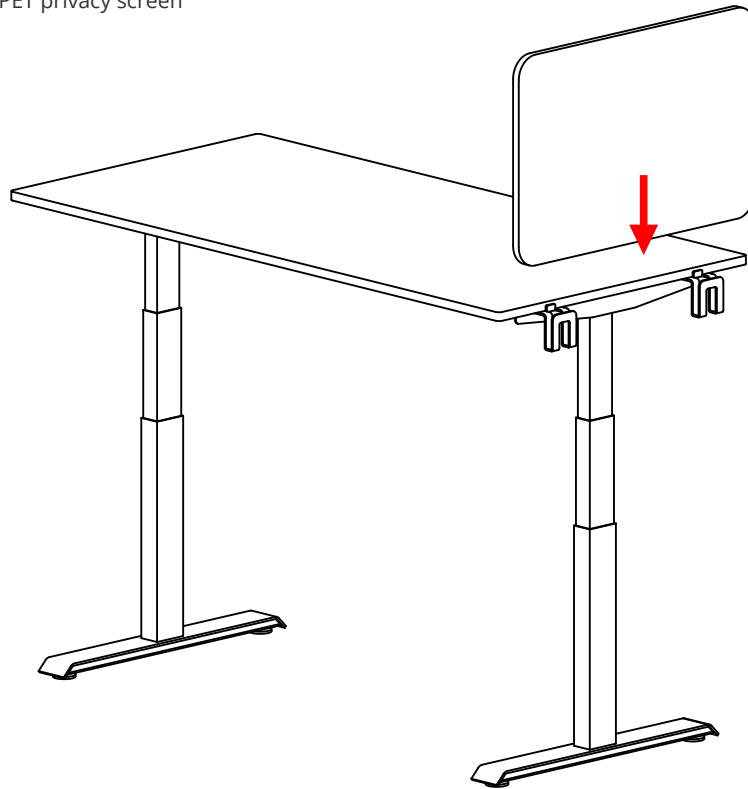

Step 4: Complete

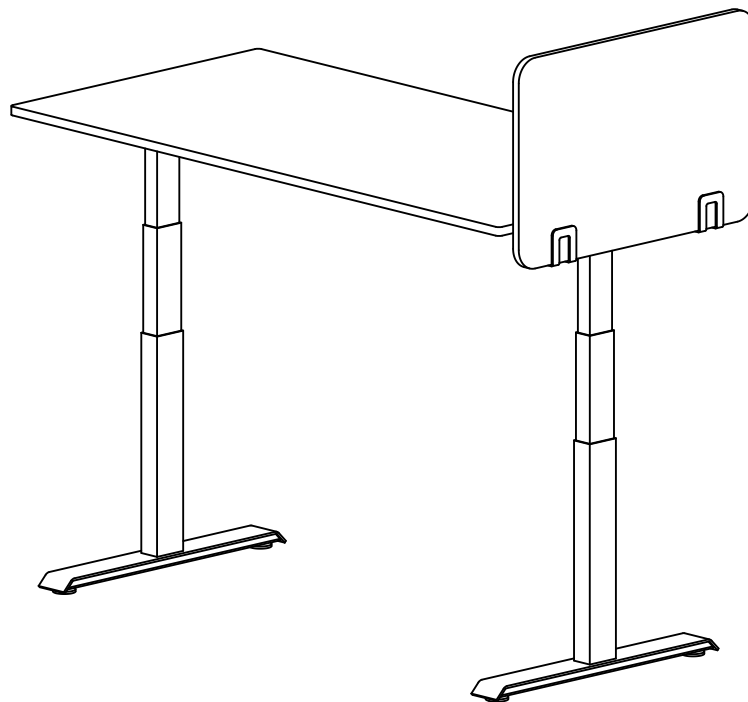

Please contact [info@workspace48.com](mailto:info@workspace48.com) if you are missing any parts, have difficulty with assembly, or have any product-related questions.