

# *Axis Shared desk, Doublesided, with Screens*

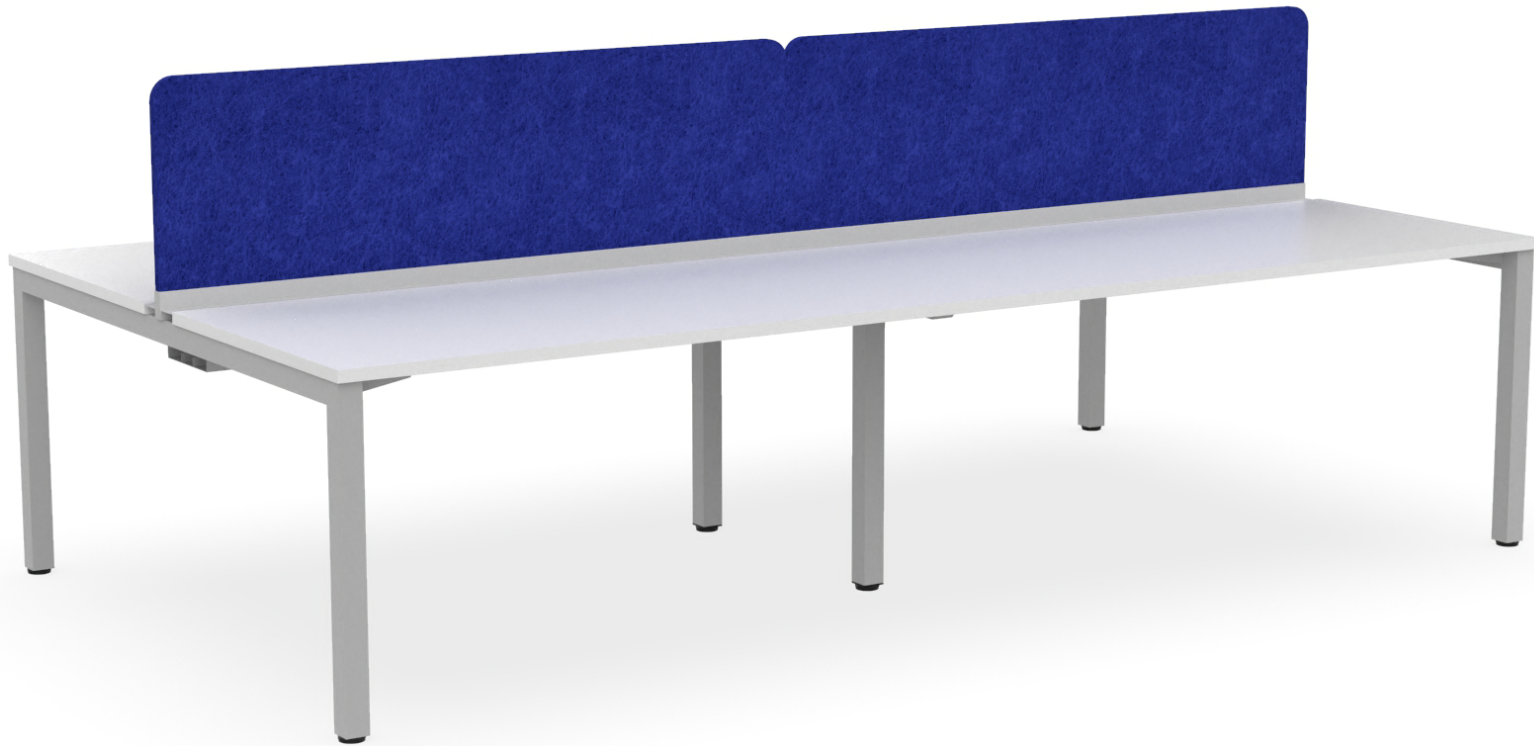

## Installation Guide



# *Axis Shared desk, Doublesided, with Axis Screens*

## Installation Guide

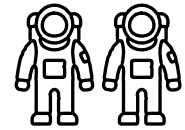

Recommended 2  
persons for install

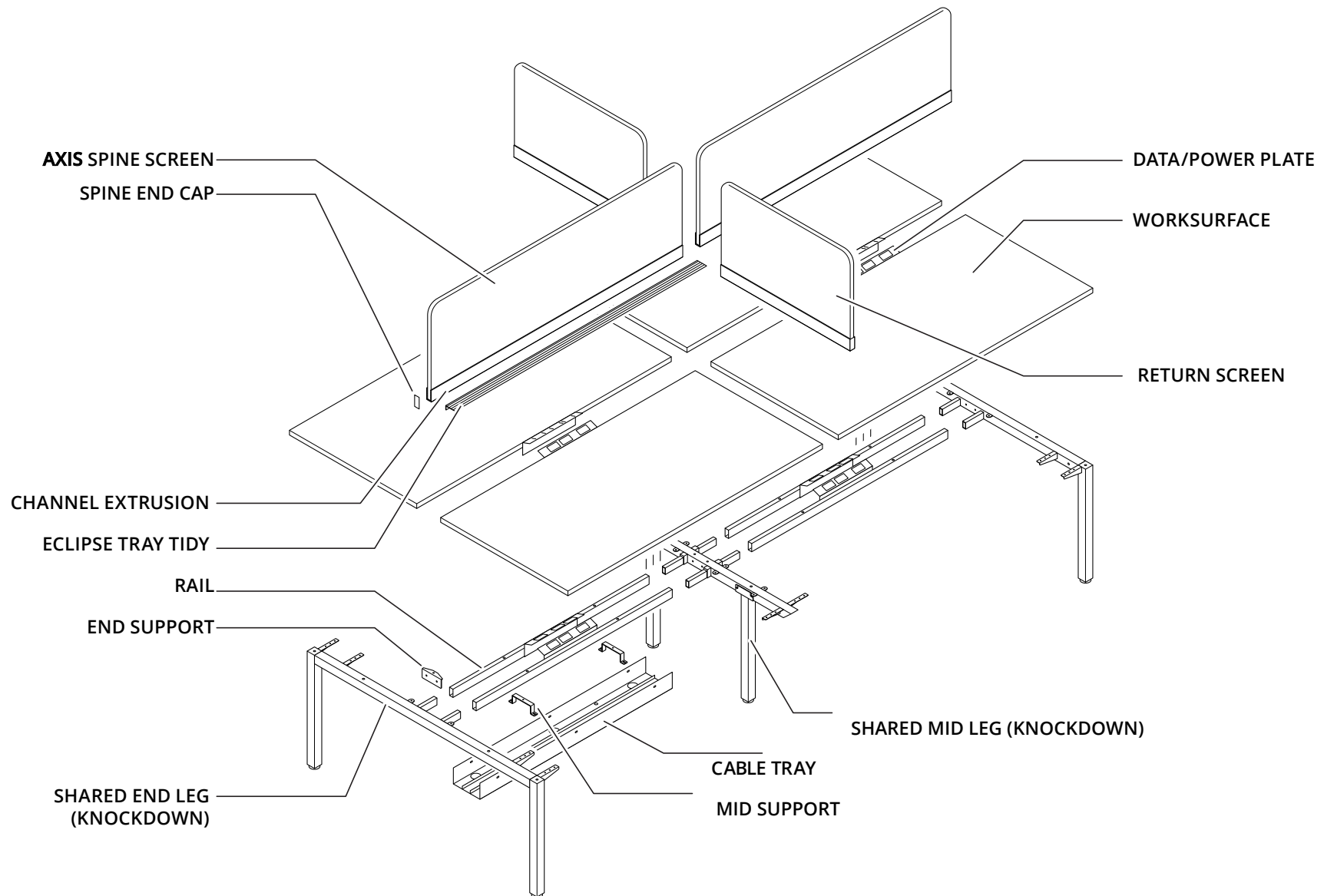

# Axis Shared desk, Doublesided, with Axis Screens

## Installation Guide

48

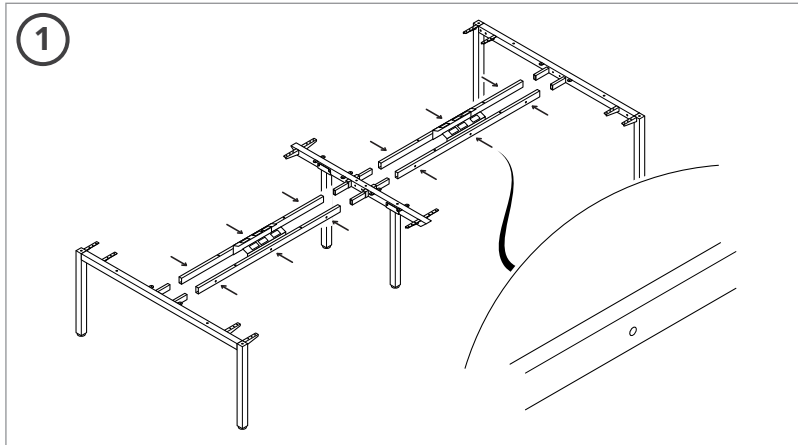

Assemble the frames and rails together. Leave the bolts of the frame loose, one turn from tight. Frame bolts are tightened at step 8. Holes for cable trays on sides of rails must face out to the user.

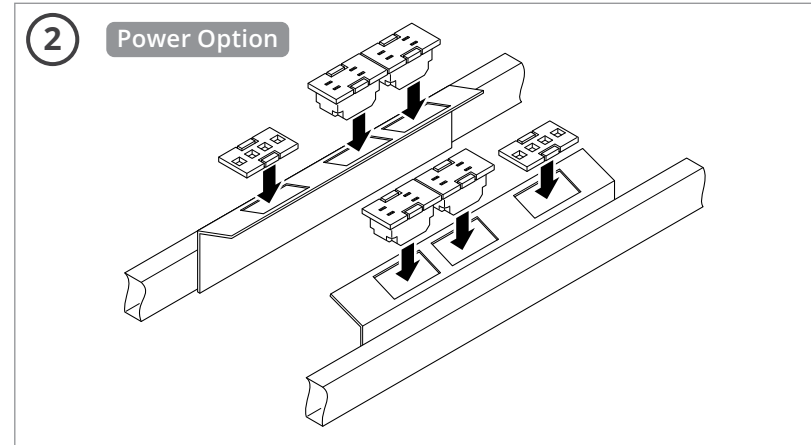

If using our desk power, install the power/data plates, outlets, and wiring. Follow the Electrical Installation Guide provided. Cable trays are installed at step 12.

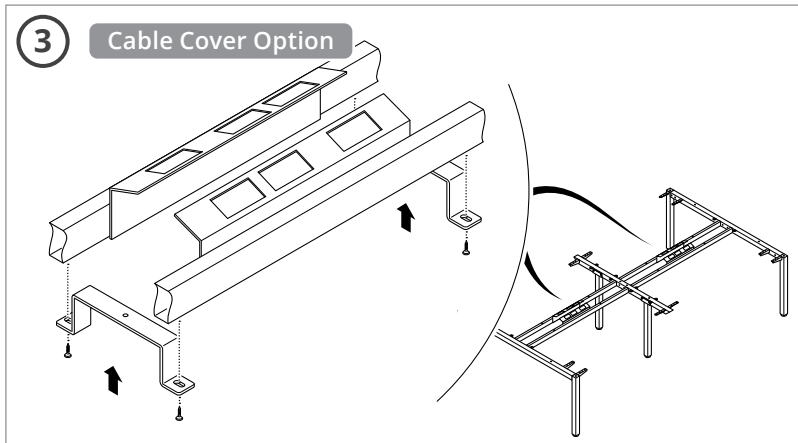

If using our laminate Cable Covers, install the Cable Cover brackets between the facing desks, one on each side of the power/data plate, and one at the end of each frame. Follow the Cable Cover Installation Guide.

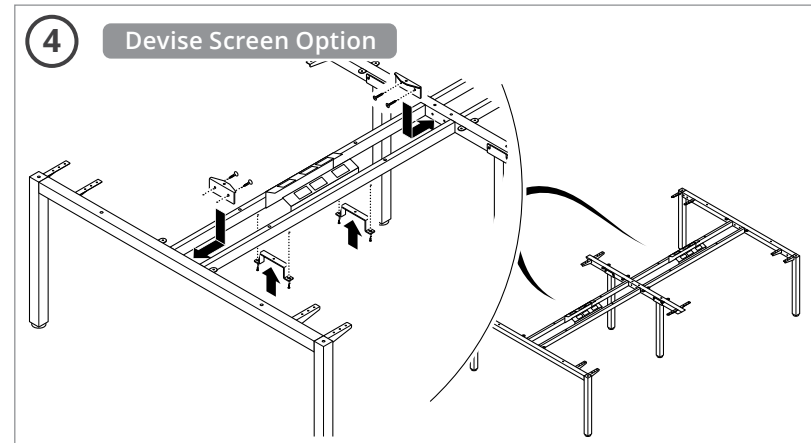

If using our Axis spine screens, install the two end brackets and the two middle supporting brackets between each facing pair of desks. The end brackets fasten to the inside of the leg frame with the single hole facing up. The middle brackets fasten to the threaded holes in the underside of the rail.

# Axis Shared desk, Doublesided, with Axis Screens

## Installation Guide

48

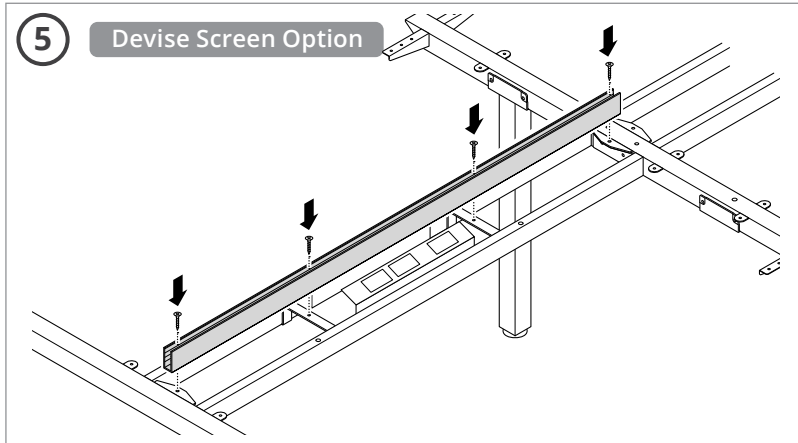

Fasten the screen extrusion to the supporting brackets using the bolts provided. Adjust the screen extrusions along the desks to eliminate gaps between them. Adjust frame to align holes if necessary.

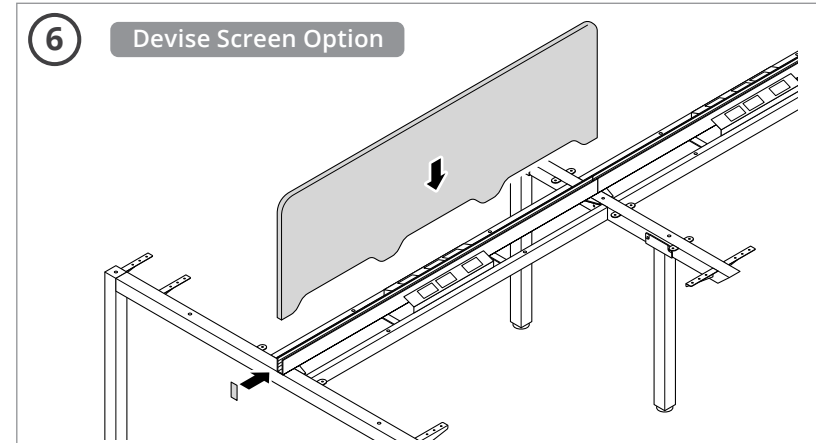

Insert the spine screen fully down into the extrusion, keeping the ends of the screen flush with the end of the extrusion. Take care not to damage the screen while exerting pressure downwards. Fix a spine end cap to each end of the extrusion.

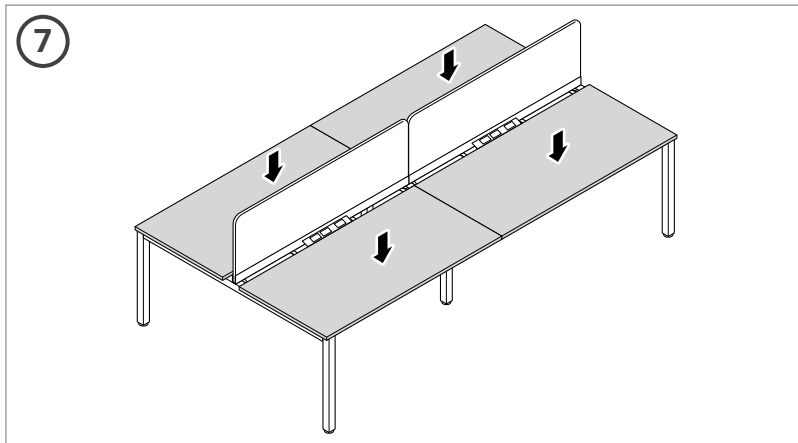

Install the worksurfaces so that they are flush with the back of the frame and/or the power/data plate. Keep the desk overhang equal along the front and sides. If using our laminate Cable Covers, install them now. Follow the Cable Cover Installation Guide.

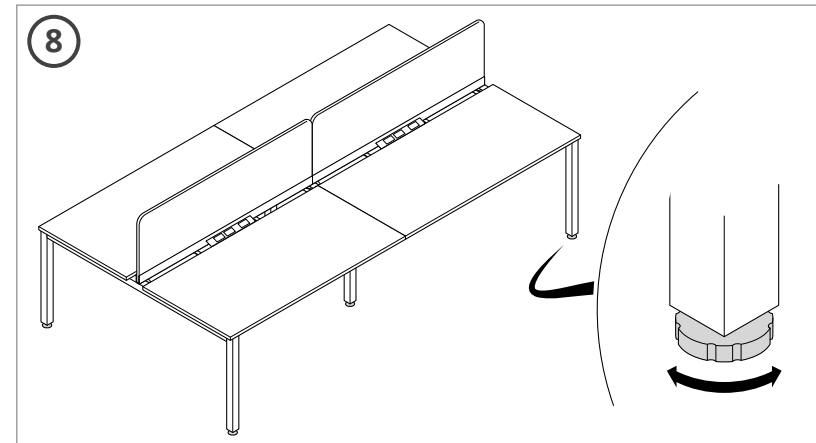

Adjust the feet so the desk pods are level and stable. Fully tighten all rails and frame bolts.

# Axis Shared desk, Doublesided, with Axis Screens

## Installation Guide

48

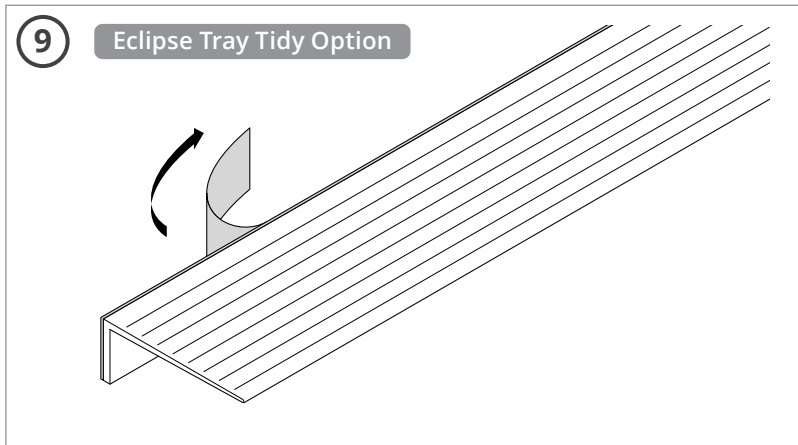

If using our Eclipse Tray Tidy covers, first place the Tray Tidy along the extrusion to check for length and position before exposing the adhesive. The ridged side of the Tray Tidy faces up, with the adhesive side against the extrusion, and the bottom edge resting on the metal frame.

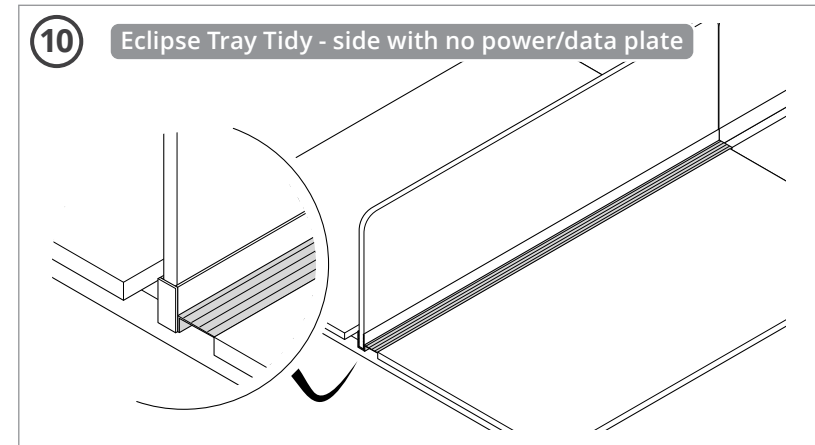

For a side with no power/data plate, use one full length of Tray Tidy. The ends of the Tray Tidy should be flush with each end of the screen extrusion. Peel the backing tape and stick the Tray Tidy to the extrusion.

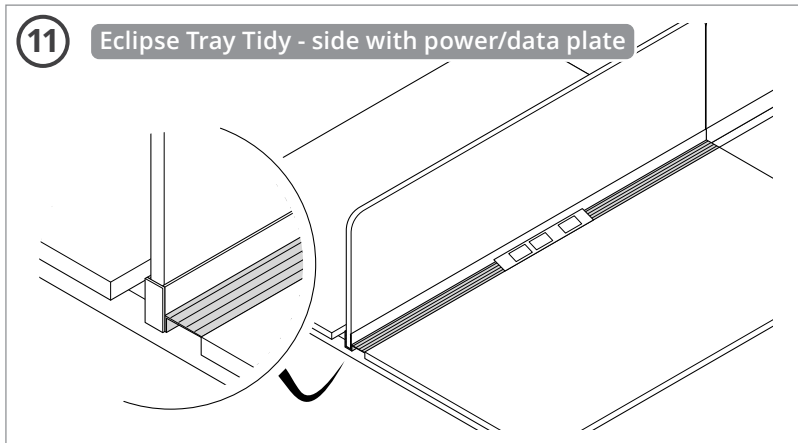

For a side with a power/data plate, use two lengths of Tray Tidy. On each side of the power/data plate, ensure one end of the Tray Tidy is flush with the end of the extrusion, and the other end of the Tray Tidy is behind the power/data plate. Peel the backing tape and stick the Tray Tidy to the extrusion.

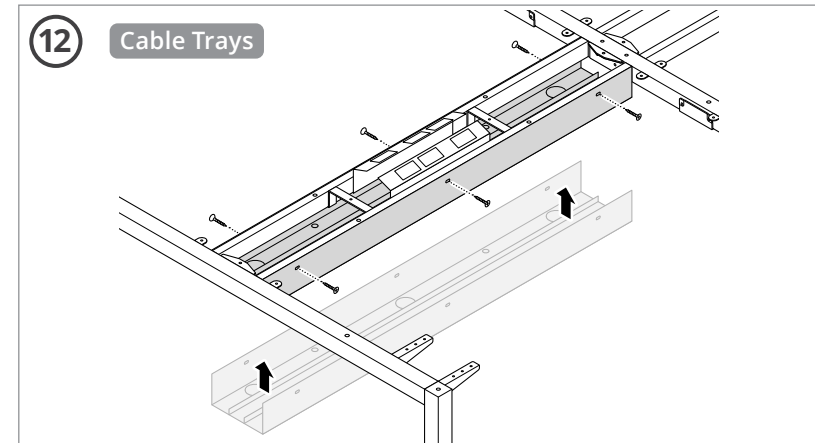

Attach the cable trays to the side of the frame using the bolts provided.

# *Axis Shared desk, Doublesided, with Axis Screens*

## Installation Guide

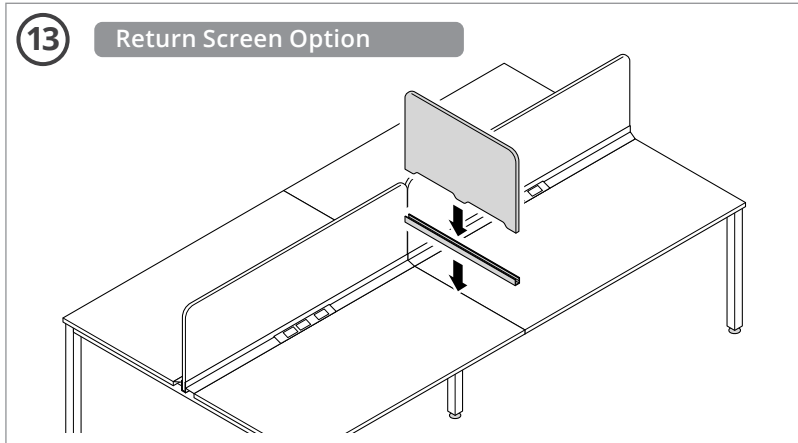

If using our return screens, install them now.