



# *Portfolio*

**WORKSPACE** **48**

**COMPLETE  
PRODUCT  
CATALOG**



# WHY WE ARE CALLED WORKSPACE48

You've probably heard of Elon Musk's space exploration technology company SpaceX, Jeff Beso's Blue Origin space flight service, Richard Brandson's Virgin Galactic space tourist company. All of these visionaries are changing the way we travel to outer space.

At Workspace48, we believe that workspace is the final frontier. We are millennials out to radically change the office furniture industry.

Our mission "TO SHIP EVERY PRODUCT IN OUR CATALOG TO YOU WITHIN 48 HOURS"

To Workspace infinity and beyond!

---



# CONTENTS

6 ANVIL DESKING  
Triangle Leg

---

19 COMSEAL  
Cable Tidy System

---

20 AXIS DESKING  
Square Leg

---

34 AXIS / ANVIL SCREENS

---

36 SCREEN & SOFWIRE ACCESSORIES

---

40 AGILE ELECTRIC HEIGHT ADJUST

---

48 STORAGE & RECEPTIONS  
Suits all Desking Ranges

---

58 MODULUS TABLES  
Boardroom & Meeting

---

76 UNI FLIP TABLES  
Welded Foot

---

80 SEATING  
Executive, Task, Visitor, Soft Seating

---

116 CASE STUDIES



# ANVIL DESKING

Anvil frame systems give your office spaces a refreshing image that will encourage freedom of thought and inspired decision making.

---



Anvil Desking with Balance Seating, Axis Caddies and Tambours





## ACTION STATIONS

Whether you need individual offices for concentrated work or team based work areas to enhance interaction, ANVIL workstations are a superb collection of desk and workstation elements. There is no reason why your office furniture should not be as architecturally appealing as your offices – ANVIL is a statement in style.





## HIGH DENSITY DESKING

ANVIL is an intelligent approach to office system design. The modular structure of ANVIL guarantees adaptable layouts and solutions that support a multitude of ways of working, while providing concealed routing of services.



# PRECISION DESIGN

Great office environments are shaped by clean furniture design. ANVIL gives you a framework that will support dynamic changes in workplace technologies and evolving work practices.



## Anvil Straightline

### Standard features

- 2.0" x 2.0" x 2.0" triangle end frames with flush ground weld finish
- 2.0" x 1.0" rails
- Worksurfaces are Studio White melamine on E1 grade substrate with matching SPVC edge
- Arctic White powdercoat to all steel components.

### Standard worktop sizes

- 47.2" w x 23.6" d x 28.2" h
- 47.2" w x 29.5" d x 28.2" h
- 59.1" w x 23.6" d x 28.2" h
- 59.1" w x 29.5" d x 28.2" h
- 70.9" w x 23.6" d x 28.2" h
- 70.9" w x 29.5" d x 28.2" h



## Anvil 120 Degree

### Standard features

- 2.0" x 2.0" x 2.0" triangle end frames with flush ground weld finish
- 2.0" x 1.0" rails
- Worksurfaces are Studio White melamine on E1 grade substrate with matching SPVC edge
- Arctic White powdercoat to all steel components.

### Standard worktop sizes

- 47.2" x 47.2" w x 23.6" d x 28.2" h



## Straightline Singles

### Standard features

- 2.0" x 2.0" x 2.0" triangle end frames with flush ground weld finish
- 2.0" x 1.0" rails
- Worksurfaces are Studio White melamine on E1 grade substrate with matching SPVC edge
- Arctic White powdercoat to all steel components.

### Options

- Clampon screens
- Cable management & data rails
- Modesty panels.



## Straightline Two Sided

### Standard features

- 2.0" x 2.0" x 2.0" triangle end frames with flush ground weld finish
- 2.0" x 1.0" rails
- Worksurfaces are Studio White melamine on E1 grade substrate with matching SPVC edge
- Arctic White powdercoat to all steel components
- Central deskmounted screens
- Concealed cable management
- Power & data rails.



## 120 Degree Singles

### Standard features

- 2.0" x 2.0" x 2.0" triangle end frames with flush ground weld finish
- 2.0" x 1.0" rails
- Worksurfaces are Studio White melamine on E1 grade substrate with matching SPVC edge
- Arctic White powdercoat to all steel components.

### Options

- Clampon screens
- Cable management & data rails
- Modesty panels.



## 120 Degree Three Cluster

### Standard features

- 2.0" x 2.0" x 2.0" triangle end frames with flush ground weld finish
- 2.0" x 1.0" rails
- Worksurfaces are Studio White melamine on E1 grade substrate with matching SPVC edge
- Arctic White powdercoat to all steel components
- Central deskmounted screens
- Concealed cable management
- Power & data rails.



## Straightline Single Sided Double

### Standard features

- 2.0" x 2.0" x 2.0" triangle end frames with flush ground weld finish
- 2.0" x 1.0" rails
- Worksurfaces are Studio White melamine on E1 grade substrate with matching SPVC edge
- Arctic White powdercoat to all steel components.

### Options

- Clampon screens
- Cable management & data rails
- Modesty panels.



## Straightline Two Sided Double

### Standard features

- 2.0" x 2.0" x 2.0" triangle end frames with flush ground weld finish
- 2.0" x 1.0" rails
- Worksurfaces are Studio White melamine on E1 grade substrate with matching SPVC edge
- Arctic White powdercoat to all steel components
- Central deskmounted screens
- Concealed cable management
- Power & data rails.



## 120 Degree 2/3

### Standard features

- 2.0" x 2.0" x 2.0" triangle end frames with flush ground weld finish
- 2.0" x 1.0" rails
- Worksurfaces are Studio White melamine on E1 grade substrate with matching SPVC edge
- Arctic White powdercoat to all steel components
- Central deskmounted screens
- Concealed cable management
- Power & data rails.



## 120 Degree Six Cluster

### Standard features

- 2.0" x 2.0" x 2.0" triangle end frames with flush ground weld finish
- 2.0" x 1.0" rails
- Worksurfaces are Studio White melamine on E1 grade substrate with matching SPVC edge
- Arctic White powdercoat to all steel components
- Central deskmounted screens
- Concealed cable management
- Power & data rails.



## Straightline Single Sided Triple

### Standard features

- 2.0" x 2.0" x 2.0" triangle end frames with flush ground weld finish
- 2.0" x 1.0" rails
- Worksurfaces are Studio White melamine on E1 grade substrate with matching SPVC edge
- Arctic White powdercoat to all steel components.

### Options

- Clampon screens
- Cable management & data rails
- Modesty panels.



## Straightline Two Sided Triple

### Standard features

- 2.0" x 2.0" x 2.0" triangle end frames with flush ground weld finish
- 2.0" x 1.0" rails
- Worksurfaces are Studio White melamine on E1 grade substrate with matching SPVC edge
- Arctic White powdercoat to all steel components
- Central deskmounted screens
- Concealed cable management
- Power & data rails.



## Anvil 120 Degree Suggested Layout





## Anvil 90 Degree

### Standard features

- 2.0" x 2.0" x 2.0" triangle end frames with flush ground weld finish
- 2.0" x 1.0" rails
- Worksurfaces are Studio White melamine on E1 grade substrate with matching SPVC edge
- Arctic White powdercoat to all steel components.

### Options

- Clampon screens
- Cable management & data rails
- Modesty panels.

### Standard worktop sizes

- 70.9" x 70.9"w x 29.5"d x 28.2"h
- 70.9" x 70.9"w x 23.6"d x 28.2"h



## Anvil 90 Degree Plus Cluster Six

### Standard features

- 2.0" x 2.0" x 2.0" triangle end frames with flush ground weld finish
- 2.0" x 1.0" rails
- Worksurfaces are Studio White melamine on E1 grade substrate with matching SPVC edge
- Arctic White powdercoat to all steel components
- Central deskmounted screens
- Concealed cable management
- Power & data rails.



## Anvil 90 Degree Single

### Standard features

- 2.0" x 2.0" x 2.0" triangle end frames with flush ground weld finish
- 2.0" x 1.0" rails
- Worksurfaces are Studio White melamine on E1 grade substrate with matching SPVC edge
- Arctic White powdercoat to all steel components.

### Options

- Clampon screens
- Cable management & data rails
- Modesty panels.



## Anvil 90 Degree Tee Cluster Two

### Standard features

- 2.0" x 2.0" x 2.0" triangle end frames with flush ground weld finish
- 2.0" x 1.0" rails
- Worksurfaces are Studio White melamine on E1 grade substrate with matching SPVC edge
- Arctic White powdercoat to all steel components
- Central deskmounted screens
- Concealed cable management
- Power & data rails.



## Anvil 90 Degree Plus Cluster Eight

### Standard features

- 2.0" x 2.0" x 2.0" triangle end frames with flush ground weld finish
- 2.0" x 1.0" rails
- Worksurfaces are Studio White melamine on E1 grade substrate with matching SPVC edge
- Arctic White powdercoat to all steel components
- Central deskmounted screens
- Concealed cable management
- Power & data rails.



## Anvil 90 Degree H Cluster Four

### Standard features

- 2.0" x 2.0" x 2.0" triangle end frames with flush ground weld finish
- 2.0" x 1.0" rails
- Worksurfaces are Studio White melamine on E1 grade substrate with matching SPVC edge
- Arctic White powdercoat to all steel components
- Central deskmounted screens
- Concealed cable management
- Power & data rails.



## Anvil 90 Degree Plus Cluster Four

### Standard features

- 2.0" x 2.0" x 2.0" triangle end frames with flush ground weld finish
- 2.0" x 1.0" rails
- Worksurfaces are Studio White melamine on E1 grade substrate with matching SPVC edge
- Arctic White powdercoat to all steel components
- Central deskmounted screens
- Concealed cable management
- Power & data rails.



## Anvil 90 Degree H Cluster Eight

### Standard features

- 2.0" x 2.0" x 2.0" triangle end frames with flush ground weld finish
- 2.0" x 1.0" mm rails
- Worksurfaces are Studio White melamine on E1 grade substrate with matching SPVC edge
- Arctic White powdercoat to all steel components
- Central deskmounted screens
- Concealed cable management
- Power & data rails.



## Anvil 90 Degree Suggested Layouts



# COMSEAL CABLE TIDY SYSTEM

SIMPLY EFFICIENT

An efficient way of achieving concealed & practical routing of services. Comseal allows you to plug in at the desktop & still retain the ability to conceal all your power & data cables.

Shown with ANVIL 90° cluster.



Comseal shown with ANVIL straightline desk & offset screen.



Comseal shown with ANVIL 120° setting.

Works with clamp on shelves & monitor arms.



Plug in at the desktop.

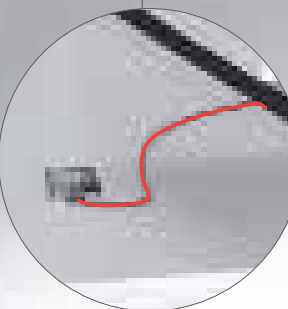
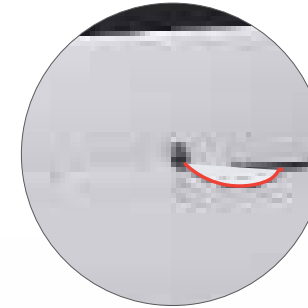

Hide your cables all the way to where you need them.



# AXIS DESKING

AXIS office environments create a sense of community & space and support dynamic changes in workplace technologies while evolving work practices.





# AXIS STRAIGHTLINE

Axis long shared desk combinations are well complimented by matching storage & meeting tables. Freeway chairs with coloured fabric seat covers & fabric seat toppas on the mobiles, help you make the space really yours.







## 90 DEGREE

Axis System gives refreshing options for traditional 90° office layouts. Design your space using a combination of frame-mounted screens between worktops &  $\frac{3}{4}$  height screens to the traffic areas while retaining the Axis worktop accessible power and data functions.

## 120 DEGREE

Axis 120° layouts are ideal for team environments. Screens can be pinnable e-panel or translucent twinwall, or a combination of both. The Axis 120° frames interlock with the straightline & 90° Modulus giving unlimited layout options.





# COLLABORATION

Axis Tables fit into any meeting area needing practical strong workspaces to facilitate robust discussion & decision making. Freeway seating options compliment the tables to provide varied meeting spaces with flair & panache.





## Axis Straightline

### Standard features

- 2.0" x 2.0" end frames with flush ground weld finish
- 2.0" x 1.0" rails
- 3.1" height adjustment in each foot
- Worksurfaces are Studio White melamine on E1 grade substrate with matching SPVC edge
- Arctic White powdercoat to all steel components.

### Standard worktop sizes

47.2" w x 23.6" d x 28.1" h	59.1" w x 29.5" d x 28.1" h
47.2" w x 29.5" d x 28.1" h	70.9" w x 23.6" d x 28.1" h
59.1" w x 23.6" d x 28.1" h	70.9" w x 29.5" d x 28.1" h



## Axis 120 Degree

### Standard features

- 2.0" x 2.0" end frames with flush ground weld finish
- 2.0" x 1.0" rails
- 3.1" height adjustment in each foot
- Worksurfaces are Studio White melamine on E1 grade substrate with matching SPVC edge
- Arctic White powdercoat to all steel components.

### Standard worktop sizes

47.2" x 47.2" w x 23.6" d x 28.2" h



## Straightline Singles

### Standard features

- 2.0" x 2.0" end frames with flush ground weld finish
- 2.0" x 1.0" rails
- 3.1" height adjustment in each foot
- Worksurfaces are Studio White melamine on E1 grade substrate with matching SPVC edge
- Arctic White powdercoat to all steel components.

### Options

- Clampon screens
- Cable management & data rails
- Modesty panels.



## Straightline Two Sided

### Standard features

- 2.0" x 2.0" end frames with flush ground weld finish
- 2.0" x 1.0" rails
- 3.1" height adjustment in each foot
- Worksurfaces are Studio White melamine on E1 grade substrate with matching SPVC edge
- Arctic White powdercoat to all steel components
- Central deskmounted screens
- Concealed cable management
- Power & data rails.



## 120 Degree Singles

### Standard features

- 2.0" x 2.0" end frames with flush ground weld finish
- 2.0" x 1.0" rails
- 3.1" height adjustment in each foot
- Worksurfaces are Studio White melamine on E1 grade substrate with matching SPVC edge
- Arctic White powdercoat to all steel components.

### Options

- Clampon screens
- Cable management & data rails
- Modesty panels.



## 120 Degree Three Cluster

### Standard features

- 2.0" x 2.0" end frames with flush ground weld finish
- 2.0" x 1.0" rails
- 3.1" height adjustment in each foot
- Worksurfaces are Studio White melamine on E1 grade substrate with matching SPVC edge
- Arctic White powdercoat to all steel components
- Central deskmounted screens
- Concealed cable management
- Power & data rails.



## Straightline Single Sided Double

### Standard features

- 2.0" x 2.0" end frames with flush ground weld finish
- 2.0" x 1.0" rails
- 3.1" height adjustment in each foot
- Worksurfaces are Studio White melamine on E1 grade substrate with matching SPVC edge
- Arctic White powdercoat to all steel components.

### Options

- Clampon screens
- Cable management & data rails
- Modesty panels.



## Straightline Two Sided Double

### Standard features

- 2.0" x 2.0" end frames with flush ground weld finish
- 2.0" x 1.0" rails
- 3.1" height adjustment in each foot
- Worksurfaces are Studio White melamine on E1 grade substrate with matching SPVC edge
- Arctic White powdercoat to all steel components
- Central deskmounted screens
- Concealed cable management
- Power & data rails.



## 120 Degree 2/3

### Standard features

- 2.0" x 2.0" end frames with flush ground weld finish
- 2.0" x 1.0" rails
- 3.1" height adjustment in each foot
- Worksurfaces are Studio White melamine on E1 grade substrate with matching SPVC edge
- Arctic White powdercoat to all steel components
- Central deskmounted screens
- Concealed cable management
- Power & data rails.



## 120 Degree Six Cluster

### Standard features

- 2.0" x 2.0" end frames with flush ground weld finish
- 2.0" x 1.0" rails
- 3.1" height adjustment in each foot
- Worksurfaces are Studio White melamine on E1 grade substrate with matching SPVC edge
- Arctic White powdercoat to all steel components
- Central deskmounted screens
- Concealed cable management
- Power & data rails.



## Straightline Single Sided Triple

### Standard features

- 2.0" x 2.0" end frames with flush ground weld finish
- 2.0" x 1.0" rails
- 3.1" height adjustment in each foot
- Worksurfaces are Studio White melamine on E1 grade substrate with matching SPVC edge
- Arctic White powdercoat to all steel components.

### Options

- Clampon screens
- Cable management & data rails
- Modesty panels.



## Straightline Two Sided Triple

### Standard features

- 2.0" x 2.0" end frames with flush ground weld finish
- 2.0" x 1.0" rails
- 3.1" height adjustment in each foot
- Worksurfaces are Studio White melamine on E1 grade substrate with matching SPVC edge
- Arctic White powdercoat to all steel components
- Central deskmounted screens
- Concealed cable management
- Power & data rails.



## Axis 120 Degree Suggested Layout





## Axis 90 Degree

### Standard features

- 2.0" x 2.0" end frames with flush ground weld finish
- 2.0" x 1.0" rails
- 3.1" height adjustment in each foot
- Worksurfaces are Studio White melamine on E1 grade substrate with matching SPVC edge
- Arctic White powdercoat to all steel components.

### Options

- Clampon screens
- Cable management & data rails
- Modesty panels.

### Standard worktop sizes

70.9" x 70.9" w x 29.5" d x 28.2" h

70.9" x 70.9" w x 23.6" d x 28.2" h



## Axis 90 Degree Plus Cluster Six

### Standard features

- 2.0" x 2.0" end frames with flush ground weld finish
- 2.0" x 1.0" rails
- 3.1" height adjustment in each foot
- Worksurfaces are Studio White melamine on E1 grade substrate with matching SPVC edge
- Arctic White powdercoat to all steel components
- Central deskmounted screens
- Concealed cable management
- Power & data rails.



## Axis 90 Degree Single

### Standard features

- 2.0" x 2.0" end frames with flush ground weld finish
- 2.0" x 1.0" rails
- 3.1" height adjustment in each foot
- Worksurfaces are Studio White melamine on E1 grade substrate with matching SPVC edge
- Arctic White powdercoat to all steel components.

### Options

- Clampon screens
- Cable management & data rails
- Modesty panels.



## Axis 90 Degree Tee Cluster Two

### Standard features

- 2.0" x 2.0" end frames with flush ground weld finish
- 2.0" x 1.0" rails
- 3.1" height adjustment in each foot
- Worksurfaces are Studio White melamine on E1 grade substrate with matching SPVC edge
- Arctic White powdercoat to all steel components
- Central deskmounted screens
- Concealed cable management
- Power & data rails.



## Axis 90 Degree Plus Cluster Eight

### Standard features

- 2.0" x 2.0" end frames with flush ground weld finish
- 2.0" x 1.0" rails
- 3.1" height adjustment in each foot
- Worksurfaces are Studio White melamine on E1 grade substrate with matching SPVC edge
- Arctic White powdercoat to all steel components
- Central deskmounted screens
- Concealed cable management
- Power & data rails.



## Axis 90 Degree H Cluster Four

### Standard features

- 2.0" x 2.0" end frames with flush ground weld finish
- 2.0" x 1.0" rails
- 3.1" height adjustment in each foot
- Worksurfaces are Studio White melamine on E1 grade substrate with matching SPVC edge
- Arctic White powdercoat to all steel components
- Central deskmounted screens
- Concealed cable management
- Power & data rails.



## Axis 90 Degree Plus Cluster Four

### Standard features

- 2.0" x 2.0" end frames with flush ground weld finish
- 2.0" x 1.0" rails
- 3.1" height adjustment in each foot
- Worksurfaces are Studio White melamine on E1 grade substrate with matching SPVC edge
- Arctic White powdercoat to all steel components
- Central deskmounted screens
- Concealed cable management
- Power & data rails.



## Axis 90 Degree H Cluster Eight

### Standard features

- 2.0" x 2.0" end frames with flush ground weld finish
- 2.0" x 1.0" rails
- 3.1" height adjustment in each foot
- Worksurfaces are Studio White melamine on E1 grade substrate with matching SPVC edge
- Arctic White powdercoat to all steel components
- Central deskmounted screens
- Concealed cable management
- Power & data rails.



## Axis 90 Degree Suggested Layouts



# Anvil System Size Guide

## Single Desks

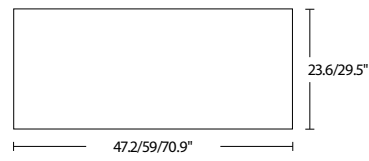

## Single Workstations

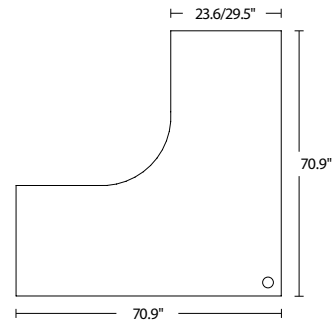

## 90 Degree Workstations

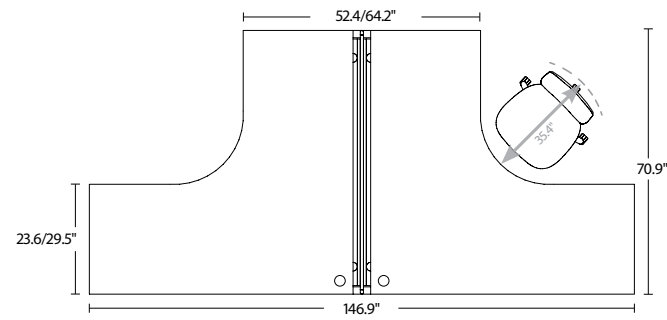

## 120 Degree Workstations

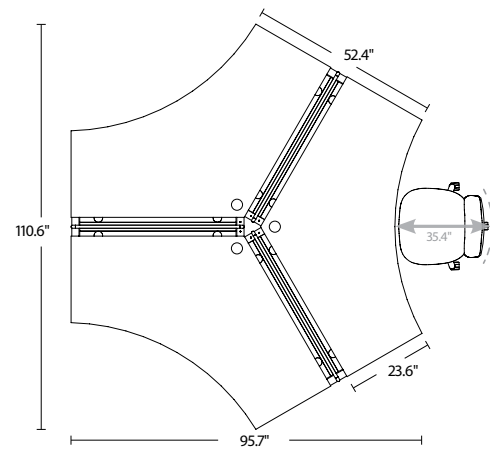

# Axis System Size Guide

## Single Desks

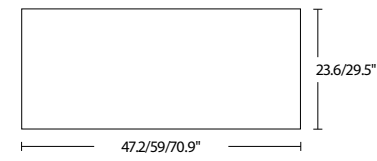

## Single Workstations

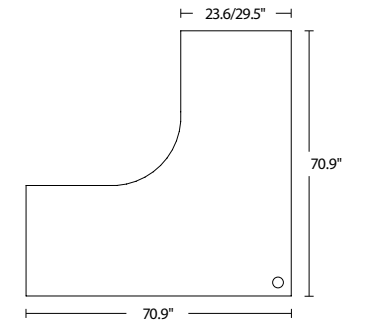

## 90 Degree Workstations

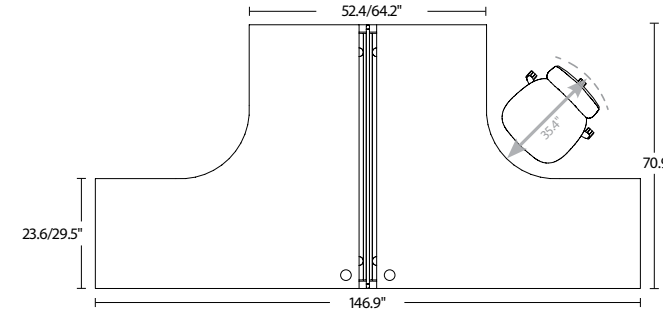

## 120 Degree Workstations

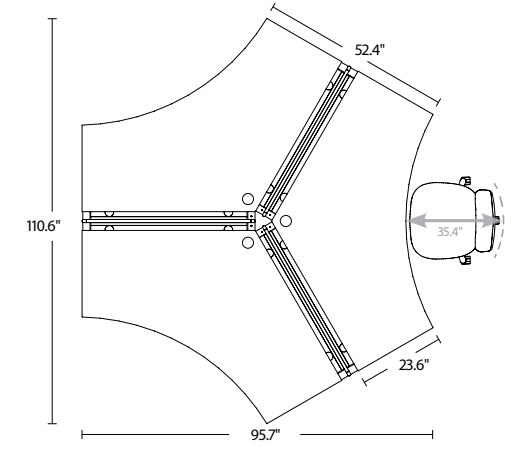

## Shared Desks

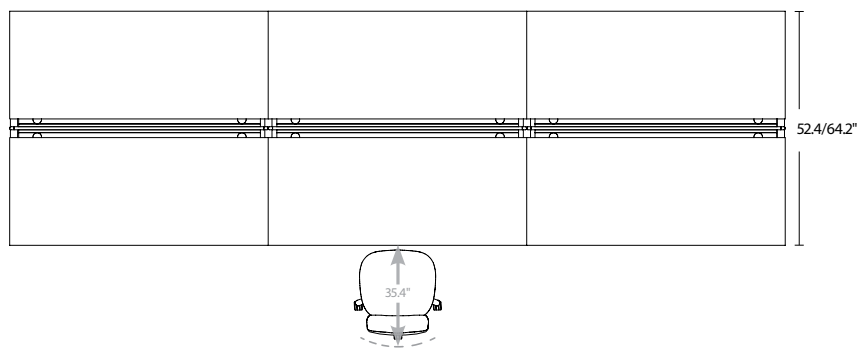

## Anvil Leg

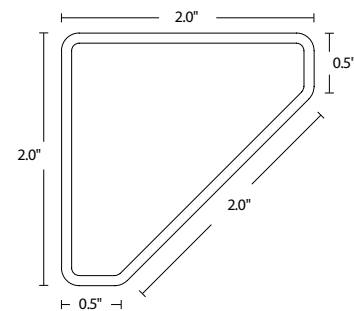

## Shared Desks

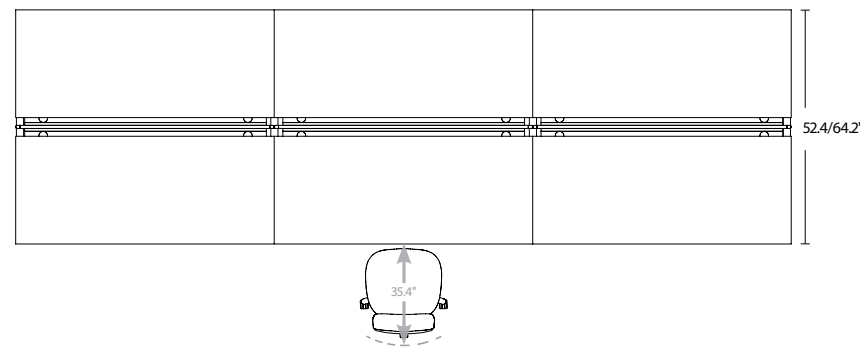

## Axis Leg

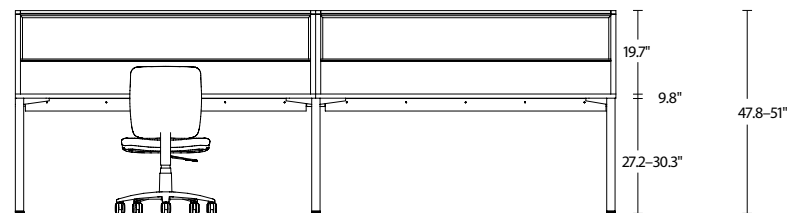
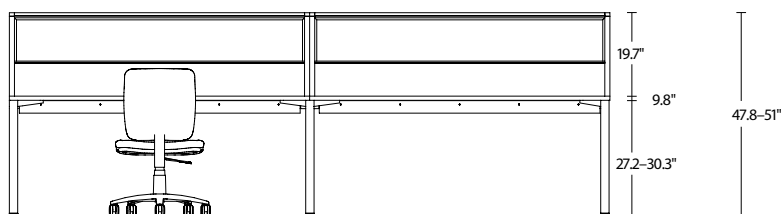
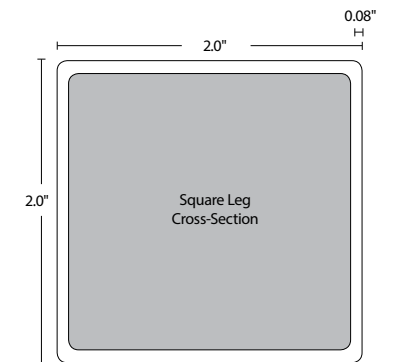



# AXIS/ANVIL SCREENS



Axis Desking with Black, Ignite and Translucent Screens, Axis Shelves and Storage

## STANDARD FINISH OPTIONS

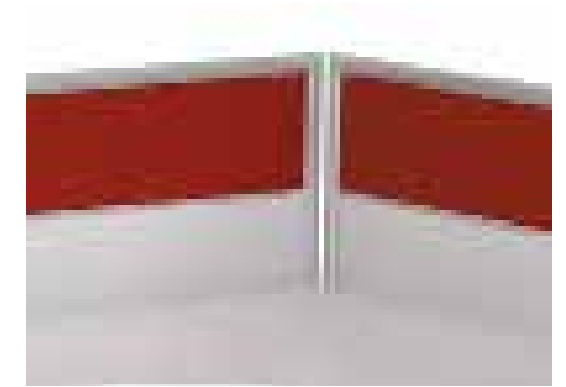

Ignite e-panel (Red)



Black e-panel



Translucent Twinwall PVC

## ALTERNATIVE E-PANEL COLOUR OPTIONS

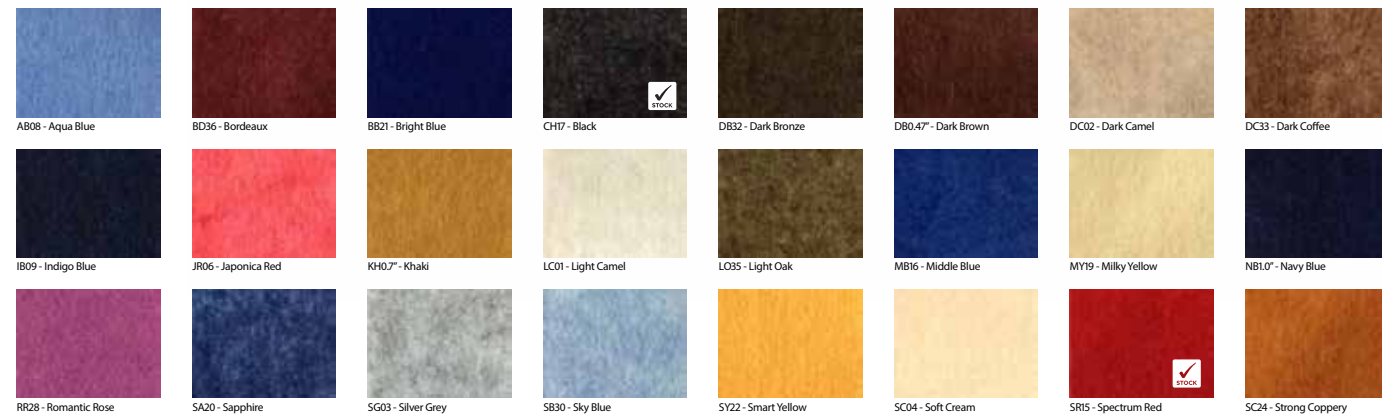

\* Additional costs and lead times apply to non-stock tech panel colour options.



## AXIS/ANVIL/AERO SCREEN SIZE GUIDE

### Standard Bracket

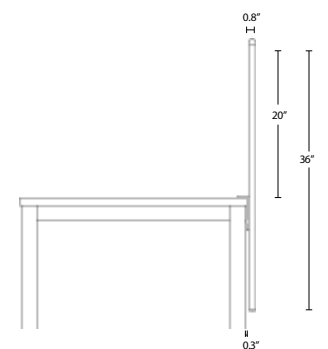

### Offset Bracket

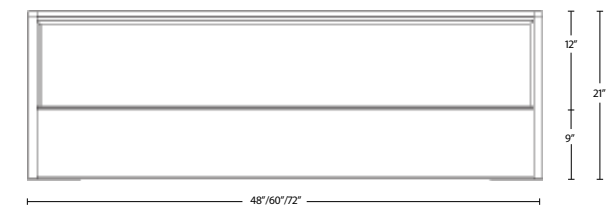
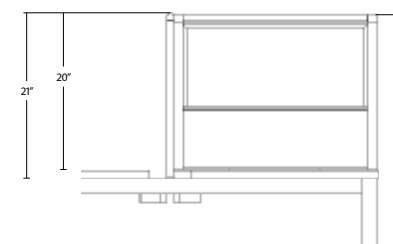
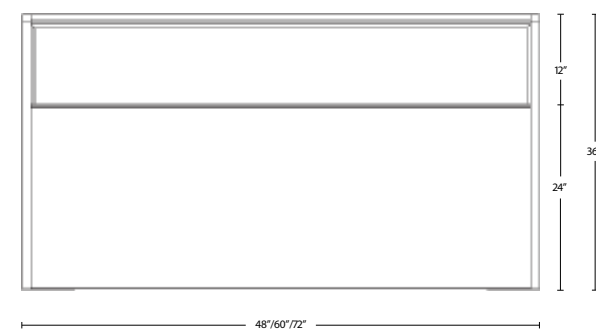
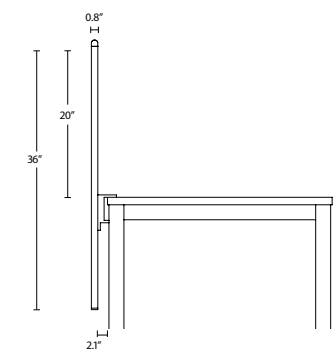

# SCREEN & SOFTWARE ACCESSORIES



## SCREENS, DESKSHELVES & ACCESSORIES

### DESKMOUNT SHELF

- Studio White melamine
- 4 x Chrome bookend hoops
- Arctic White powdercoat to brackets

### STANDARD SIZE

24" w x 12" d



### SCREEN MOUNTED SHELF

- Studio White melamine
- 4 x Chrome bookend hoops
- Hangs off transom rail on screen

### STANDARD SIZE

24" w x 12" d

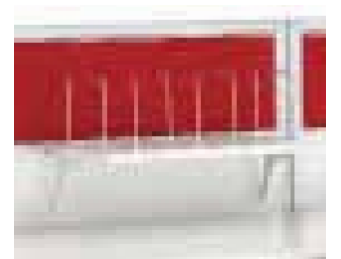

### A4 PAPER TRAY

- Arctic White powdercoat
- Hangs off transom rail on screen



### PEN HOLDER

- Arctic White powdercoat
- Hangs off transom rail on screen



Axis Straightline with Black Screens,  
Screen Hung Shelves and Monitor Arms



# AGILE HEIGHT ADJUST

Agile is a top electric height adjustable solution that is designed to work in the same places you do. Businesses are increasingly using sit-stand systems in collaborative offices, management spaces, in meeting areas or at home, and Agile's understated simplicity is ready to move right in.





# PRIVATE SPACES

Flexibility, collaboration, and a technology-based workflow require active, streamlined workspaces designed for the digital age. Agile fits the bill, perfect for both the CEO's office and for designated quiet zones inside a larger open office plan.





# LARGE OFFICE SPACES

Drab and isolated office cubicles are rapidly (and thankfully) becoming a relic of the past, making way for large, open office systems that foster collaboration, shared learning, and a strong social culture. Fixed height and height adjustable desks offers a contemporary, minimalist look whilst accommodating the need for flexibility and movement during the workday.

# AGILE SINGLE SIDED



## STANDARD FEATURES

- Overload operation protection
- Electronic screen displaying exact height with 4 preset height settings
- Double rail support for extra stability and strength
- Wide base foot and leveller for adjustment
- Height range: 23" - 48"
- Load capacity: 225 lbs.

- Gross weight: 80 lbs.
- Warranty: frame - 10 years; motor 5 years

## STANDARD FRAME SIZES ACCOMMODATE WORKSURFACE SIZES

48" w x 24" d	48" w x 30" d
60" w x 24" d	60" w x 30" d
72" w x 24" d	72" w x 30" d



**10 YEAR GUARANTEE\***  
\*5 Year Guarantee on electric motor

- Height adjustment speed: 1"/second

## SIZE GUIDE

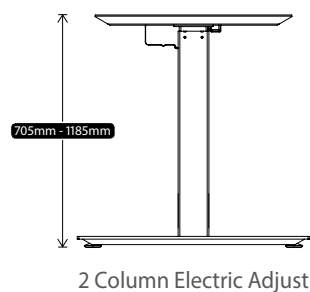
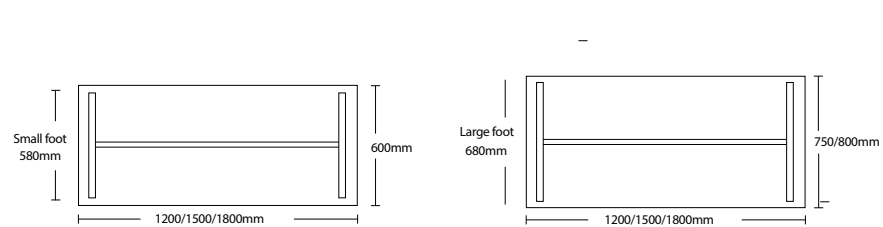

# AGILE BACK-TO-BACK



## STANDARD FEATURES

- Overload operation protection
- Electronic screen displaying exact height with 4 preset height settings
- Double rail support for extra stability and strength
- Wide base foot and leveller for adjustment
- Height range: 23" - 48"
- Load capacity: 225 lbs.

- Gross weight: 80 lbs.
- Warranty: frame - 10 years; motor 5 years

## STANDARD FRAME SIZES ACCOMMODATE WORKSURFACE SIZES

48" w x 24" d	48" w x 30" d
60" w x 24" d	60" w x 30" d
72" w x 24" d	72" w x 30" d



**10 YEAR GUARANTEE\***  
\*5 Year Guarantee on electric motor

- Height adjustment speed: 1"/second

## SIZE GUIDE

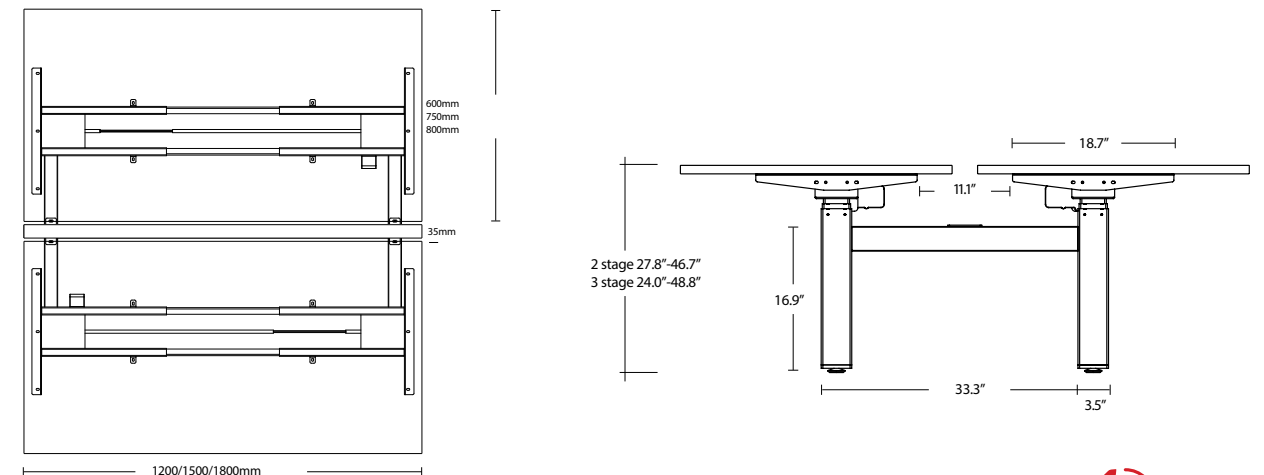





# STORAGE & RECEPTIONS

OLG modular Storage & Reception solutions are created with the flexibility of open plan workspaces in mind.

Axis 90 Degree Reception with Top, Politan Seating and Axis Storage



# PERSONAL STORAGE



Axis Desking with Black and Ignite Screens, Axis Shelves and Towers

- AXIS TOWER
- Studio White
  - 1.0" tops and base, 0.75" sides and shelves
  - Arctic White steel feet
  - 49"h x 20"w x 18"d
  - Drawer units
  - Height adjustable shelves
  - Flush joined construction



TOWER Bookcase

TOWER Bookcase + Drawers

TOWER Bookcase + Tambour

## AXIS CADDY STORAGE

- Studio White
- 0.75", flush-joined construction
- 5 heavy duty castors in white/ chrome finish
- 25"h x 35"w x 18"d
- Gang-lock to all drawers

- Height adjustable shelves
- Drawer units & tambours all interchangeable & lockable



Double Bookcase



One Drawer / Bookcase RH



Two Drawers



Tambour / Bookcase RH



One Drawer / Tambour LH



One Drawer / Tambour RH



One Drawer / Bookcase LH



Two Tambours



Tambour / Bookcase LH

## SEAT TOPPAS

### Standard features

- Fits on Caddy mobile or Melamine mobile
- 1.1"h x 18.0"w x 18.3"w
- Selected fabrics only





# SHARED STORAGE

## TAMBOURS

- Locking, space-saving roller doors
- Arctic White powdercoated feet
- 1.0" tops and base, 0.75" sides and shelves
- White doors
- Flush-joined construction
- Adjustable shelves
- Matching planter boxes



Showing AXIS Shared Desks and Tambour Storage



41" h x 36" w x 18" d



Overall: 49" h x 36" w x 18" d  
Planter: 8" h x 36" w x 18" d

## BOOKSHELVES

- Arctic White powdercoated feet
- 1.0" tops and base, 0.75" sides and shelves
- Flush-joined construction



49" HIGH - 3 LEVELS  
49" h x 36" w x 12" d

## CUPBOARDS

- Locking doors
- Arctic White powdercoated feet with leveling glides
- 1.0" tops and base, 0.75" sides and shelves
- Flush-joined construction



49" HIGH - 3 LEVELS  
49" h x 36" w x 16" d

## CRENZAS

- Locking doors
- Arctic White powdercoated feet with leveling glides
- 1.0" tops and base, 0.75" sides and shelves
- Flush-joined construction



72" LONG - 2 LEVELS  
36" h x 72" w x 16" d

## LATERAL FILE 2 DRAWER

- Locking drawers
- 1.0" tops and base, 0.75" sides and shelves
- Flush-joined construction
- Gang-locks all drawers



STANDARD FEATURES  
• 29" h x 36" w x 24" d

# AXIS RECEPTIONS

## STANDARD FEATURES

- Studio White melamine
- Chrome beading detail on front
- 0.75", flush-joined construction
- Straight or 90° options

## STANDARD SIZES

90° Corner:  
48"h x 72.5"w x 72.5"w x 12"d

Straight:  
48"h x 72.5"w x 12"d



Showing Axis 90 degree Reception and 49" high Tambour Storage



Straight Reception with Top



Straight Reception without Top



Corner Reception with Top



Corner Reception without Top

## RECEPTION SIZE GUIDE

Corner Reception with 90 Degree

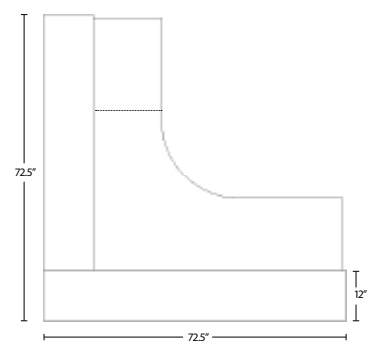

Corner Reception with Straight Desk

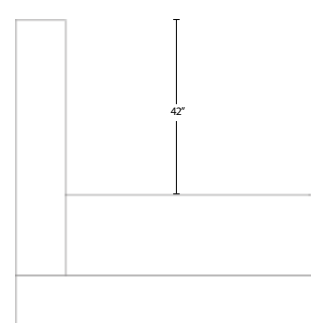

Straight Reception with 90 Degree

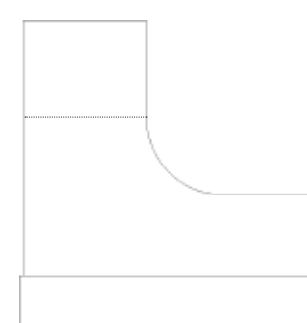

Reception Heights

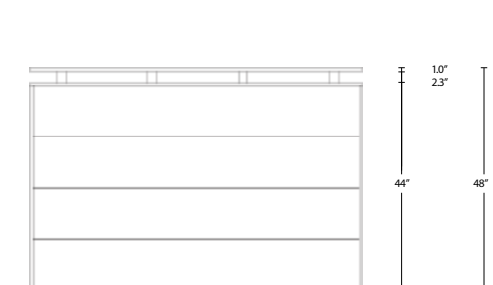



# ANVIL RECEPTIONS

## STANDARD FEATURES

- Studio White melamine.
- 3/4", flush-joined construction.
- White, centre feature panel.
- Concealed telescopic chassis adjusts to suit worktop size (adjustable in 2" increments) White worksurfaces are in stock. Other finish options are available.

## STANDARD SIZES

- MINIMUM CLOSED, INTERNAL: 71" X 34"
- MAXIMUM OPEN, INTERNAL: 95" X 34"
- MINIMUM CLOSED, EXTERNAL: 73" X 37"
- MAXIMUM OPEN, EXTERNAL: 96" X 37"
- HEIGHT 42"



Anvil Reception

## RECEPTION SIZE GUIDE

Straight Reception with Desk

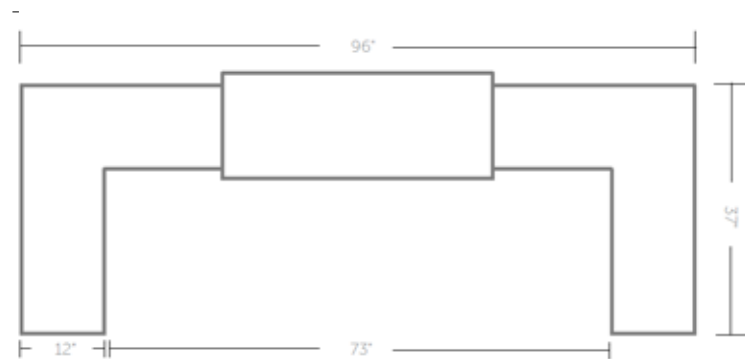

Reception Heights

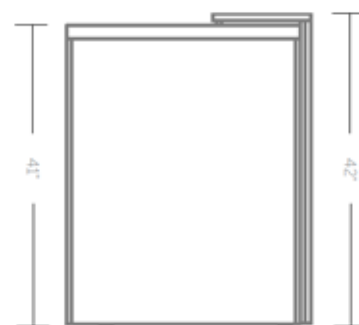



# MODULUS TABLES

The Modulus system has a timeless simplicity with one universal leg style that supports many table designs. The distinctive A-shaped rail and socket system securely locks the table together & gives immense strength.

---

Modulus Table shown with Custom Laminate Work Surface



# SIMPLE BEAUTY

The Modulus system has a timeless simplicity with one universal leg style that supports many table designs. The distinctive A-shaped rail and socket system securely locks the table together & gives immense strength.

# COLLABORATION

Modulus is a versatile table system that helps people collaborate, communicate and exchange ideas. They can be static tables of any size or they can be self-contained modules that move and adapt easily to fit the space or task at hand.





# SOPHISTICATION

Modulus tables work in all kinds of facilities. Highly finished, cast aluminum components and sophisticated, engineering grade mechanisms give an unparalleled aesthetic and functionality.

# WORKING TOGETHER

Tables are most powerful when used together. Modulus Flip tables can be used in any combination, which creates endless opportunities for constructive interaction in classrooms, training rooms & meeting rooms. All Flip tables come with durable locking castors to ensure they are easy to re-configure into new layouts.

WE ARE  
ALL A PART  
OF THE  
SAME THING



# CONFERENCE & TRAINING

Table tops flip up, chair seats flip up and both roll away on castors to nest together when no longer needed. This instantly transforms your training room into a highly flexible environment that is capable of a variety of teaching formats.

Shown with Adapta chairs, Link chairs & Link trolleys.



### Modulus Twin Pole Triple Span

Standard features

- Black powdercoated posts & rails, polished alloy feet, collars & connectors
- Leveling glides
- White worksurfaces are in stock. Other finish options are available.

Standard frame sizes fit worktops of  
156" - 312" length x  
48" - 78" width



### Modulus Single Pole Triple Span

Standard features

- Black powdercoated posts & rails, polished alloy feet, collars & connectors
- Leveling glides
- White worksurfaces are in stock. Other finish options are available.

Standard frame sizes fit worktops of  
144" - 288" length x  
32" - 48" width



### Modulus Twin Pole Double Span

Standard features

- Black powdercoated posts & rails, polished alloy feet, collars & connectors
- Leveling glides
- White worksurfaces are in stock. Other finish options are available.

Standard frame sizes fit worktops of  
120" - 204" length x  
48" - 78" width



### Modulus Single Pole Double Span

Standard features

- Black powdercoated posts & rails, polished alloy feet, collars & connectors
- Leveling glides
- White worksurfaces are in stock. Other finish options are available.

Standard frame sizes fit worktops of  
96" - 204" length x  
32" - 48" width



### Modulus Twin Pole Single Span

Standard features

- Black powdercoated posts & rails, polished alloy feet, collars & connectors
- Leveling glides
- White worksurfaces are in stock. Other finish options are available.

Standard frame sizes fit worktops of  
72" - 120" length x  
48" - 78" width



### Modulus Single Pole Single Span

Standard features

- Black powdercoated posts & rails, polished alloy feet, collars & connectors
- Leveling glides
- White worksurfaces are in stock. Other finish options are available.

Standard frame sizes fit worktops of  
54" - 120" length x  
32" - 48" width

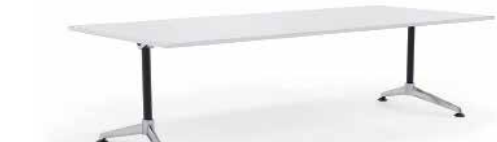

### Modulus Large Fixed Leg Single Span

Standard features

- Black powdercoated posts & rails, polished alloy feet & worktop supports
- Leveling glides
- White worksurfaces are in stock. Other finish options are available.

Standard frame sizes fit worktops of  
48" - 120" length x  
32" - 48" width



### Modulus Small Fixed Leg Single Span

Standard features

- Black powdercoated posts & rails, polished alloy feet & worktop supports
- Leveling glides
- White worksurfaces are in stock. Other finish options are available.

Standard frame sizes fit worktops of  
48" - 120" length x  
24" - 36" width



### Modulus Flip Tables

Standard features

- White or black powdercoat posts, rail & pullbars, polished cast alloy feet, silver castors
- ANSI-BIFMA approved for commercial use
- White worksurfaces are in stock. Other finish options are available.

Standard frame sizes accommodate worksurface of  
36" - 96" length x  
24" - 42" width



ANSI/  
BIFMA

#### Modulus Flip Table Modesty



PVC Modesty Panels come in white & silver, 53.2" wide and 65" wide.

#### Modulus Flipped with Modesty



#### Modulus Flip Table Nested



#### Modulus Flip Table Links



Connecting tables together is made easy with the very secure and simple-to-operate mechanism

### Modulus Standard Black Pole and Rails

Standard features

- 2x locking, 2x non locking castors
- Black posts, rails, pullbars, polished alloy feet
- One handed mechanism use
- Industrial grade nylon mechanism includes vertical locking mechanism.

Suits worksurface sizes of  
36" - 96" length x  
24" - 36" width



ANSI/  
BIFMA

### Modulus Standard White Pole and Rails

Standard features

- 2x locking, 2x non locking castors
- White posts, rails, pullbars, polished alloy feet
- One handed mechanism use
- Industrial grade nylon mechanism includes vertical locking mechanism.

Suits worksurface sizes of  
32" - 96" length x  
24" - 36" width



ANSI/  
BIFMA

### Modulus Large Black Pole and Rails

Standard features

- 2x locking, 2x non locking castors
- Black posts, rails, pullbars, polished alloy feet
- One handed mechanism use
- Industrial grade nylon mechanism includes vertical locking mechanism.

Suits worksurface sizes of  
36" - 96" length x  
36" - 42" width



ANSI/  
BIFMA

### Modulus Large White Pole and Rails

Standard features

- 2x locking, 2x non locking castors
- White posts, rails, pullbars, polished alloy feet
- One handed mechanism use
- Industrial grade nylon mechanism includes vertical locking mechanism.

Suits worksurface sizes of  
32" - 96" length x  
36" - 42" width



ANSI/  
BIFMA



## Modulus Straight Desks

### Standard features

- Black powdercoated posts & rails, polished alloy feet, collars & connectors
- Leveling glides
- White worksurfaces are in stock. Other finish options are available.

### Standard frame sizes fit worktops of

60" - 96" width x  
30" - 36" depth



## Modulus Corner Workstations

### Standard features

- Black powdercoated posts & rails, polished alloy feet, collars & connectors
- Leveling glides
- White worksurfaces are in stock. Other finish options are available.

### Standard frame sizes fit worktops of

Main worksurfaces  
60" - 96" width x  
30" - 36" depth

Return worksurfaces  
24" - 72" width x  
20" - 30" depth



## Modulus Shared Desks Single Sided

### Standard features

- Black powdercoated posts & rails, polished alloy feet, collars & connectors
- Leveling glides
- White worksurfaces are in stock. Other finish options are available.

### Standard frame sizes fit worktops of

60" - 96" width x  
30" - 36" depth



## Modulus Shared Desks Double Sided

### Standard features

- Black powdercoated posts & rails, polished alloy feet, collars & connectors
- Leveling glides
- White worksurfaces are in stock. Other finish options are available.

### Standard frame sizes fit worktops of

60" - 96" width x  
24" - 36" depth



## Modulus Shared Workstations

### Standard features

- Black powdercoated posts & rails, polished alloy feet, collars & connectors
- Leveling glides
- White worksurfaces are in stock. Other finish options are available.

### Standard frame sizes fit worktops of

Main worksurfaces  
60" - 96" width x  
48" - 96" depth

Return worksurfaces  
24" - 72" width x  
20" - 30" depth



### Modulus Shared Workstations Tee Layout



### Modulus Shared Workstations Plus Layout



### Modulus Shared Workstations H Layout



## Modulus Pedestal Tables

### Standard features

- Black powdercoated posts & rails, polished alloy feet, collars & connectors
- Leveling glides
- White worksurfaces are in stock. Other finish options are available.

### Standard frame fits worksurface size of

55" - 72" diameter or  
48" - 60" square



Modulus 4 Post Meeting Table

### Side Table

Frame height 16.7" high  
Standard frame fits worksurface size of  
16" - 28" diameter or  
16" - 24" square



### Small Single Post Meeting Table

Frame height 27.75" high  
Standard frame fits worksurface size of  
16" - 28" diameter or  
16" - 24" square



### Single Post Meeting Table

Frame height 27.75" high  
Standard frame fits worksurface size of  
32" - 48" diameter or  
30" - 42" square



## Modulus Pedestal Size Guide

### Round Single Post Pedestal:

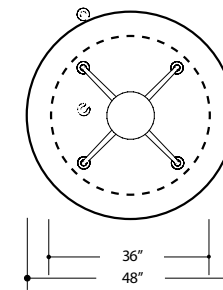

Table Top Options: 36" - 48" Diameter

### Square Single Post Pedestal:

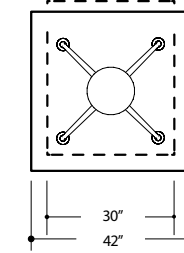

Table Top Options: 30" - 42" Square

### Round Four Post Pedestal

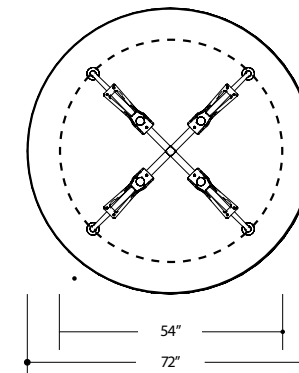

Table Top Options: 54" - 72" Diameter

### Square Four Post Pedestal

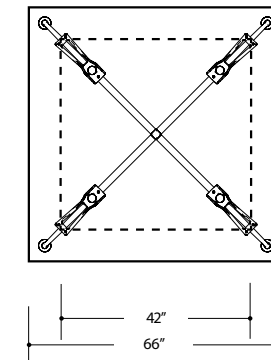
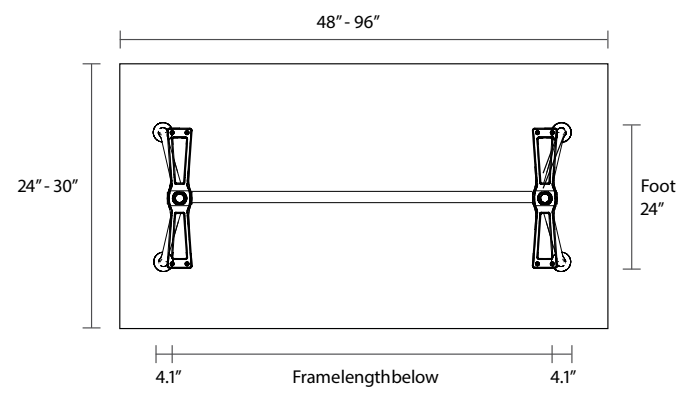

Table Top Options: 42" - 66" Square

# Modulus Size Guide

## 24" Wide Fixed Leg



## 32" Wide Fixed Leg

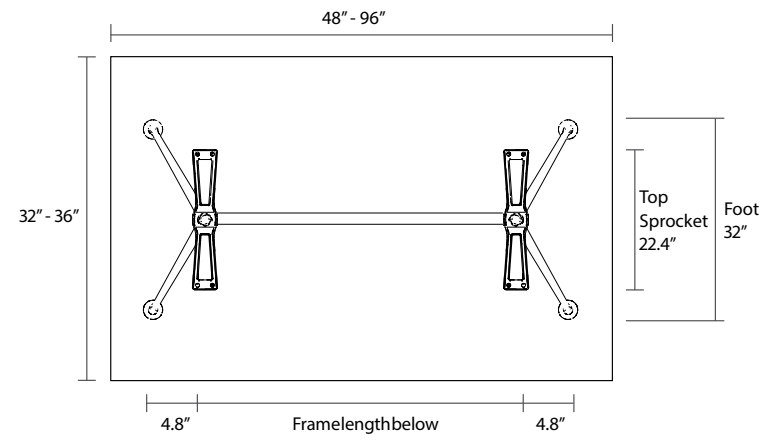

### Total Frame Length

- CA-FWTOPRAIL1100 = 41.3"
- CA-FWTOPRAIL1300 = 53.2"
- CA-FWTOPRAIL1600 = 65"
- CA-FWTOPRAIL2200 = 88.6"

## Single Post Legs with Collar

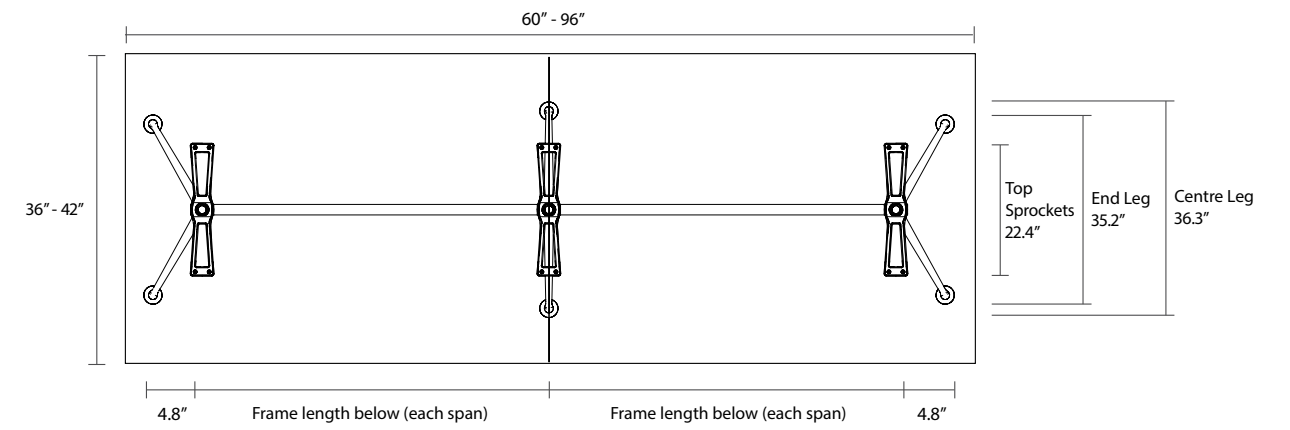

### Frame length (each span) ONE BEAM PER SPAN

- CA-FWTOPRAIL1100 = 45.3"
- CA-FWTOPRAIL1300 = 53.2"
- CA-FWTOPRAIL1600 = 65"
- CA-FWTOPRAIL2200 = 88.6"

## Standard Foot Flip Tables

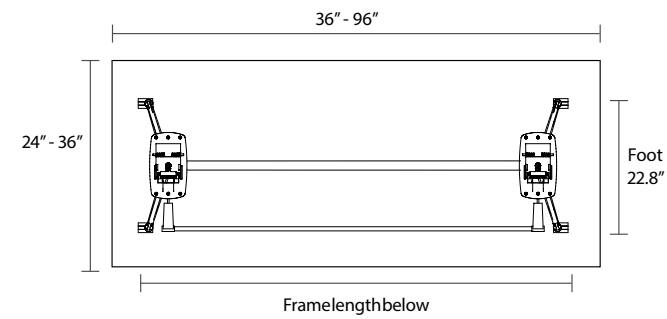

## Large Foot Flip Tables

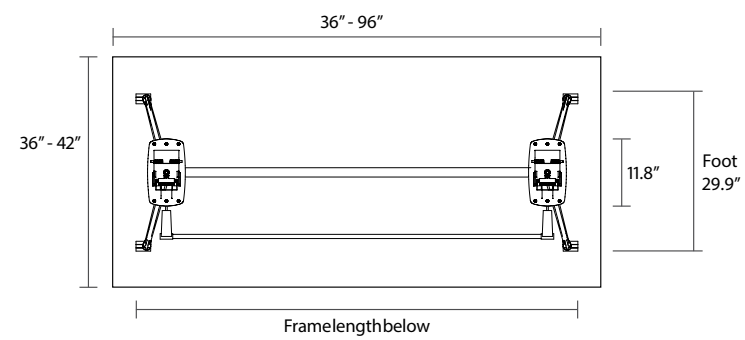

### Total Frame Length

- CA-FWFLRAIL50 = 31.5"
- CA-FWFLRAIL80 = 43.3"
- CA-FWFLRAIL110 = 55.1"
- CA-FWFLRAIL140 = 66.9"

## Twin Post Legs with Collar

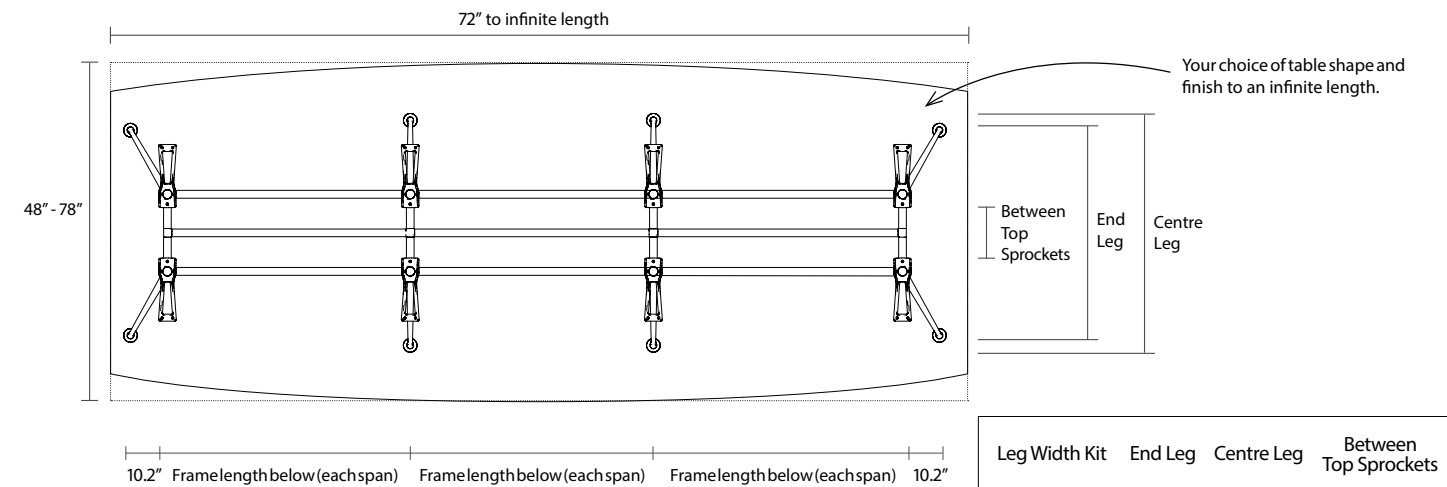

### Upper frame length (each span) TWO BEAMS PER SPAN

- CA-FWTOPRAIL1100 = 45.3"
- CA-FWTOPRAIL1300 = 53.2"
- CA-FWTOPRAIL1600 = 65"
- CA-FWTOPRAIL2200 = 88.6"

### Lower frame length (each span) ONE BEAM PER SPAN

- CA-FWBOTRAIL1100
- CA-FWBOTRAIL1300
- CA-FWBOTRAIL1600
- CA-FWBOTRAIL2200

Leg Width Kit	End Leg	Centre Leg	Between Top Sprockets
CA-FW1200	44.9"	49.6"	7.1"
CA-FW1400	49.4"	54.1"	11.6"
CA-FW1600	57.3"	62"	19.5"
CA-FW1800	65.9"	69.9"	27.4"

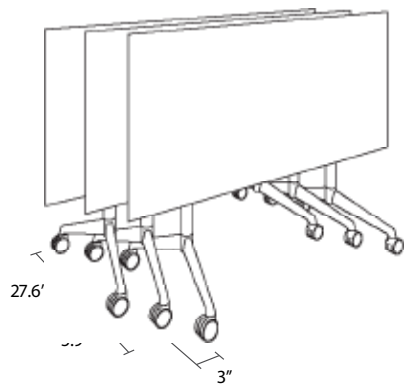
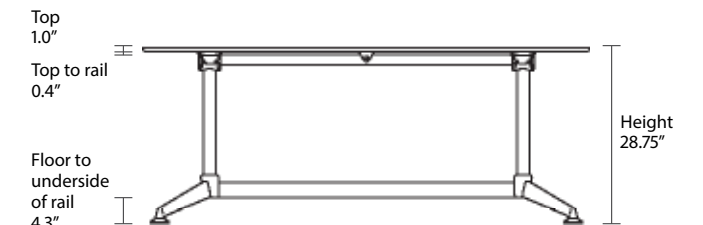





# UNI FLIP TABLES

The innovative Uni Flip table supports modern work dynamics as a superb choice for conference, training, meeting and catering facilities as well as quickly meeting the demand for extra working space for projects.

- Conference
  - Training
  - Meeting
  - Catering
-

# UNI FLIP TABLES

## STANDARD FEATURES

- Silver powdercoat or Chrome posts, frames, rail & pullbars, black castors
- White worksurfaces are in stock. Other finish options are available.
- Locking Castors

## STANDARD FRAME SIZES ACCOMMODATE WORKSURFACE SIZES

- 48" w x 24" d x 28.75" h
- 48" w x 30" d x 28.75" h
- 60" w x 24" d x 28.75" h
- 60" w x 30" d x 28.75" h
- 72" w x 24" d x 28.75" h
- 72" w x 30" d x 28.75" h
- 72" w x 36" d x 28.75" h



Showing Uni Flip Silver 72"x30" with mixed colour Adapta Seating.



Uni Flip Chrome



Uni Flip Silver Powdercoat

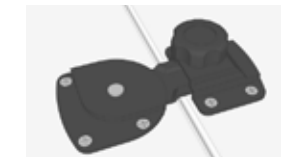

Steel Table Link Locked

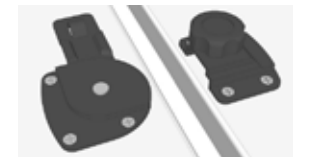

Steel Table Link Unlocked

## FRAME SIZE

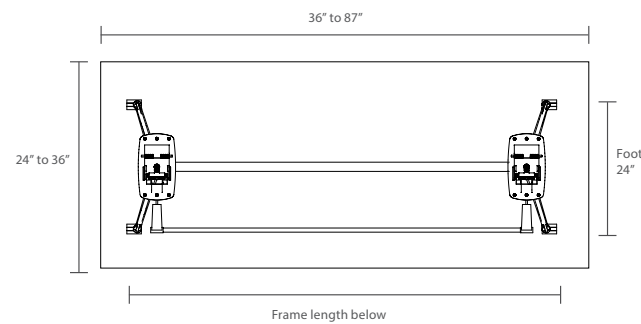

### Total Frame Length

- CA-FWFLRAIL50 = 32"
- CA-FWFLRAIL80 = 43"
- CA-FWFLRAIL110 = 55"
- CA-FWFLRAIL140 = 67"

## NESTING DIMENSIONS

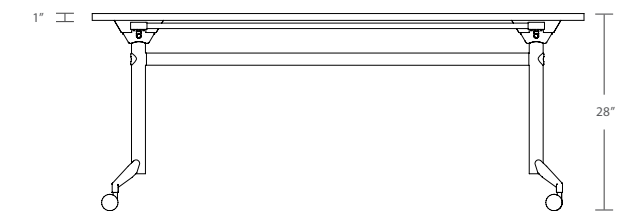
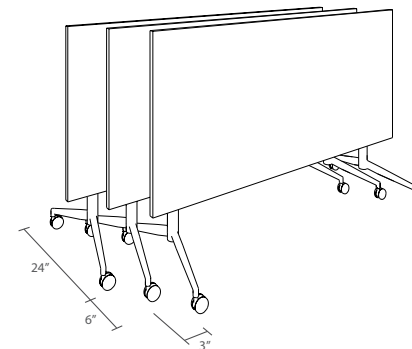





# FREEWAY SEATING



balance



## the best in mesh

The Balance Chair is the perfect balance of design and engineering. High quality materials, interactive functionality and pared down styling create a fluid aesthetic that projects perfect equilibrium.

**Recommended use:**

Task, Executive, Conference & Boardroom Seating

**Features:**

- Tilt Memory
- Sliding Seat
- Pneumatic Height Adjustment
- Adjustable Arms
- Solid Cast Aluminium Mechanism
- Mesh Back

10 YEAR GUARANTEE

300 lb RATING

ISO14001 EMS

ANSI/BIFMA



# balance features

Your chair is in constant contact with your body, and by meticulous design the Balance Chair creates a state of steadiness and proper orientation of the body. Cradling your body with form fitting, suspended mesh, the Balance Chair helps you maintain a healthy ergonomic posture and keeps you comfortable all day.

And the technology is backed up by hard facts. The Balance Chair is certified as complying with testing to the American National Standard for Office Chairs: ANSI/BIFMA X5.1-2002.



## Seat covers

Removable seat covers - easy to refurbish, upgrade & clean!



## Sliding arms

Multi adjustable arms for customized support: up/down, fore/aft, & side/side



## Lumbar support

Supportive adjustable lumbar can also be removed



## Removable armrests

Multi adjustable arms can also be removed

## Custom tilt

Simple, precise weight specific tilt action

## Tilt memory

Advanced tilting limiter with two step memory

## Mechanism

Solid, cast aluminium synchro mechanism with multi-fulcrum support

## Sliding seat

Simple, push/pull sliding seat depth adjustment with 5 positions

### Dimensions:

Weight	48.5 lb
With Headrest	50.7 lb
Volume	7.1 ft
With Headrest	9.2 ft
Seat Height	17.5 - 21.5"
Seat W/D	18.9/18.9"
Overall Height	39 - 42.9"

### Finishes as shown:

- Black Mesh Back
- Black Faux Leather Seat
- White Mesh Back
- White Faux Leather Seat
- Polished Alloy Mechanism

# balance finishing options



Alloy base



Black Mesh

White Mesh

Adjustable Arms



Black Mesh

White Mesh

Adjustable Lumbar



Black Mesh



# balance series



Left - Right: Balance Guest, Balance Task, Balance Black, Balance White, Balance Training

\* Not all finishes shown are available on the OLG stock programme.

# balance training



Shown with Tablet Arm



## just visiting

**Seat** High resistance moulded foam and hard wearing fabric for high use areas

**Back** High quality, supportive mesh keeps you comfortable all day

**Mechanism** Strong cast aluminium reclining mechanism to give relaxation when you want

**Folding** Seat allows for nesting to save space

**Recommended use:**  
Executive Side Chair,  
Conference, Training &  
Boardroom Seating

**Features:**  
Comfortable Mesh  
Backrest  
Removable Armrests  
Fold-up Seat  
Moulded Foam Seat  
Cushion  
Heavy Duty Castors  
Optional Tablet Arm

**Dimensions:**

Weight 22 lb  
Volume 3.2 ft  
Seat Height 17.7"  
Seat W/D 18"/17.7"  
Overall Height 32"

**Finishes as shown:**

Black Mesh Back  
Black Breathe Fabric  
Black Frame

10 YEAR GUARANTEE

300 lb RATING

ISO14001 EMS



# balance guest



## style meets classic

**Seat** Moulded, high resistance foam, upholstered in hard wearing fabric

**Back** Ergonomically contoured, high quality mesh

**Frame** Black powdercoated steel in a cantilever or 4-point frame

**Recommended use:**  
Executive Side  
Chair, Conference &  
Boardroom Seating

**Features:**  
Comfortable Mesh  
Backrest  
Moulded Foam Seat  
Cushion  
Powdercoated Steel  
Frame

**Dimensions:**

Weight 24 lb  
Volume 6.4 ft  
Seat Height 17"  
Seat W/D 24/22"  
Overall Height 34"

**Finishes as shown:**

Black Mesh Back  
Black Breathe Fabric  
Black Cantilever Frame

10 YEAR  
GUARANTEE

300 lb  
RATING

ISO14001 EMS

# balance task



## multi-tasking

**Seat** High resistance, moulded foam with tidy underseat finish

**Back** High quality mesh, ergonomically supports your back

**Mechanism** Simple levers for height, tension and tilt control to personalise your comfort

**Base** Stylish black polypropylene 5 star base with large 2.3" castors

### Dimensions:

Weight 31.9 lb  
Volume 3.5 ft  
Seat Height 17 - 20"  
Seat W/D 20.3 - 20.3"  
Overall Height 32.7 - 35.2"

### Finishes as shown:

Black Mesh Back  
Black Breathe Fabric  
Black 5 Star Base

### Recommended use:

Task, Executive, Conference & Boardroom Seating

### Features:

- Comfortable Mesh Backrest
- Removable Armrests
- Moulded Foam Seat Cushion
- Heavy Duty Castors
- Pneumatic Height Adjustment
- Sliding Seat

10 YEAR GUARANTEE

300 lb RATING

ISO14001 EMS



**Recommended use:**  
Executive, Conference  
& Boardroom Seating

**Features:**  
Tilt Memory  
Weight Specific  
Tension Control  
Optional Height  
Adjustment  
Stainless Steel Arms  
Solid Aluminium  
Mechanism  
Complete Family,  
Highback, Midback  
and Guest

10 YEAR  
GUARANTEE  
300 lb  
RATING  
ISO14001 EMS

## sophisticated & refined

The Mode Chair looks both classic and contemporary in 21st century interiors. Their clean lines make them appropriate for all kinds of places.

Executive models feature individually upholstered cushions and all models feature stainless steel tubular frames - truly timeless.



# mode features

Its aesthetic form is not coincidental: your body was the template for the Mode Chair's lithe silhouette. Its luxuriously padded seat and back, closely parallels that of the human body.

## Mirror finish

Stainless steel frame and armrests with hidden fixings

## Fully sprung seat

Provides outstanding comfort & support

## Synchronised

Tilting mechanism with weight specific tension control

Shown: Mode Highback



## Luxurious

Soft upholstered cushions and removable leather arm covers makes sitting in the Mode a blissful experience



## Guest

Add extra class to your executive office with a plush Mode Guest chair



## Perfect for the boardroom

The combination of comfort, elegance and style makes the Mode midback a fantastic choice for boardroom seating

### Dimensions:

Weight	35 - 46 lb
Volume	6.7 - 10.2 ft
Seat Height	16.9 - 20.1"
Seat W/D	18.9/18.1"
Overall Height	
HB	42.1 - 44.9"
MB	33.9 - 38"
Guest	33.9"

### Finishes as shown:

Black Faux Leather
White Faux Leather
Stainless Steel Frame & Base



metro



## the best in black

Need an executive chair that works as hard as you do? The Metro features a modern design with its breathable upholstery, synchronized tilting mechanism, and thin profile.

This chair is designed with you in mind. In addition to the executive Metro Chair, this sleek look has been incorporated into a guest chair that once again offers comfort and function.

**Recommended use:**  
Executive, Conference & Boardroom Seating

**Features:**  
Tilt Memory  
Weight Specific Tension Control  
Optional Height Adjustment  
Stainless Steel Arms  
Solid Aluminium Mechanism  
Complete Family, Highback, Midback and Guest

10 YEAR GUARANTEE

300 lb RATING

ISO14001 EMS

# metro features

The Metro Chair's seat and back form closely parallels that of the human body and comfort is created naturally by suspending a continuous piece of breathable upholstery tautly between the lightweight aluminum side ribs.

Executive and management models come with seat-height and tilt-swivel adjustments and guest models feature stainless steel tubular frames - truly timeless.

## Mirror finish

Stainless steel frame and armrests with hidden fixings



## Perfect for the boardroom

The combination of comfort, elegance and style makes the Metro midback a fantastic choice for boardroom seating



Shown: Metro Midback

## Fully sprung seat

Provides outstanding comfort & support

## Synchronised

Tilting mechanism with weight specific tension control



## Comfort

Refined upholstery with detailed stitching gives the Metro a sophisticated style



## Guest

Add extra class to your executive office with an elegant Metro Guest chair

### Dimensions:

Weight	37 - 44 lb
Volume	6.4 - 9.5 ft
Seat Height	18.9 - 22"
Seat W/D	19.9/20.1"
Overall Height	
HB	42.9 - 46.5"
MB	35 - 38.6"
Guest	33.9"

### Finishes as shown:

Black Faux Leather
White Faux Leather
Stainless Steel Frame & Base





## versatility & style

Adaptable is the ability to adjust to different conditions, an essential characteristic in the corporate world. Hence the Adapta Chair; a versatile chair that works for you. Pull up a couple of Adapta Chairs for collaborative work. Pull one up as a side chair. Pull a whole stack of Adapta Chairs from the conference room to the cafeteria.

Adapta Chairs also adapt to your mood and posture - lean back and you'll find the perforated backrest and unique cast aluminum chassis pivots and supports you all the way. Lightweight and easy to move with or without castors, Adapta Chairs can be stacked infinitely back to back - just flip-up the seat and stack (without any strain!).

**Recommended use:**  
Training, Conference, Classroom, Healthcare, Retail & Cafeteria Seating

**Features:**  
Optional Armrests  
Optional Tablet Arm  
Casters  
Fold-Up Seat  
Cast Aluminium, Reclining Chassis

10 YEAR GUARANTEE

300 lb RATING

ISO14001 EMS

ANSI/BIFMA

# adapta features

These days, people are doing more work outside their individual offices or workstations. Adapta Chairs give you the kind of flexibility business, conference or education workspaces demand. Lightweight, portable, nesting, movable, they help people come together, move around - whatever the work demands.

## Comfort

Integral arms and perforated back combine to give flexible supportive and "no-sweat" comfort

## Recline

Superstrong reclining mechanism to give relaxation when you want

## Seat

High resilience molded seat cushion and hard wearing fabric for high use areas



## Make training a breeze

The combination of comfort, style & quality makes the Adapta a functional choice for training facility seating



## Space saving

Adapta's folding seat allows for nesting to save space when not in use



## Tablet arm

Add extra adaptability to your training room with the optional adapta tablet

### Dimensions:

Weight 28.7 lb  
Volume 3.5 ft  
Seat Height 17.7"  
Seat W/D 18.1/17.7"  
Overall Height 32.3"

### \*Finishes as shown:

White/Black Backrest  
Black Upholstered Seat  
Silver Powdercoated Frame



link



## stack it up

Go higher and make connections with the Link Chair! Thoughtfully designed with low profile frame and ergonomically contoured seat & back, the Link chair nests well to save space and is very portable.

Feet that double as connectors and a modern colour selection make the Link a stand out choice for any place large numbers of people need to be seated.

**Recommended use:**  
Training, Conference, Classroom, Healthcare, Retail & Cafeteria Seating

**Features:**  
Polypropylene Seat & Back  
Silver Powdercoated Frame  
Dual Purpose Feet/ Connector  
Heavy-Walled Tubular Steel Frame

10 YEAR GUARANTEE

300 lb RATING

ISO14001 EMS





politan



## set the tone

First impressions really do count - studies show that it is very hard to break a negative one! The Politan range offers European styled, sumptuous soft seats for your reception area or waiting room.

**Recommended use:**

Reception Areas,  
Waiting Rooms,  
Auditoriums &  
Cafeteria Seating

**Features:**

Chrome Steel Legs  
& Arms

Available in 1 & 2  
Seater Options

Upholstered in Black  
Faux Leather

10 YEAR  
GUARANTEE

300 lb  
RATING

ISO14001 EMS

# politán features

Whether you need elegant soft seats for your corporate reception area or your innovative new venture; Freeway will help you form a positive impression every time.

## Comfort

Generous seat size and slim arms make Politán ideal for welcoming area



## Impressive welcome

Bring a fresh new look to your waiting room or reception area and create a positive impression with clients



## Refined

Chrome leg detail with adjustable feet

## Contemporary

Slab style back and armrests



## 1 or 2 seater

Give your reception the complete look with Politán 1 or 2 seater options

### Dimensions:

Weight	50.7 - 66 lb
Volume	14.1 - 28.3 ft
Seat Height	17.5"
Seat W/D	
1 Seater	22/20.5"
2 Seater	44/20.5"
Overall Height	33.1"

### Finishes as shown:

Black Faux Leather

# 3D SHOWCASE

Simply send your account manager an outline of the job your are pitching for detailing the floor plan with dimensions, the budget and a spreadsheet of the furniture you have specified for each room.

As always, your account manager will be available to assist you in making recommendations on the best furniture for your client's budget and requirements.

Depending on your client, you may want to specify carpet colour, indoor plants, and other job-specific features. Be sure to mention these details in your floor plan instructions - we want to do all we can to help you clinch the deal!



We've already put in the long hours drawing 3D models of the OLG desking and seating ranges. We use these 3D models like jigsaw pieces on your floorplan so in no time at all you can see your tender come to life.

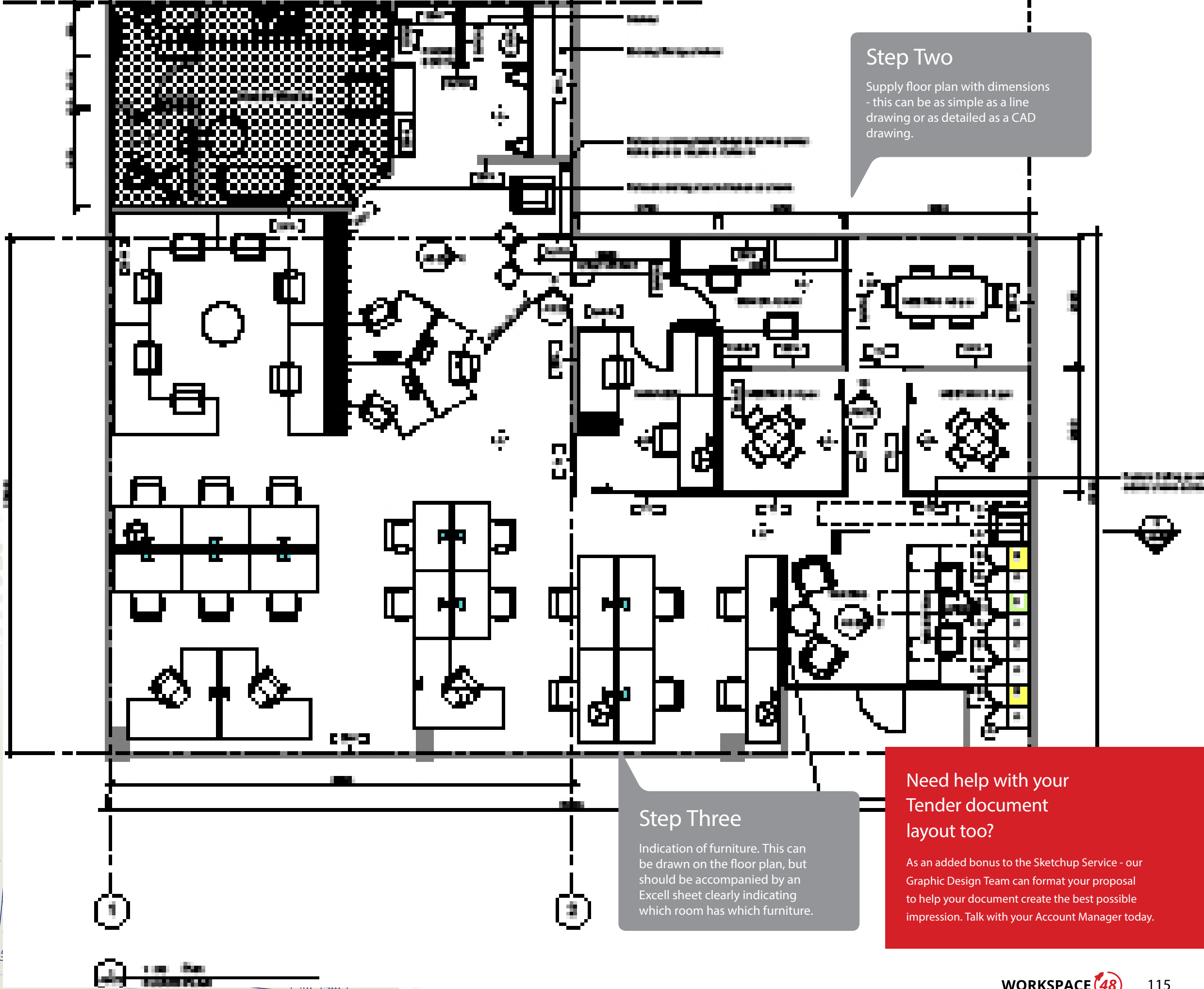

**Step Two**  
Supply floor plan with dimensions - this can be as simple as a line drawing or as detailed as a CAD drawing.

**Step Three**  
Indication of furniture. This can be drawn on the floor plan, but should be accompanied by an Excell sheet clearly indicating which room has which furniture.

**Need help with your Tender document layout too?**  
As an added bonus to the Sketchup Service - our Graphic Design Team can format your proposal to help your document create the best possible impression. Talk with your Account Manager today.



# CASE STUDY

## 91 Staff Fitout

- Anvil Desking with e-panel
- Melamine Storage
- Freeway Seating
- Modulus Tables



# CASE STUDY

## 100 Staff Fitout

- 100 Staff
- Anvil System
- Comseal
- Modulus Tables
- Custom Fabric



Artist Impression



3D Layout Image



# CASE STUDY

## 300 Staff Fitout

- 300 Staff
- Anvil with Custom Screens & Shared Storage
- Custom Pigeon Hole and Waste Bin Cabinets
- Modulus Tables



Level One



# CASE STUDY

## 100 Staff Fitout

- 100 Staff
- Axis Desking with Screen
- Balance Seatings
- Axis Tambour Cabinets & Axis Mobile Drawers
- Modulus Tables





E [info@workspace48.com](mailto:info@workspace48.com)

P 416 441 9898

